



**DENOTES SYSTEM ACCESS POINT**

**PREFERRED METHOD:**

THE PREFERRED METHOD TO ACCESS A SAFETY SYSTEM IS VIA A ROOF HATCH, SET INTERNALLY AWAY FROM IDENTIFIED FALL HAZARDS / ADJACENT TO THE START OF THE CABLE SYSTEM.

**ALTERNATIVE METHOD:**

THE ALTERNATIVE METHOD OF ACCESS CAN BE BY MEANS OF POWERED ACCESS (E.G. CHERRY PICKER), WHERE THE ACCESS PLATFORM CAN BE SET DOWN ADJACENT TO THE SYSTEM, ALLOWING THE USER DIRECT ATTACHMENT PRIOR TO EXITING THE PLATFORM.

**OPTION:**

WHERE NO OTHER METHOD IS AVAILABLE, THE USE OF WIRE ROPE STROP ALLOWS THE USER TO CONNECT DIRECTLY TO THE SYSTEM BEFORE ENTERING THE ROOF LEVEL. FOR SINGLE STOREY BUILDINGS, WHERE GROUND CLEARANCE IS LIMITED, THE USE OF A WIRE STROP REDUCES THE RISK OF INJURY IN AN EVENT OF A FALL. HOWEVER, DUE TO LIMITED GROUND CLEARANCE, IT IS RECOMMENDED THAT ACCESS IS ACHIEVED USING THE PREFERRED OR ALTERNATIVE METHOD AS THE WIRE STROP EXTERNAL METHOD DOES NOT ELIMINATE THE RISK OF A FALL.

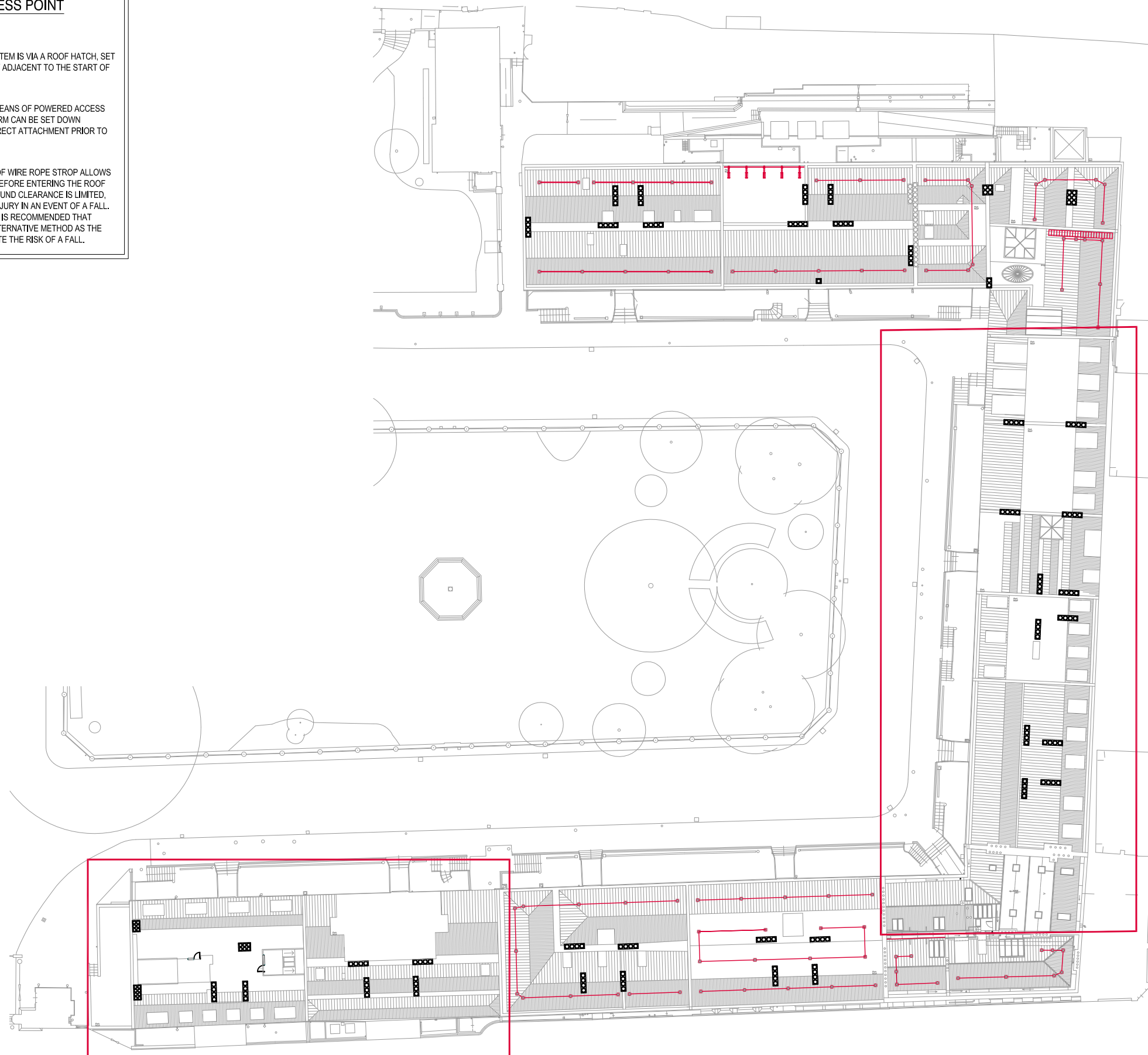

**COMPONENT DATA:**

VERSIRAIL - FREESTANDING FOLDING UPRIGHT  
(FINISH - TBC)

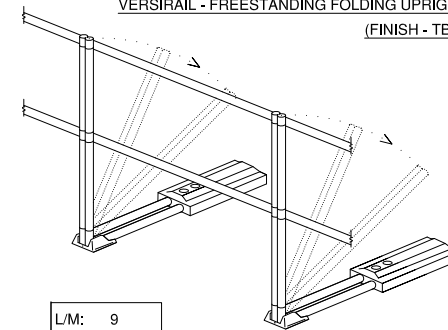

L/M: 9

VERSIRAIL - END TERMINISATIONS

D-RETURN

WALL FIX

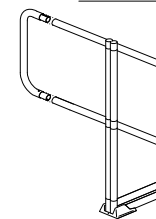

22064-00

NO. 2

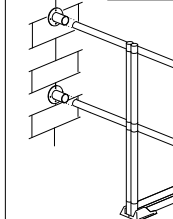

22063-00

NO. 0

VERSIRAIL - OTHER COMPONENTS

90 DEGREE

45/45 DEGREE

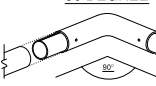

22061-00

NO. 0

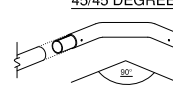

22062-00

NO. 0

ACCESS GATE

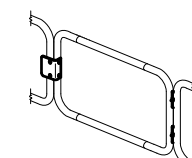

22010-00

NO. 0

22065-00

NO. 0

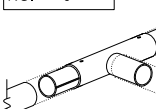

T-PIECE

22067-00

NO. 0

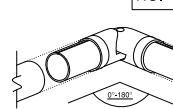

VARIABLE

**SPECIFICATION DATA:**

NOTE: THIS DRAWING WAS CREATED IN CONJUNCTION WITH BAILEY GARNER, DWG NO. all roofs

**SYSTEM INFORMATION:**

LATCHWAYS VERSIRAIL CLASS A1 COLLECTIVE PROTECTION SYSTEM. SYSTEM DESIGNED FOR EDGE PROTECTION FOR OPERATIVES ACCESSING THE ROOF FOR MAINTENANCE AND INSPECTION PURPOSES ONLY.



PROJECT NAME: LINCOLNS INN - NEW SQUARE 2 OF 2	
DATE: 20TH NOVEMBER 2014	SCALE: 1:500 @ A3
DRAWN BY: SWH	CHECKED BY: CA
PROJECT REFERENCE NO. 5382-02	REVISION:

THIS DRAWING IS PROTECTED BY COPYRIGHT AND THE INFORMATION HEREIN IS CONFIDENTIAL. THE DRAWING MAY NOT BE COPIED AND THE INFORMATION CONTAINED HEREIN MAY NOT BE USED OR DISCLOSED EXCEPT WITH THE WRITTEN PERMISSION OF LATCHWAYS PLC.

IMPORTANT NOTICE: UNDER THE CDM REGULATIONS 2007, IF ANY ALTERATIONS ARE MADE TO THIS DRAWING THEN THE PERSON UNDERTAKING THESE CHANGES ASSUME THE ROLE OF THE DESIGNER, THEREFORE TAKING FULL CDM RESPONSIBILITY. PLEASE SEE H.S.C. CDM APPROVED CODE OF PRACTICE REGULATION 2, SECTION 110.

SNOW GUARDS: IT IS THE RESPONSIBILITY OF OTHERS TO DETERMINE THE REQUIREMENTS FOR SNOW GUARDS ON THE ABOVE ROOFS

INSTALLER NOTICE: IT IS THE INSTALLERS RESPONSIBILITY TO ENSURE ALL DETAILS/ROOF TYPE/STRUCTURE ETC. ARE CORRECT AND COMPLY WITH ANY FIT FOR PURPOSE REQUIREMENTS OF THEIR CUSTOMERS PRIOR TO ORDERING COMPONENTS.

Latchways plc, Hopton Park, Devizes, Wiltshire, SN10 2JP. Tel: +44 (0)1380 732700, Fax: +44 (0)1380 732701

