

**Materials Key:**

- 1 Red-Multi Facing Brickwork.  
NBS Ref: External multiple leaf wall above dpc masonry system. 25-10-55/123 Type A (Red Bricks)
- 2 White Facing Brickwork.  
NBS Ref: External multiple leaf wall above dpc masonry system. 25-10-55/123 Type B (White Bricks)
- 3 High Pressure Laminate Rainscreen Cladding.  
NBS Ref: Drained and back-ventilated rainscreen cladding. 25-80-70/120 Type A (Trespa)
- 4 Porcelain Rainscreen Cladding.  
NBS Ref: Drained and back-ventilated rainscreen cladding. 25-80-70/120 Type B (Stone to Entrances)
- 5 Aluminium Window System.  
NBS Ref: Aluminium framed windows. 25-50-95/125 Types A-G
- 6 Aluminium Curtain Walling System.  
NBS Ref: Stick curtain walling system. 25-25-15/175 Type A (Curtain Walling to non residential areas)
- 7 Aluminium Curtain Walling System.  
NBS Ref: Stick curtain walling system. 25-25-15/175 Type B (Curtain Walling to penthouse level)
- 8 Balconies.  
NBS Ref: Pre-fabricated balcony structure. 20-05-80/140.
- 9 Laminated Glazed Balustrading.  
NBS Ref: Balustrade and guarding system. 25-25-10/110 Type A
- 10 Powder Coated Steel Balustrading.  
NBS Ref: Balustrade and guarding system. 25-25-10/110 Type B
- 11 Timber Cladding.  
NBS Ref: Timber weatherboarding system. 25-80-95/195
- 12 Timber Screening  
NBS Ref: TBC
- 13 Metallic Bronze Alucobond Cladding.  
NBS Ref: Rigid sheet cladding system. 25-80-76/170
- 14 Glazed Facing Brickwork  
NBS Ref: External multiple leaf wall above dpc masonry system. 25-10-55/TBC
- 15 Penthouse Solid Privacy Screen  
NBS Ref: TBC



**2 Block B South**  
1 : 100

Suspended green wall training system to Spacehub specification.



**1 Block B North**  
1 : 100

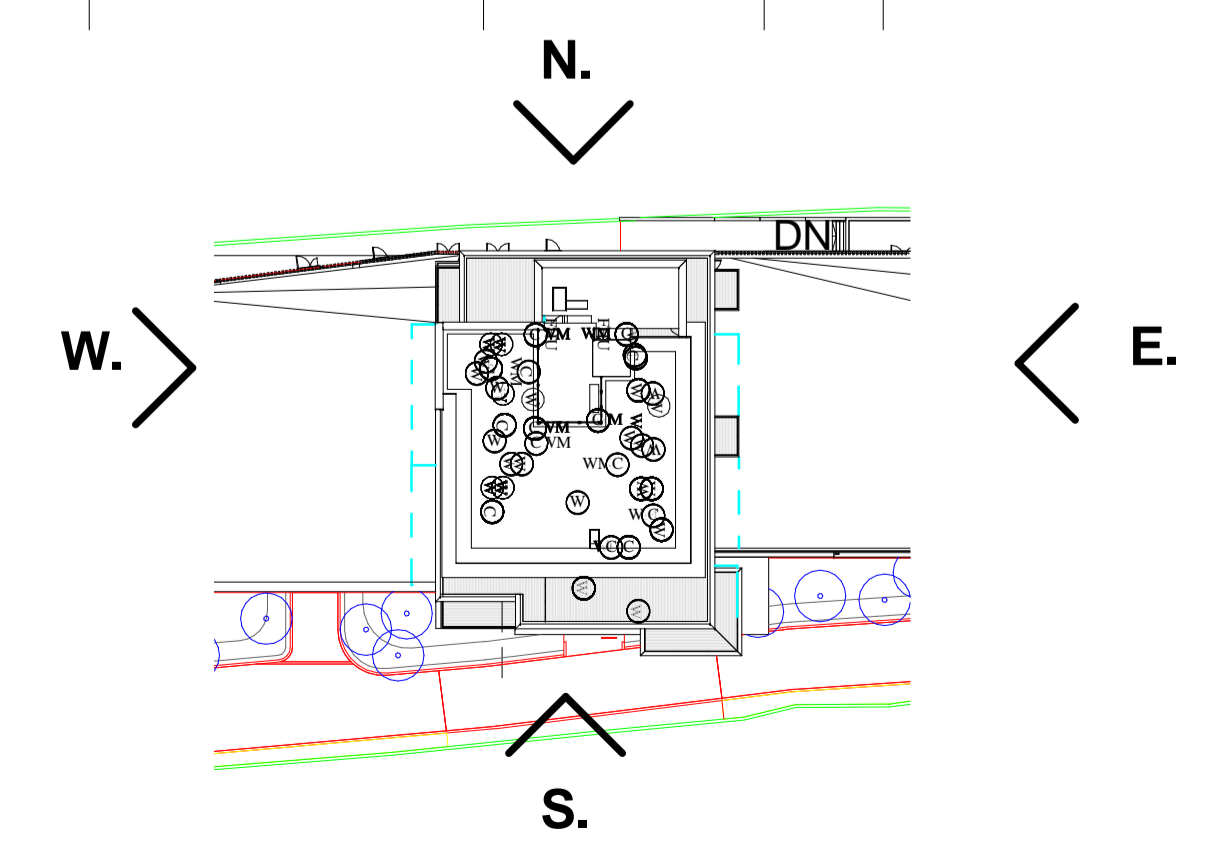

**3 Block B Key Plan**  
1 : 500

| No | Date     | Description                       | By  | Clkd |
|----|----------|-----------------------------------|-----|------|
| E  | 02.09.14 | Minor Amendment to Block B Facade | PH  | DRJ  |
| D  | 30.07.14 | All Window and Door Tags Added    | PH  | DRJ  |
| C  | 20.06.13 | Materials key amended             | MDB | JA   |
| B  | 09.04.13 | Issued for Tender                 | AKS | JA   |
| A  | 25.04.13 | Value Engineering Update          | AKS | JA   |



**BALLYMORE**  
PROJECT  
West Hampstead Square

TITLE  
Block B Elevations Sheet 1

| DRAWING STATUS    |     |         |    |
|-------------------|-----|---------|----|
| For Construction  |     |         |    |
| DRAWN             | AKS | CHECKED | MB |
|                   |     |         |    |
| SCALE             |     |         |    |
| As Indicated @ A1 |     |         |    |
| DATE              |     |         |    |
| 20/02/13          |     |         |    |

**wcec architects**  
South Building, Staple Inn Buildings  
London, WC1V 7PZ

t:020 3388 0019, e: email@wcec.co.uk, www.wcec.co.uk

| JOB NO. | DRAWING NO. | REV |
|---------|-------------|-----|
| 12-316  | A00-B21     | E   |