

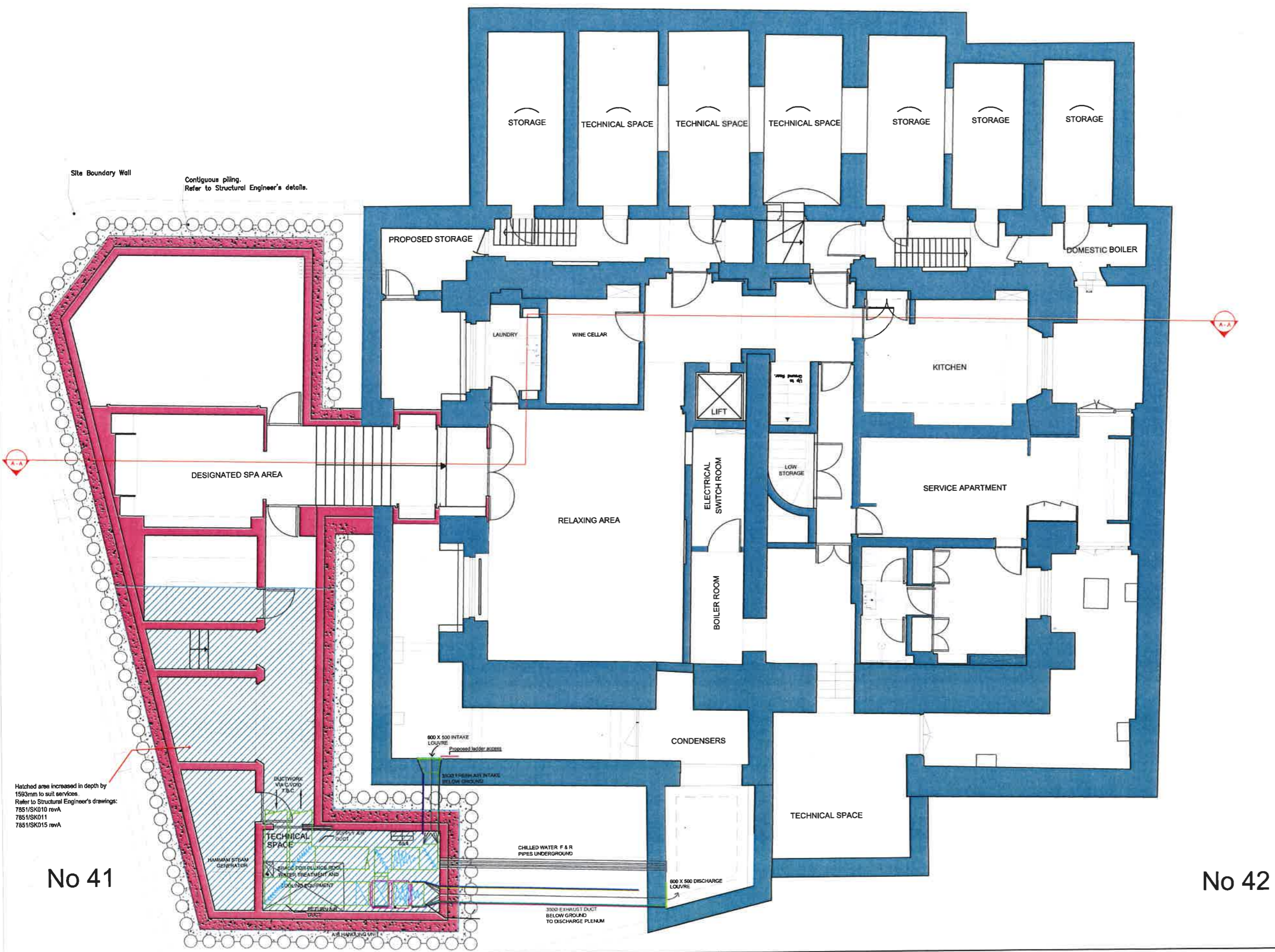

Existing structure
Proposed fabric



Hatched area increased in depth by 150mm to suit services. Refer to Structural Engineer's drawings: 7851/SK010 revA, 7851/SK011, 7851/SK015 revA

No 41

No 42



Client SHALIMAR INVESTORS LTD	Drawing Number PP-BF-03	Rev. FINAL	Date DEC 2014	Title BASEMENT PLAN - AS PROPOSED
Job 41 & 42 CHESTER TERRACE	Job Number N1915	Drawn By FC/MK	Scale 1: 50 @ A1	Note: Please note that information used to produce these drawings is based on measured survey supplied by others; Heritage Architecture can not be held responsible for any inaccuracies that may exist; Please do not scale drawing; All dimensions should be verified on site;
				STEPHEN LEVRANT HERITAGE ARCHITECTURE 62 British Grove, Chiswick, London 20L Telephone : 0208 748 5501 Fax: 0208 748 4992