

**Note:** Contractor to provide all necessary access equipment and ensure existing structure is weatherproof during the course of the works.

**Copyright:** All rights have been asserted. The drawing shall not be reproduced without the prior approval of One Housing Group.

Any discrepancies, errors or omissions to be reported to the project co-ordinator for further instructions before commencement of works.

Do NOT scale from this drawing. The client/contractor is to CHECK all dimensions & report any discrepancies. All work & materials used are to fully comply with ALL standards are required by the relevant Trade Associates, British Standards, Codes of Practice, Manufacture Specifications (BBA Certification etc). All work to be carried out fully in accordance with any Engineers Calculations, Details & Instructions, as and where applicable.

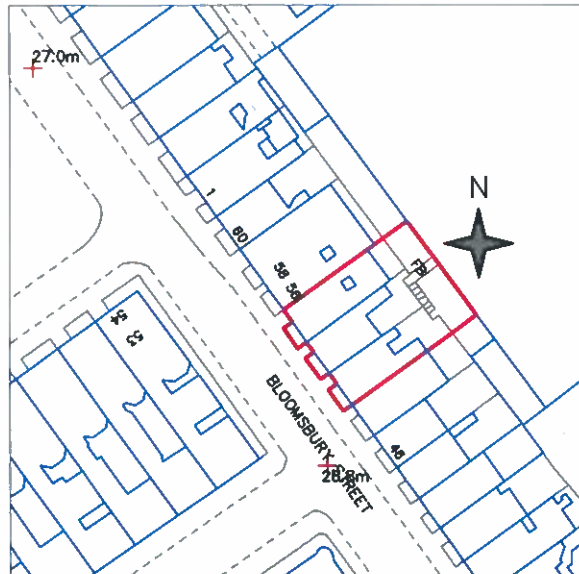

THIS DRAWING IS THE COPYRIGHT OF ONE HOUSING GROUP AND MAY NOT BE REPRODUCED WITHOUT WRITTEN CONSENT. THIS DRAWING IS NOT TO SCALE.



Suttons Wharf South  
44 Palmers Road  
London  
E2 0TA

54, 52 & 50 BLOOMSBURY ROOF  
REMEDIAL WORKS

1:1250 @A4

REV 0

ONE HOUSING GROUP

OCT 2014

LOCATION PLAN

OHG 3/3

LOCATION PLAN 1:1250