

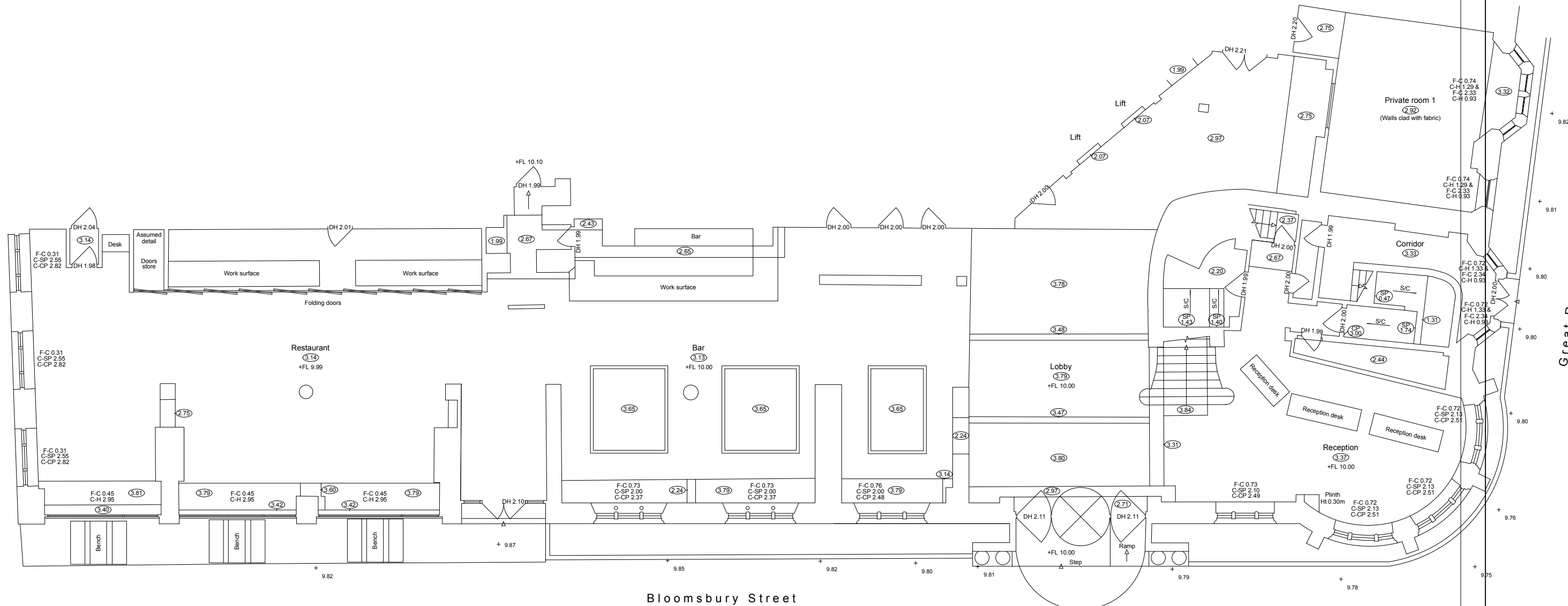

THIS DRAWING IS © ETTWEIN BRIDGES ARCHITECTS LLP. DO NOT SCALE OFF THIS DRAWING. ANY DIMENSIONS SHOWN MUST BE CHECKED ON SITE BEFORE CONSTRUCTION OR MANUFACTURE

NOTES:



GROUND FLOOR AS EXISTING- PART PLAN

REV	DATE	DESCRIPTION
PROJECT BLOOMSBURY ST HOTEL 9-13 Bloomsbury Street, WC1B		
TITLE GROUND FLOOR EXISTING		
DRAWING STATUS PLANNING		
DRAWN **	CHECKED **	SCALE(S) 1:100 @ A2
JOB	DRAWING NUMBER	REVISION
J926	AS 001	-
ETTWEIN BRIDGES ARCHITECTS 53 Rawsorne Street London EC1V 7NQ T: 020 7837 1008 F: 020 7837 4008 E: mail@ebarch.com		
Registered in England and Wales. Partnership No. OC 383122		