

GENERAL NOTES

1. This drawing is copyright and the property of WATERMAN STRUCTURES and is not to be copied in whole or in part except under a written agreement.
2. Do not scale this drawing. Any discrepancy is to be reported to the Engineer immediately.
3. This drawing is to be read in conjunction with all Engineers, Architects or relevant drawings and specifications.
4. All dimensions and levels are to be checked on site by the contractor prior to preparing any working drawings or commencing on site.
5. The contractor must ensure and will be held responsible for the overall stability of the building/structure/excavation at all stages of the work.
6. All work by the contractor must be carried out in such a way that all requirements under the Health and Safety at Work Act are satisfied.
7. All work is to be carried out in compliance with the requirements of the relevant statutory authorities and regulations.

This drawing has been based on the following Bennetts Associates Architects drawings

- 1217-20-099-WIP 140115
- 1217-20-100-WIP 140115
- 1217-20-101-WIP 140115
- 1217-20-102-WIP 140115
- 1217-20-103-WIP 140115
- 1217-20-104-WIP 140115
- 1217-20-105-WIP 140115
- 1217-20-106-WIP 140115
- 1217-20-107-WIP 140115
- 1217-20-108-WIP 140115
- 1217-20-210-WIP 140115
- 1217-20-220-WIP 140115

Rev	Date	Description	By
A01	17.10.14	ISSUED FOR LUL APPROVAL	FP

Project: **One Bedford Avenue**

Title: **GROUND FLOOR GENERAL ARRANGEMENT - STEELWORK**

Client: **Exemplar Properties (Bedford) Ltd**



Pickfords Wharf, Clink Street, London SE1 9DG, United Kingdom
 T +44 20 7928 7888 F +44 3333 444 501
 mail@watermangroup.com www.watermangroup.com

FOR LUL APPROVAL

Designed By	Designer	Checked By	Checker	Project No
Drawn By	Author	Date		STR11621

Scale	As indicated	Works Order No
-------	--------------	----------------

Publisher	Zone	Category	Number	Revision
WSL	SA	20	1100	A01

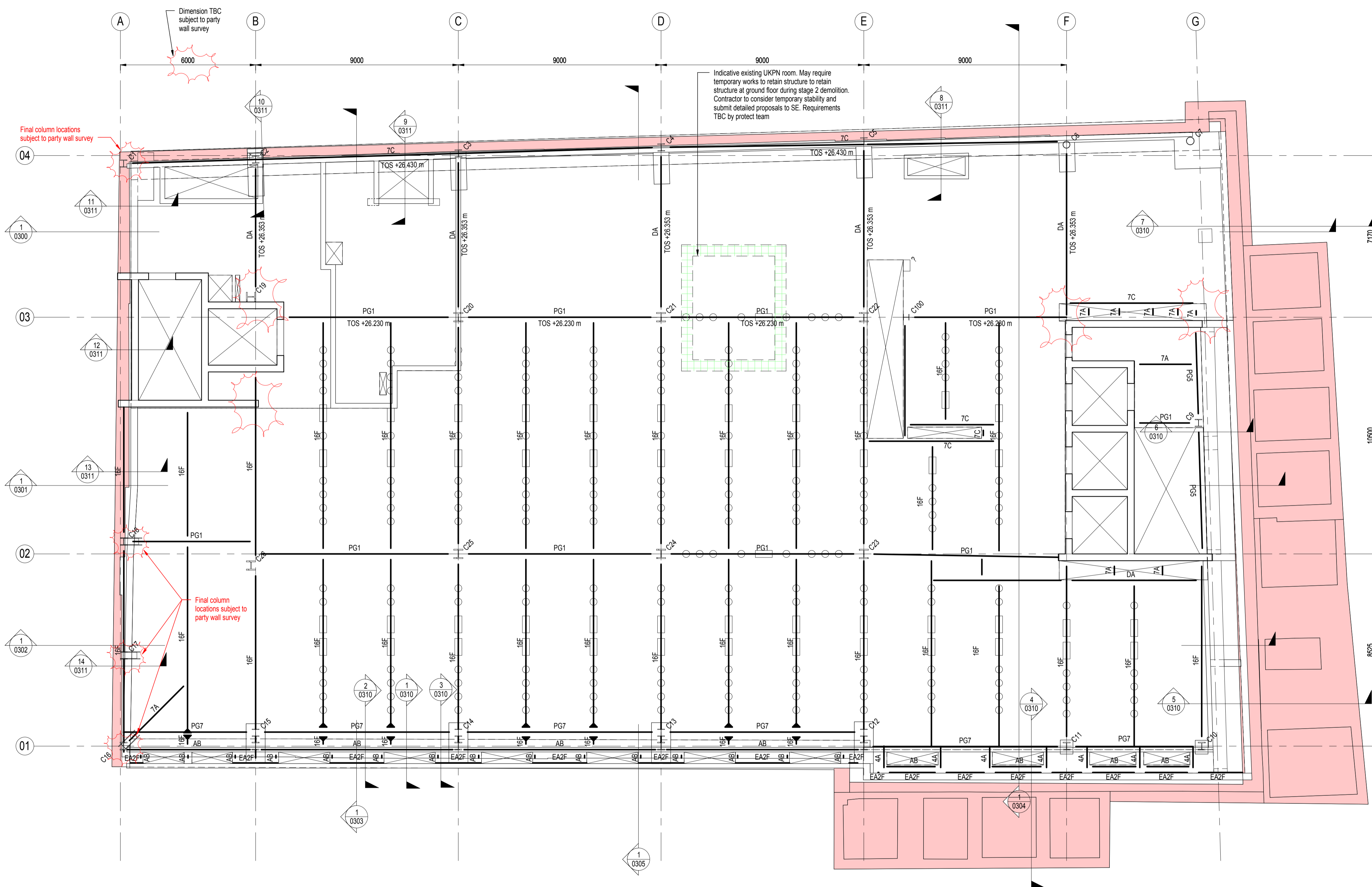

NOTE: All upstand beams to have either shelf angles or bottom plate welded to support metal deck