

This drawing should not be scaled. Dimensions to be verified on site. Any discrepancies should be referred to the Engineer prior to work being put in hand. This drawing is the property of Waterman Structures Limited and the drawing is issued on the condition that it is not copied, reproduced, retained or disclosed to any unauthorised person, either wholly or in part without the consent in writing of Waterman Structures Limited.
 Pickfords Wharf, Clink Street, London SE1 9DG, United Kingdom
 T +44 20 7928 7888 F +44 3333 444 501

GENERAL NOTES

- This drawing is copyright and the property of WATERMAN STRUCTURES and is not to be copied in whole or in part except under a written agreement.
- Do not scale this drawing. Any discrepancy is to be reported to the Engineer immediately.
- This drawing is to be read in conjunction with all Engineers, Architects or relevant drawings and specifications.
- All dimensions and levels are to be checked on site by the contractor prior to preparing any working drawings or commencing on site.
- The contractor must ensure and will be held responsible for the overall stability of the building/structure/excavation at all stages of the work.
- All work by the contractor must be carried out in such a way that all requirements under the Health and Safety at Work Act are satisfied.
- All work is to be carried out in compliance with the requirements of the relevant statutory authorities and regulations.

This drawing has been based on the following Bennetts Associates Architects drawings

1217-20-099-WIP 140115
 1217-20-100-WIP 140115
 1217-20-101-WIP 140115
 1217-20-102-WIP 140115
 1217-20-103-WIP 140115
 1217-20-104-WIP 140115
 1217-20-105-WIP 140115
 1217-20-106-WIP 140115
 1217-20-107-WIP 140115
 1217-20-108-WIP 140115
 1217-20-210-WIP 140115
 1217-20-220-WIP 140115

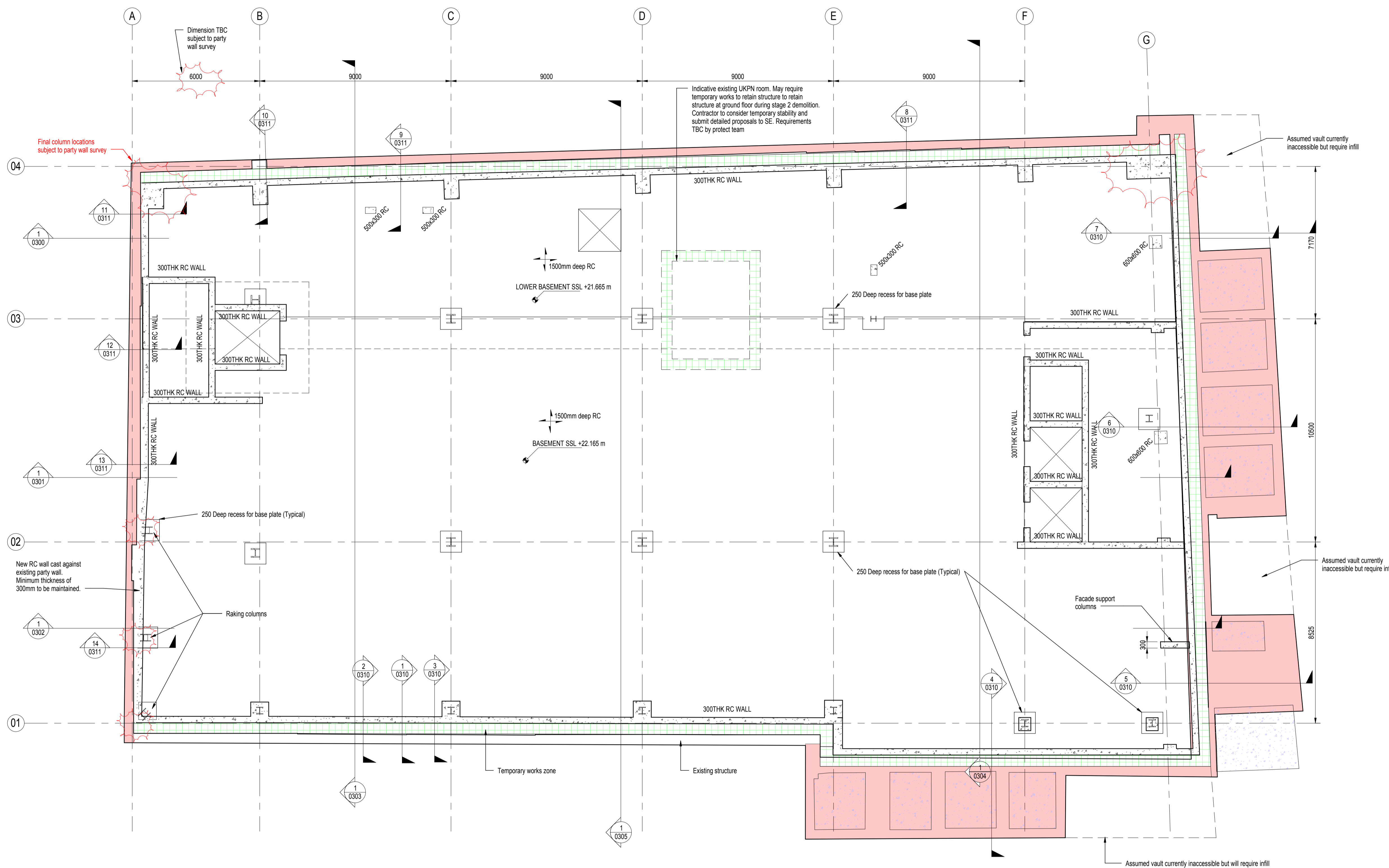

A01	17.10.14	ISSUED FOR LUL APPROVAL	FP
Rev	Date	Description	By

Project: **One Bedford Avenue**

Title: **BASEMENT GENERAL ARRANGEMENT - CONCRETE**

Client: **Exemplar Properties (Bedford) Ltd**



Pickfords Wharf, Clink Street, London SE1 9DG, United Kingdom
 T +44 20 7928 7888 F +44 3333 444 501
 mail@watermangroup.com www.watermangroup.com

Drawing Status: FOR LUL APPROVAL				
Designed By	Designer	Checked By	Checker	Project No
Drawn By	Author	Date		STR11621
Scales @ A1				Works Order No
As indicated				
Publisher	Zone	Category	Number	Revision
WSL	SA	20	0090	A01

Central:\INT-LNCS\SL\Projects\STR11621\CAD\3D\STR11621-14-Stage D.rvt