

**NOTES**

1. DO NOT SCALE FROM THIS DRAWING. WORK FROM FIGURED DIMENSIONS ONLY.
2. ALL DIMENSIONS SHOWN ON THIS DRAWING ARE IN METRES.
3. TRACKING ON THIS PLAN IS BASED ON THE FOLLOWING DESIGN VEHICLE.

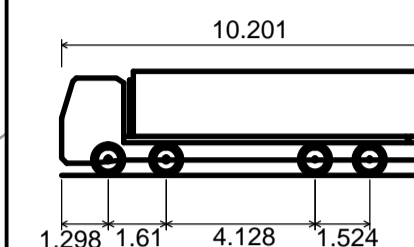

Large Tipper	10.201m
Overall Length	2.495m
Overall Width	2.880m
Min Body Ground Clearance	0.341m
Track Width	2.471m
Lock to Lock Time	6.00s
Kerb to Kerb Turning Radius	11.550m

A	FOOTWAY REINFORCEMENT ADDED	SR	PH	SRB	12.14
Rev	Amendments	Dm	Chk	App	Date

**Odyssey Markides**

Elizabeth House  
39 York Road  
London  
SE1 7WZ

Telephone: 0207 620 2444  
Fac: 0207 620 1168  
E: enquiries@odysseymarkides.com  
W: www.odysseymarkides.com

Job Title  
**PARLIAMENT HILL SCHOOL, CAMDEN**

Drawing Title  
**CONSTRUCTION SITE ENTRY AND EXIT- STAGE 1 (SHEET 1 OF 2)**

Client  
**ASTUDIO LTD**

Scale	Date	Designed
1:250 @A1	JULY '14	AJ
Drawn	Checked	Approved
AJ	PJH	SRB
Job No	Drawing No	Rev
13-255	13-255-101	A

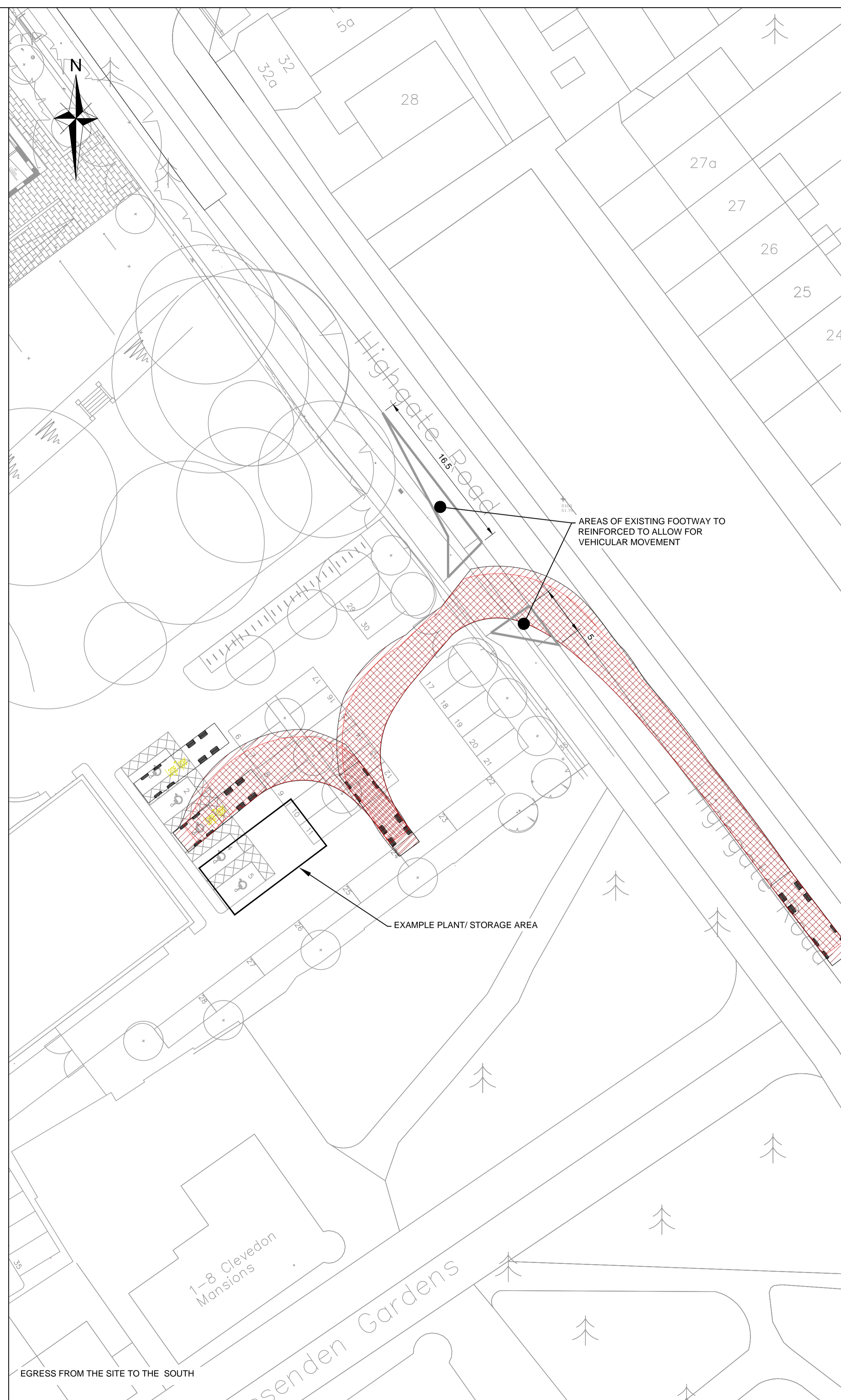
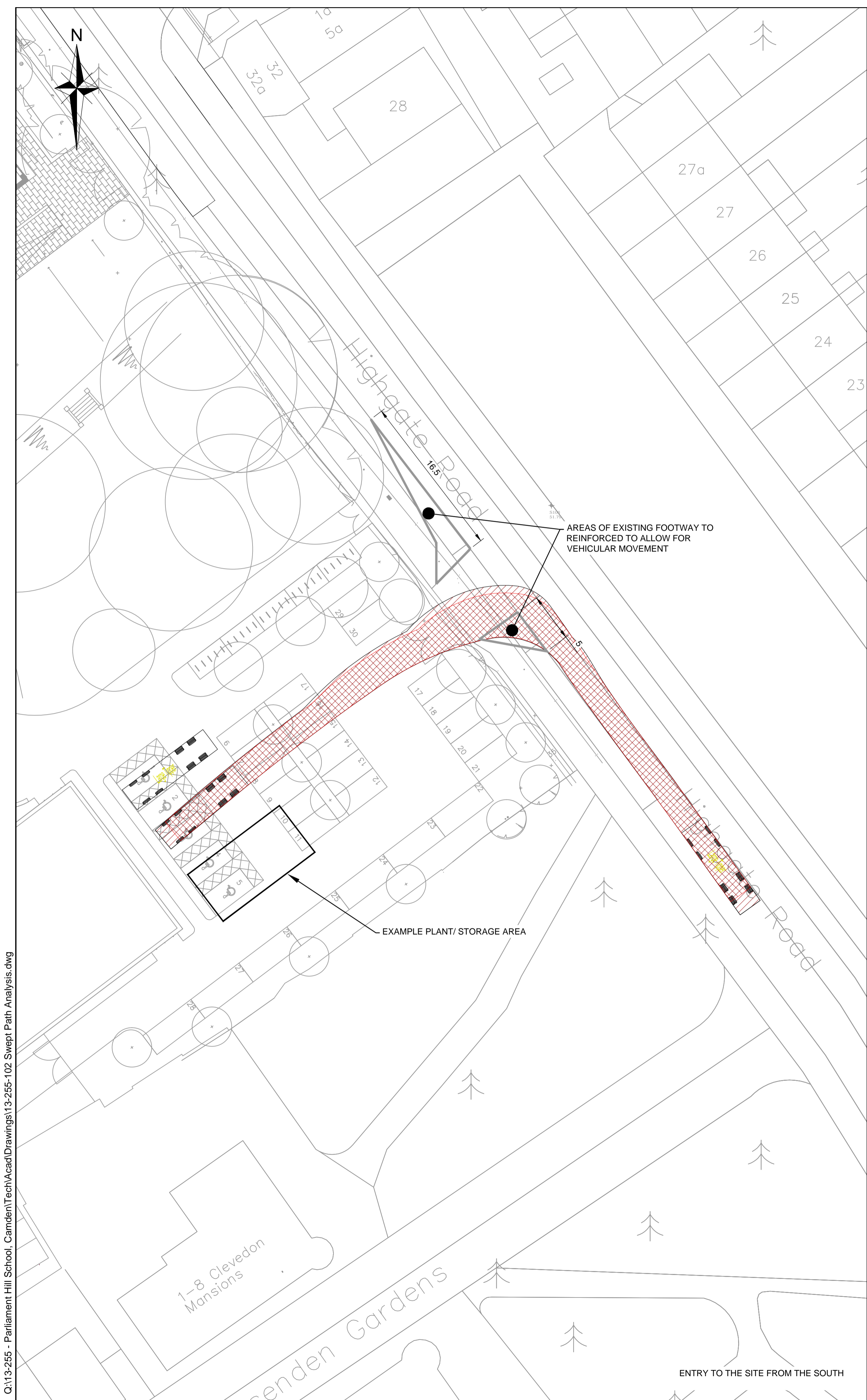

**NOTES**

- DO NOT SCALE FROM THIS DRAWING. WORK FROM FIGURED DIMENSIONS ONLY.
- ALL DIMENSIONS SHOWN ON THIS DRAWING ARE IN METRES.
- TRACKING ON THIS PLAN IS BASED ON THE FOLLOWING DESIGN VEHICLE.

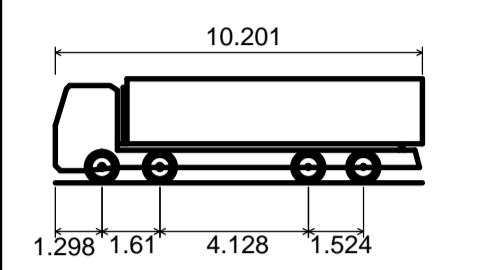

Large Tipper	10.201m
Overall Length	2.495m
Overall Width	2.890m
Overall Body Height	0.241m
Min Body Ground Clearance	2.471m
Track Width	6.30s
Lock to Lock Time	11.550m
Kerb to Kerb Turning Radius	

A	FOOTWAY REINFORCEMENT ADDED	SR	PH	SRB	12.14
Rev	Amendments	Drn	Chk	App	Date

**Odyssey Markides**

Elizabeth House  
29 York Road  
London  
SE1 7NG

Telephone: 0207 620 2444  
Fax: 0207 620 1168  
E: enquiries@odysseymarkides.com  
W: www.odysseymarkides.com

Job Title  
**PARLIAMENT HILL SCHOOL, CAMDEN**

Drawing Title  
**CONSTRUCTION SITE ENTRY AND EXIT- STAGE 1 (SHEET 2 OF 2)**

Client  
**ASTUDIO LTD**

Scale	1:250 @A1	Date	JULY '14	Designed	AJ
Drawn	AJ	Checked	PJH	Approved	SRB
Job No	13-255	Drawing No	13-255-102	Rev	A

Q:13-255 - Parliament Hill School, CamdenTechAcadDrawings13-255-102 Swept Path Analysis.dwg

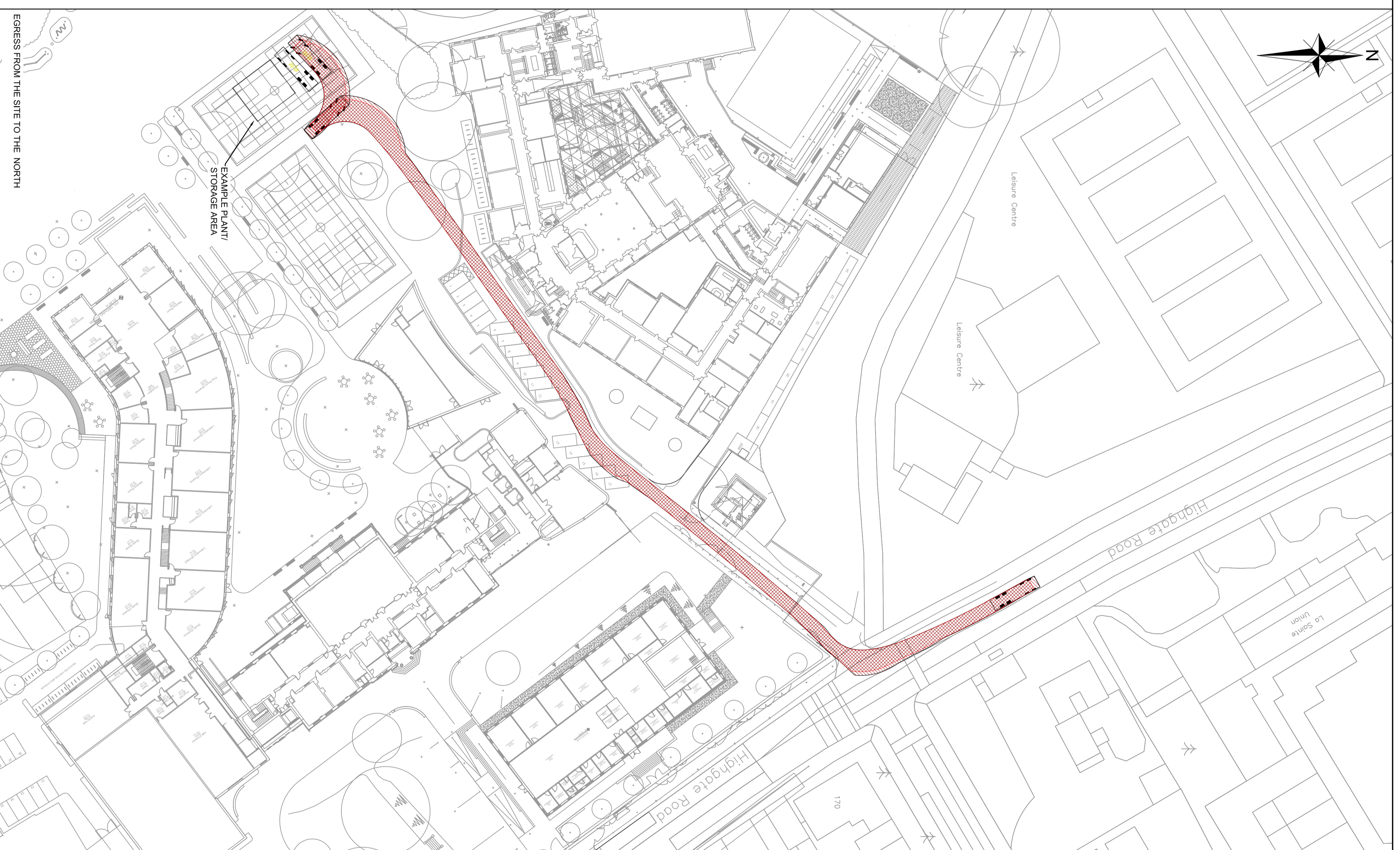
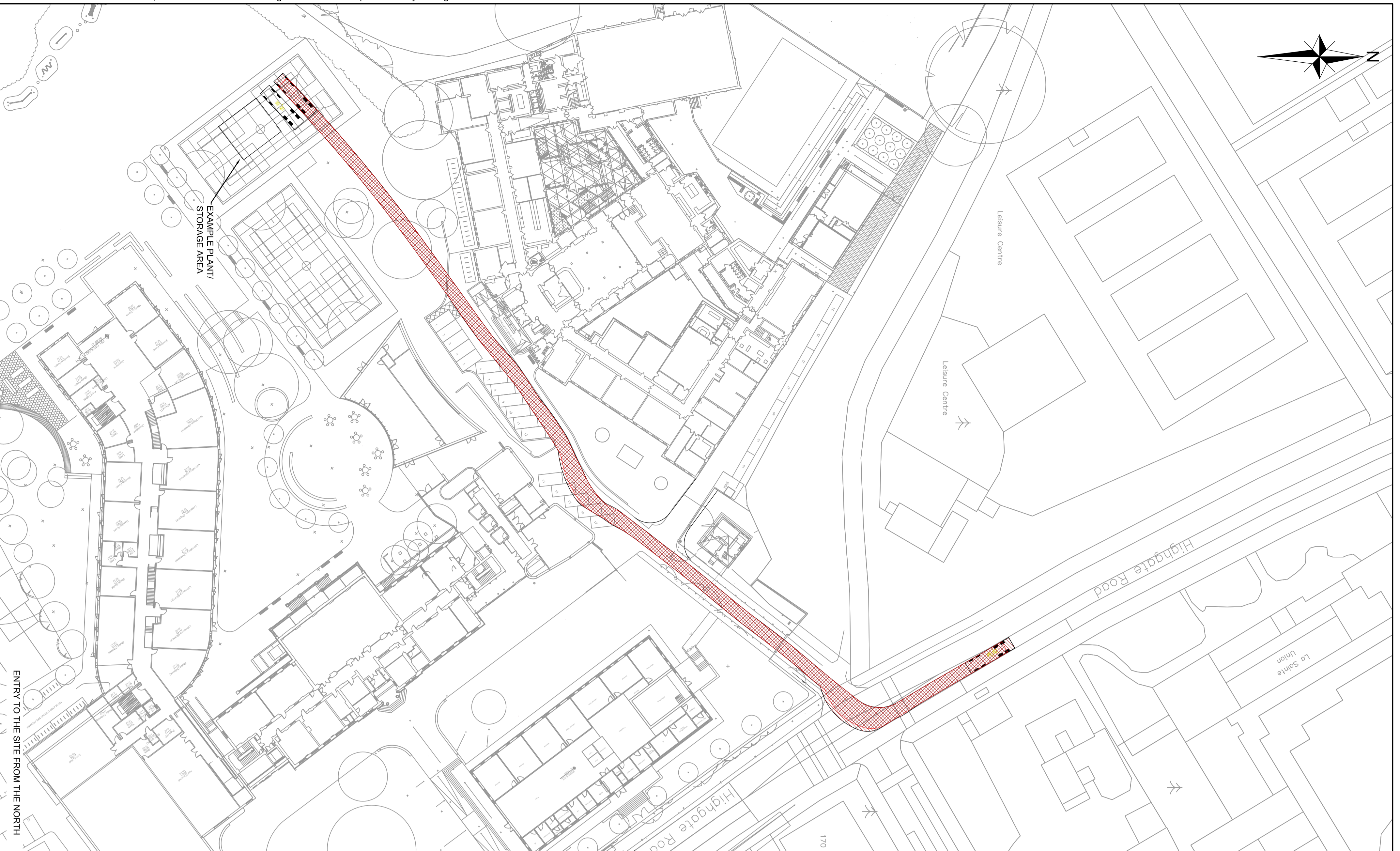

NOTES

1. DO NOT SCALE FROM THIS DRAWING. WORK FROM FIGURED DIMENSIONS ONLY.
2. ALL DIMENSIONS SHOWN ON THIS DRAWING ARE IN METRES.
3. TRACKING ON THIS PLAN IS BASED ON THE FOLLOWING DESIGN VEHICLE.

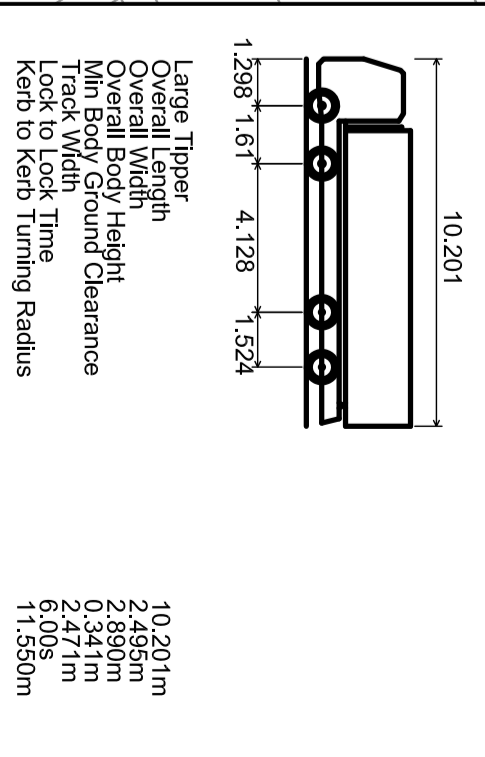

Job Title	PARLIAMENT HILL SCHOOL, CAMDEN		
Client	ASTUDIO LTD		
Drawing Title	CONSTRUCTION SITE ENTRY AND EXIT - STAGE 2 (SHEET 1 OF 2)		
Scale	1:500 @A1	Date	JULY 14
Drawn	AJ	Checked	PJH
Job No	13-255	Drawing No	13-255-103
Designed	AJ	Approved	SRB

**Odyssey**  
 Markides  
 37 Wake Road, London, W15 2NU  
 Tel: 0203 003 1168  
 Fax: 0203 003 1169  
 Email: info@odyssey-markides.com  
 Website: www.odyssey-markides.com

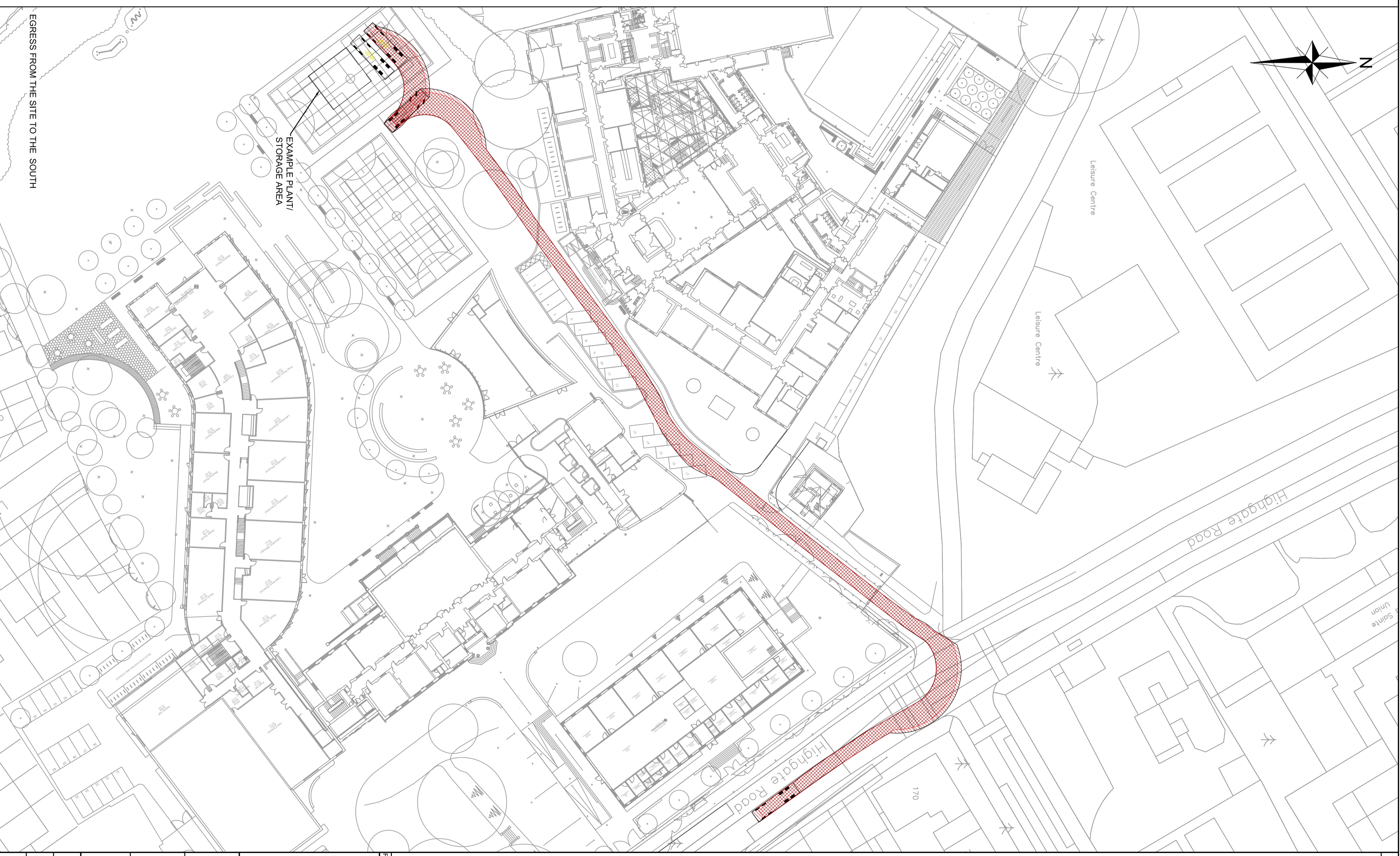
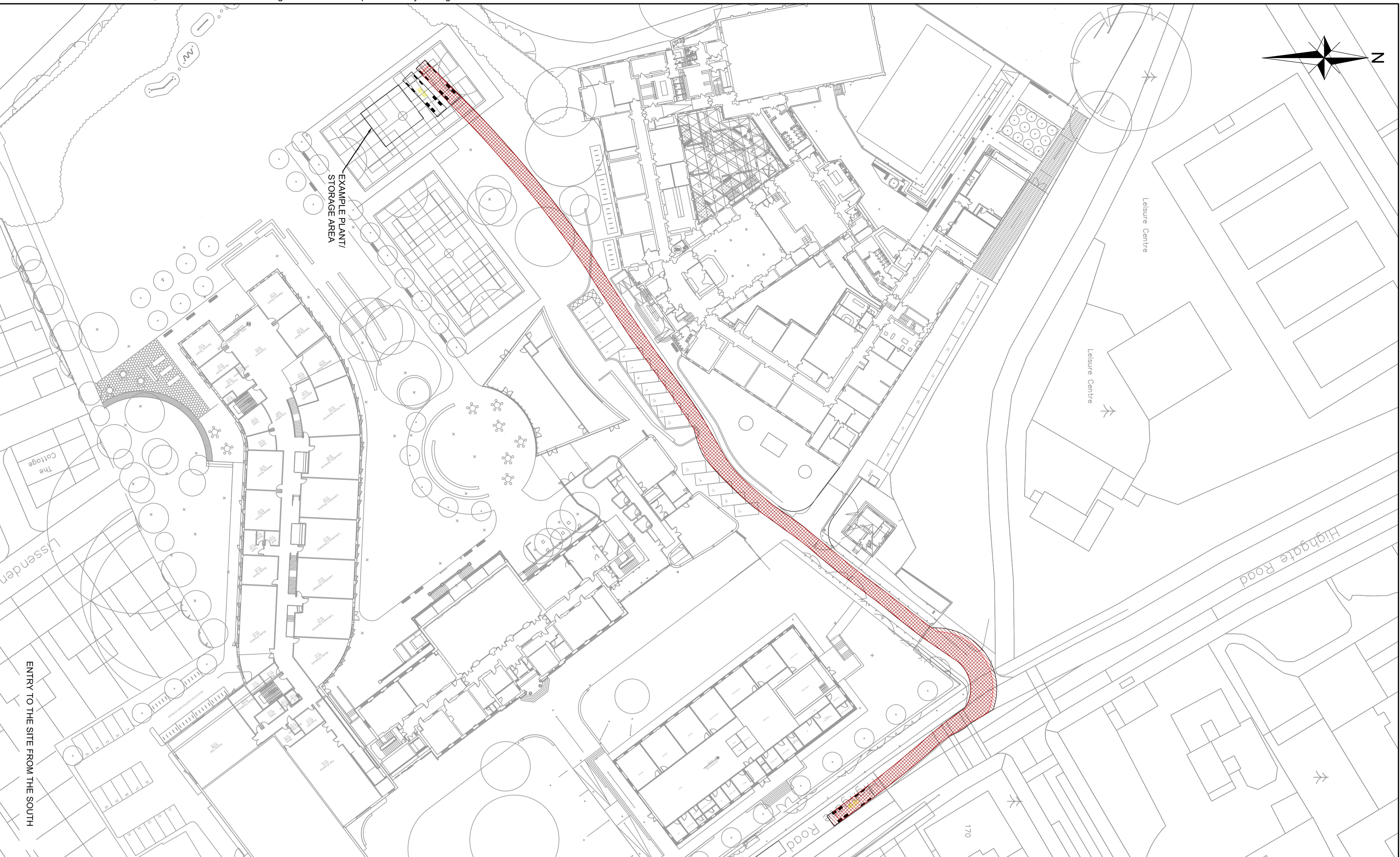

- NOTES**
- DO NOT SCALE FROM THIS DRAWING. WORK FROM FIGURED DIMENSIONS ONLY.
  - ALL DIMENSIONS SHOWN ON THIS DRAWING ARE IN METRES.
  - TRACKING ON THIS PLAN IS BASED ON THE FOLLOWING DESIGN VEHICLE.

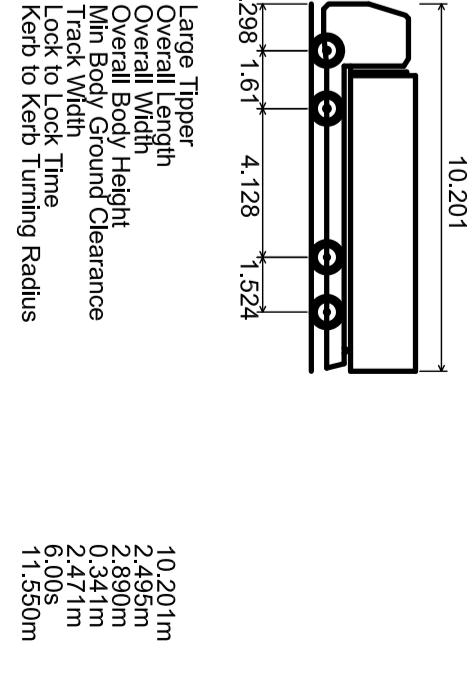

Job No	13-255	Drawing No	13-255-104
Scale	1:250 @A1	Date	JULY 14
Drawn	AJ	Checked	PJH
Client	ASTUDIO LTD		
Drawing Title	PARLIAMENT HILL SCHOOL, CAMDEN CONSTRUCTION SITE ENTRY AND EXIT - STAGE 2 (SHEET 2 OF 2)		
Job Title	PARLIAMENT HILL SCHOOL, CAMDEN		
Client	ASTUDIO LTD		
Author	AJ		
Checked	PJH		
Approved	SRB		
Rev	Rev		

**Odyssey Markides**  
 37 Wake Road  
 3rd Floor  
 London W15 2NU  
 Tel: 0203 703 1165  
 Fax: 0203 703 1166  
 Email: info@odyssey-markides.com  
 Website: www.odyssey-markides.com

Q:\13-255 - Parliament Hill School, Camden\Tech\Acad\Drawings\13-255-105 Pedestrian footway diversion during works.dwg

NOTES

SIGN TO DIA. 7018



(USE OTHER FOOTWAY)

EXISTING ZEBRA CROSSING

FOOTPATH CLOSED FOR PEDESTRIANS AS REQUIRED TO ACCOMMODATE CONSTRUCTION VEHICLES

EXISTING FORMAL CROSSING

SIGN TO DIA. 7018



(USE OTHER FOOTWAY)

REPRODUCED FROM ORDNANCE SURVEY (®) BY THE PERMISSION OF THE CONTROLLER OF HER MAJESTY'S STATIONERY OFFICE. (©) CROWN COPYRIGHT. ALL RIGHTS RESERVED. LICENCE NUMBER 100045322.

Rev	Amendments	Dm	Chk	App	Date



Elizabeth House  
39 York Road  
London  
SE1 7YQ

Telephone: 0207 620 2444  
Fax: 0207 620 1168  
E: enquiries@odyssey-markides.com  
W: www.odyssey-markides.com

Job Title  
PARLIAMENT HILL SCHOOL  
CAMDEN

Drawing Title  
PEDESTRIAN FOOTWAY  
DIVERSION DURING WORKS

Client  
ASTUDIO LTD

Scale 1:100 @A1	Date JUNE'14	Designed SR
Drawn AJ	Checked PJH	Approved SRB
Job No 13-255	Drawing No 13-255-105	Rev