

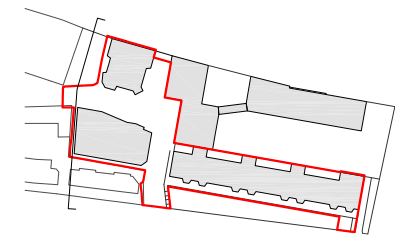

PROPOSED CONTEXT SECTION SE2



Do not scale from this drawing. Verify all dimensions on site. Drawing should be read in conjunction with information from all other design consultants and contractors. All drawings in digital format are for reference only, paper copies are available on request.

FOR PLANNING

© Maccreeanor Lavington Architects

Existing buildings elevations as received from APR services, on June 2014

Existing buildings heights are based on survey information and are therefore representative of actual buildings

Existing trees information as received from Raphael Skerratt, on September 2014

For proposed landscape information refer to JCLA landscape drawings submitted as part of this planning application

For detailed information of each building refer to 1:100 drawings submitted as part of this planning application

Rev Details

Drwn Date

Application 02
Expansion of Kingsgate Primary School & Redevelopment of Liddell Road Phase 02

Client London Borough of Camden
 Title Proposed Context Section SE2

Scale 1:250 @ A1 1:500 @ A3
 Date 01-12-2014 Drawn JS / JY

MLUK / 403 / P2 / 085

MaccreeanorLavington

3rd Floor
 19-21 Nile Street
 London N1 7LL

t +44(0)207 336 73 53
 f +44(0)207 336 76 55
 e uk@ml-architects.com