

R1

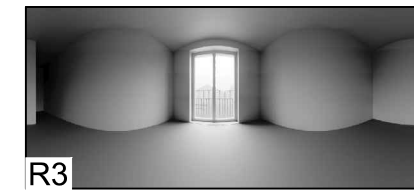

R2



R3

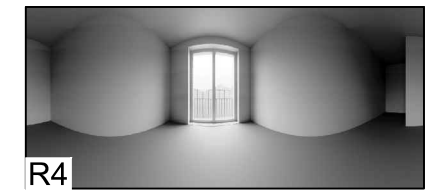

R4



R5

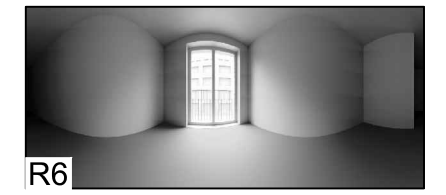

R6

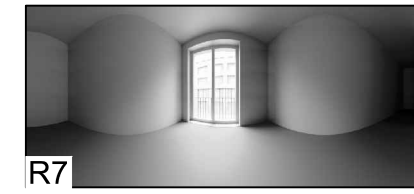

R7

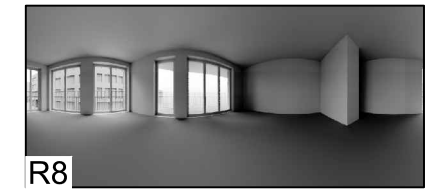

R8

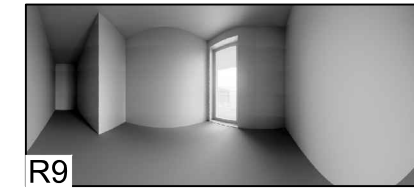

R9

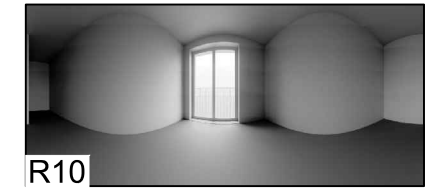

R10

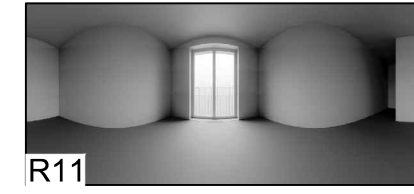

R11

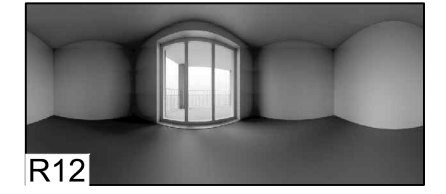

R12



R13

FIRST FLOOR

Sources: MACCREANOR LAVINGTON
 MLUK/403/L/181-188 series
 MLUK/403/L/150-157 series
 MLUK/403/SK/103
 MLUK/403/SK/110-115 series
 3D Proposed Scheme 16/10/14

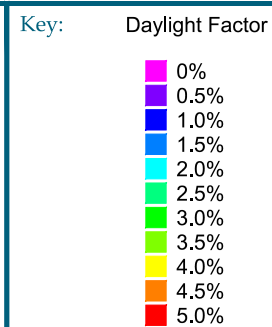

Project: 403 Liddell / Kingsgate School
 London

Title: Daylight Factor Results
 Block B
 First Floor

Point 2 Surveyors Ltd,
 Centric House,
 390 Strand,
 London WC2R 0LT,
 0207 836 5828
 www.point2surveyors.com

Drawn By: JCA/CGC

Scale: 1:150

Date: DIC 14

Dwg No: P297/DF/16

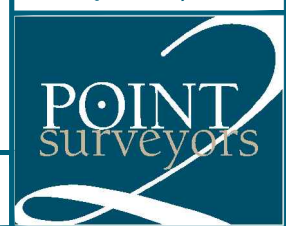

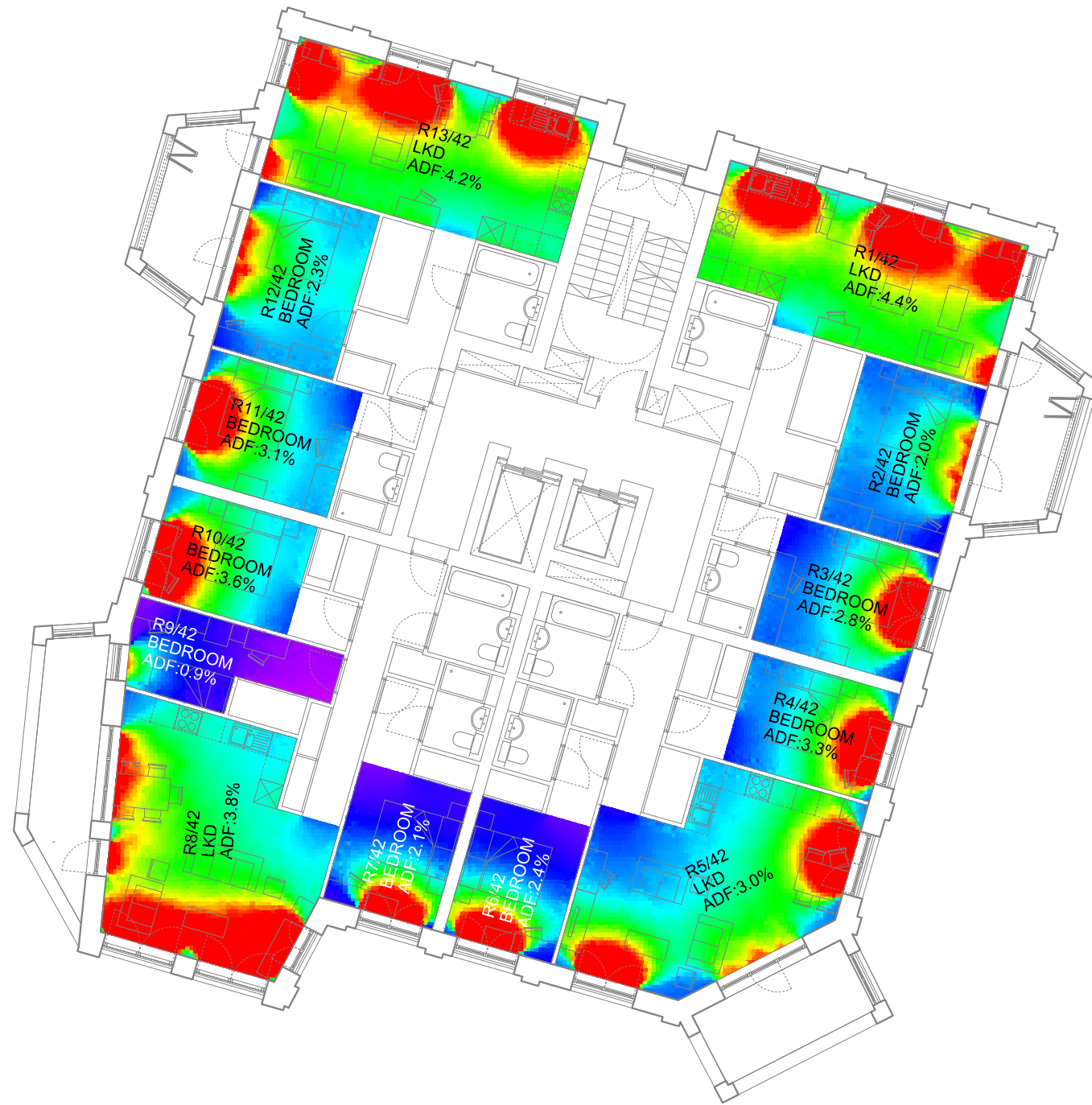
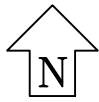

R1



R2

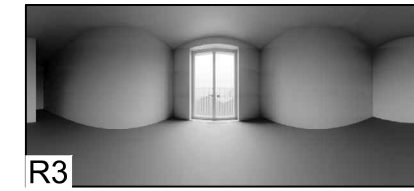

R3



R4



R5



R6



R7

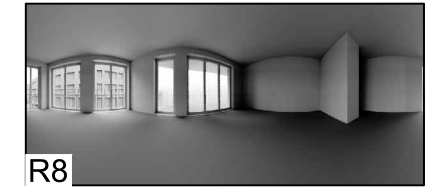

R8

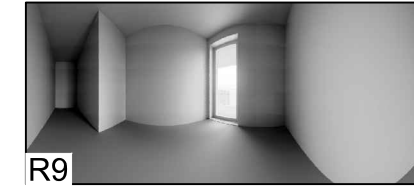

R9

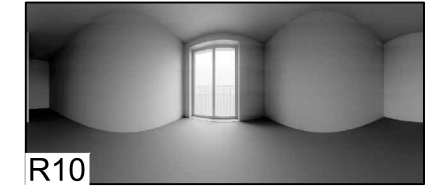

R10

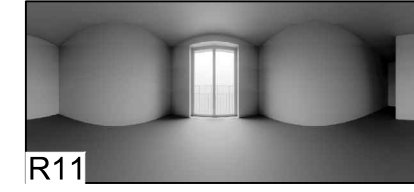

R11

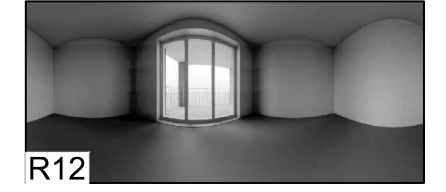

R12



R13

SECOND FLOOR

Sources: MACCREANOR LAVINGTON
MLUK/403/L/181-188 series
MLUK/403/L/150-157 series
MLUK/403/SK/103
MLUK/403/SK/110-115 series

3D Proposed Scheme 16/10/14

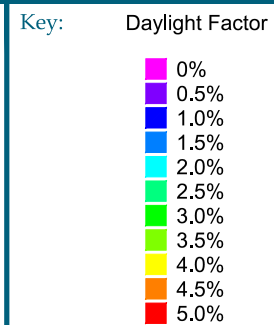

Project: 403 Liddell / Kingsgate School
London

Title: Daylight Factor Results
Block B
SecondFloor

Point 2 Surveyors Ltd,
Centric House,
390 Strand,
London WC2R 0LT,
0207 836 5828
www.point2surveyors.com

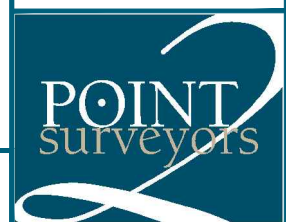

Drawn By: JCA/CGC

Scale: 1:150

Date: DIC 14

Dwg No: **P297/DF/17**

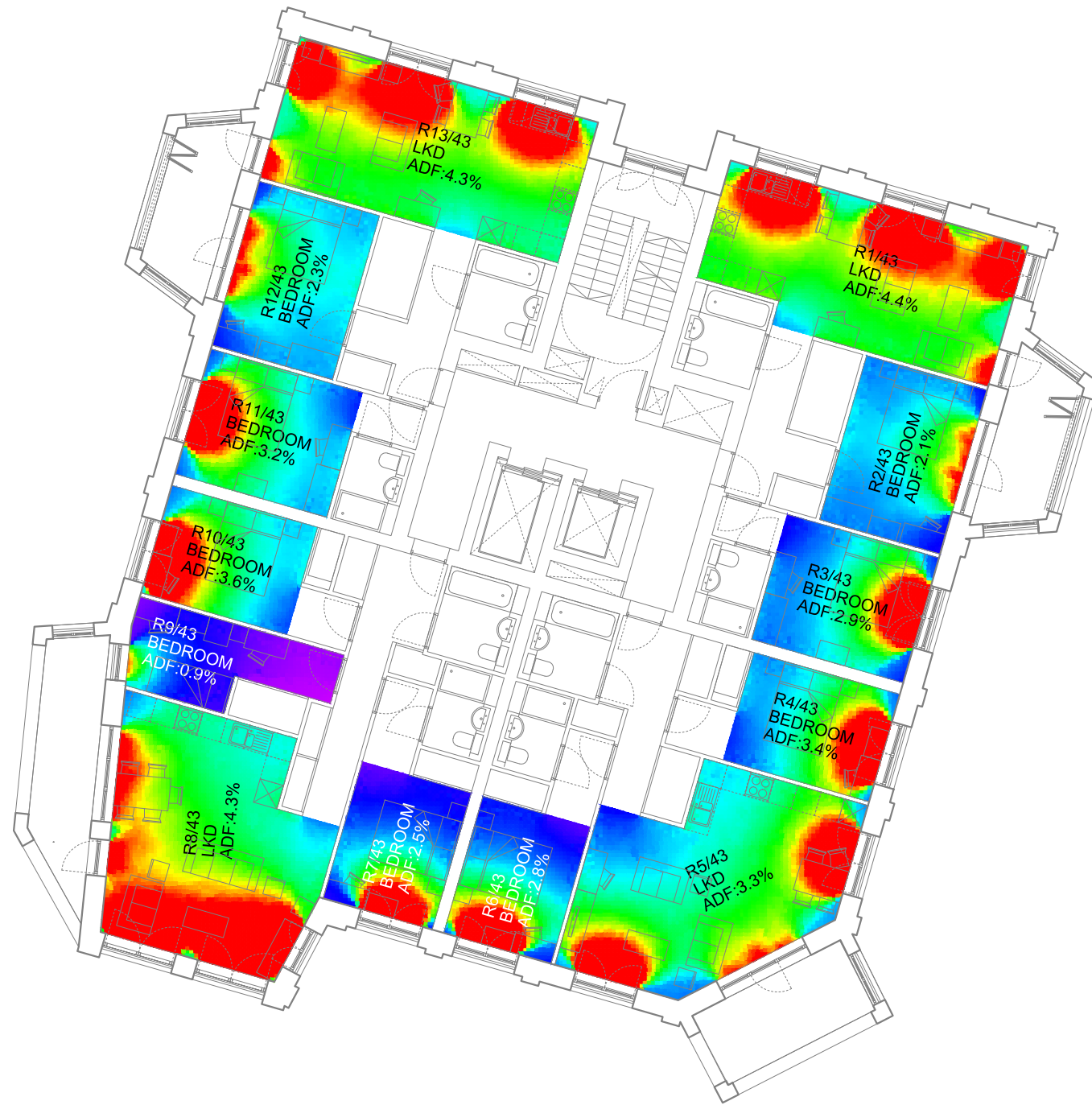
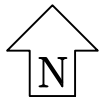

R1



R2



R3



R4



R5

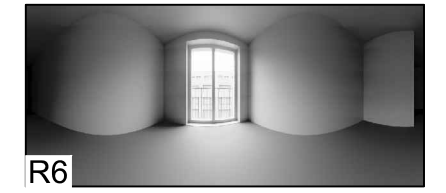

R6



R7

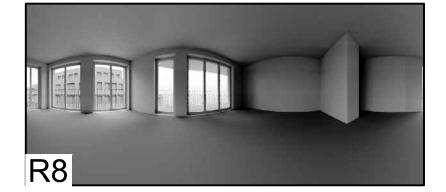

R8

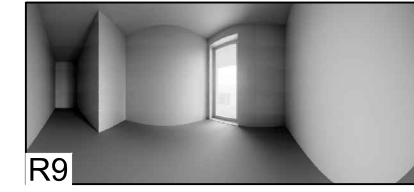

R9

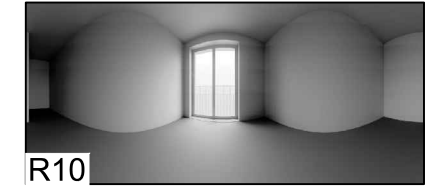

R10

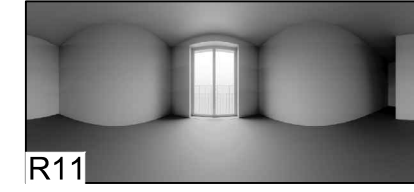

R11

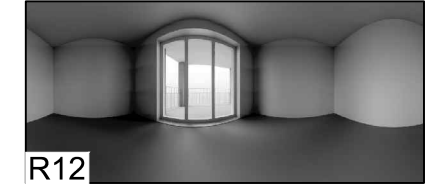

R12

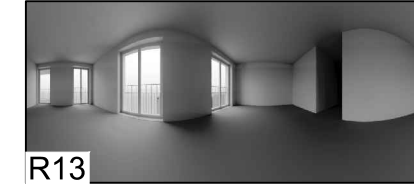

R13

THIRD FLOOR

Sources: MACCREANOR LAVINGTON
MLUK/403/L/181-188 series
MLUK/403/L/150-157 series
MLUK/403/SK/103
MLUK/403/SK/110-115 series

3D Proposed Scheme 16/10/14

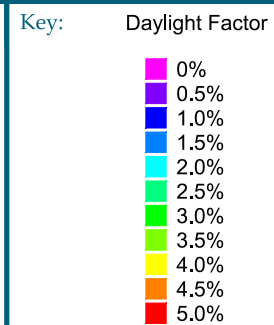

Project: 403 Liddell / Kingsgate School
London

Title: Daylight Factor Results
Block B
Third Floor

Point 2 Surveyors Ltd,
Centric House,
390 Strand,
London WC2R 0LT,
0207 836 5828
www.point2surveyors.com

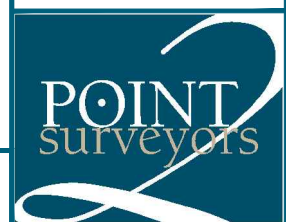

Drawn By: JCA/CGC

Scale: 1:150

Date: DIC 14

Dwg No: **P297/DF/18**



CONTINUED ON PLOT P297/DF/05

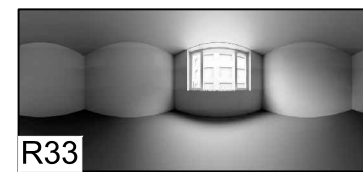
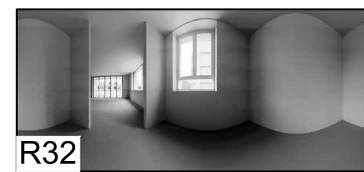
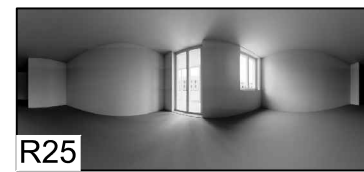
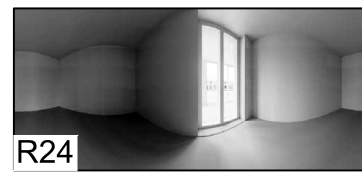
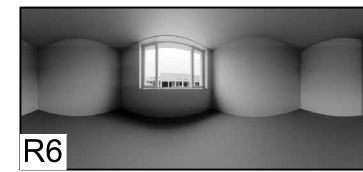
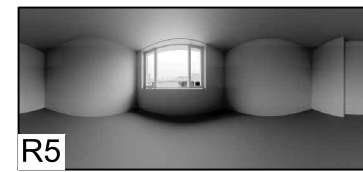
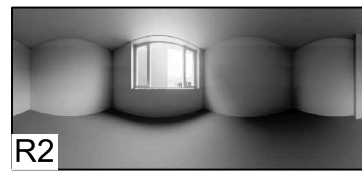
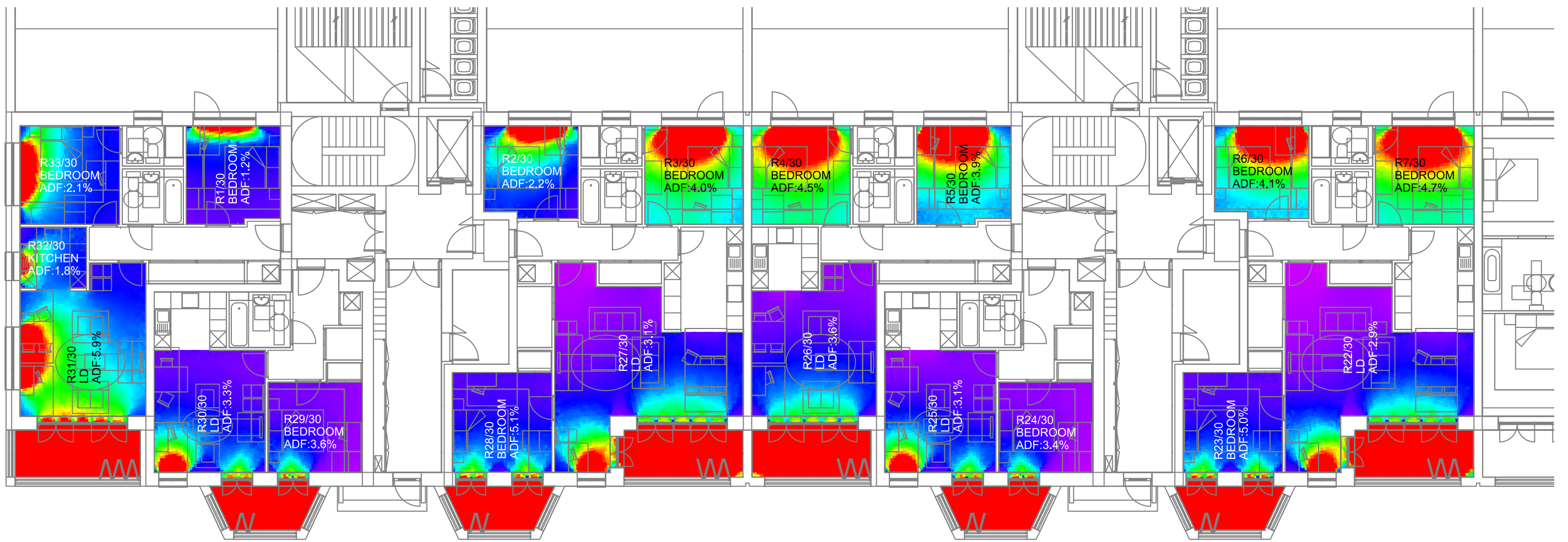

GROUND FLOOR

Sources: MACCREANOR LAVINGTON
 MLUK/403/L/181-188 series
 MLUK/403/L/150-157 series
 MLUK/403/SK/103
 MLUK/403/SK/110-115 series
 3D Proposed Scheme 16/10/14

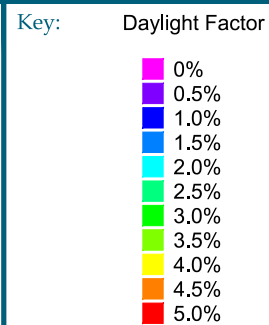

Project: 403 Liddell / Kingsgate School
 London

Title: Daylight Factor Results
 Block C
 Ground Floor 1

Point 2 Surveyors Ltd,
 Centric House,
 390 Strand,
 London WC2R 0LT,
 0207 836 5828
 www.point2surveyors.com



Drawn By: JCA/CGC

Scale: 1:150

Date: DIC 14

Dwg No: P297/DF/19