

39 BELSIZE ROAD

41 BELSIZE ROAD

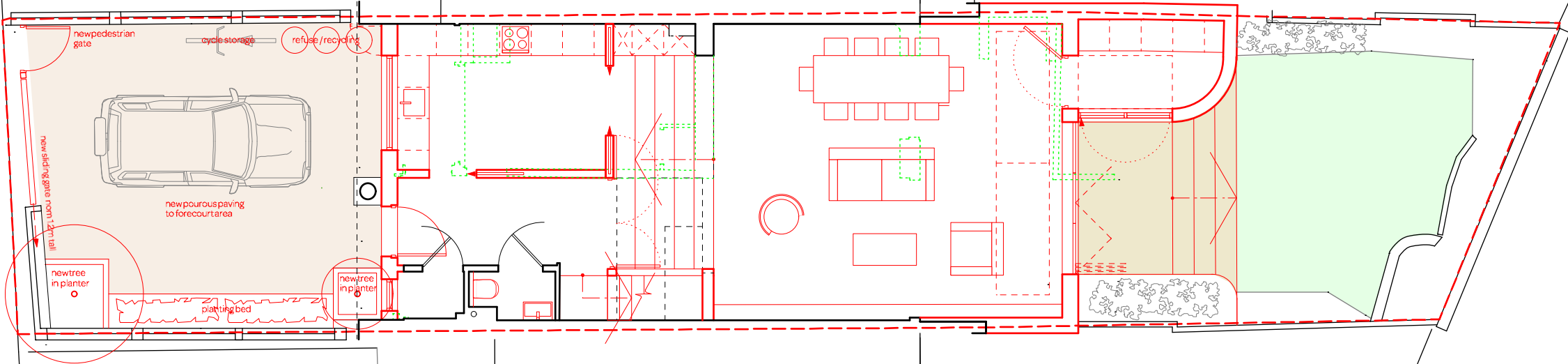

45 BELSIZE ROAD

notes:

General notes:
 1. All dimensions are in millimeters unless noted otherwise.
 2. All dimensions shall be verified on site before proceeding with the work.
 3. Square Feet Architects shall be notified in writing of any discrepancies.

Party Wall Act 1996:
 Note: If the project progresses onto site without the involvement of Square Feet Architects the Client must seek advice prior to commencement of the planned works as detailed on the drawings to establish whether the works fall within the scope of the Act which required adjoining property owners to be served with a statutory notice.

C.D.M. Regulations 2007:
 These drawings have been produced for the purpose of applying for Planning and Building Regulations only. If the project progresses on to site without the involvement of Square Feet Architects, the client and contractor must ensure that they fulfil the duties in respect of the construction (Design and Management) Regulations 1994. If advice is required please do not hesitate to contact Square Feet Architects.

KEY
 black lines existing
 red lines new
 green lines to be demolished

PLANNING

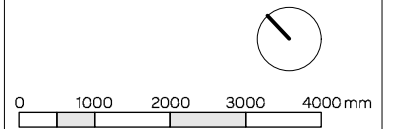

revision:
 *December 2014 - Planning Issue



A : 8a Baynes Mews, London NW3 5BH
 T : 0207 431 4500
 E : studio@squarefeetarchitects.co.uk
 W : www.squarefeetarchitects.co.uk

drawing title:
PROPOSED SITE PLAN

client:
 Michelle Chan & Kai Keen Shiu

project:
43 Belsize Road, NW6 4RX

date: December 2014
 scale: 1:100@A3

drawing number: 1427-L-020
 revision: *