

Do not scale from this drawing. Verify all dimensions on site. Drawing should be read in conjunction with information from all other design consultants and contractors. All drawings in digital format are for reference only, paper copies are available on request.

FOR PLANNING

© Maccreanor Lavington Ltd.

For proposed landscape information refer to JCLA landscape drawings submitted as part of this planning application

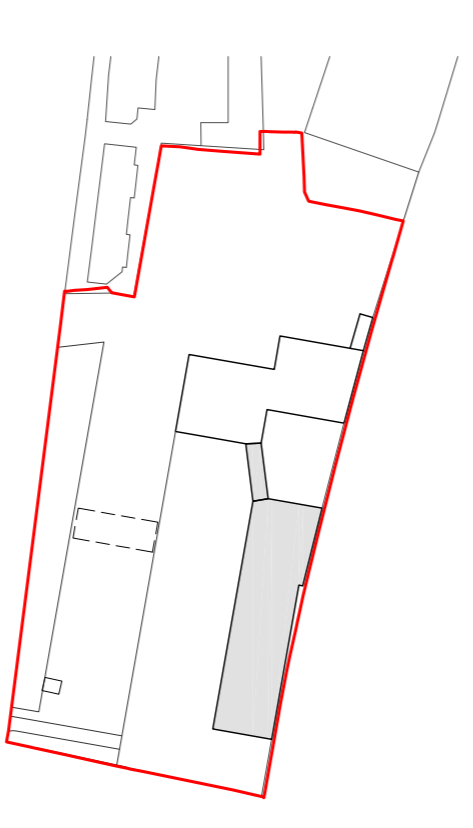
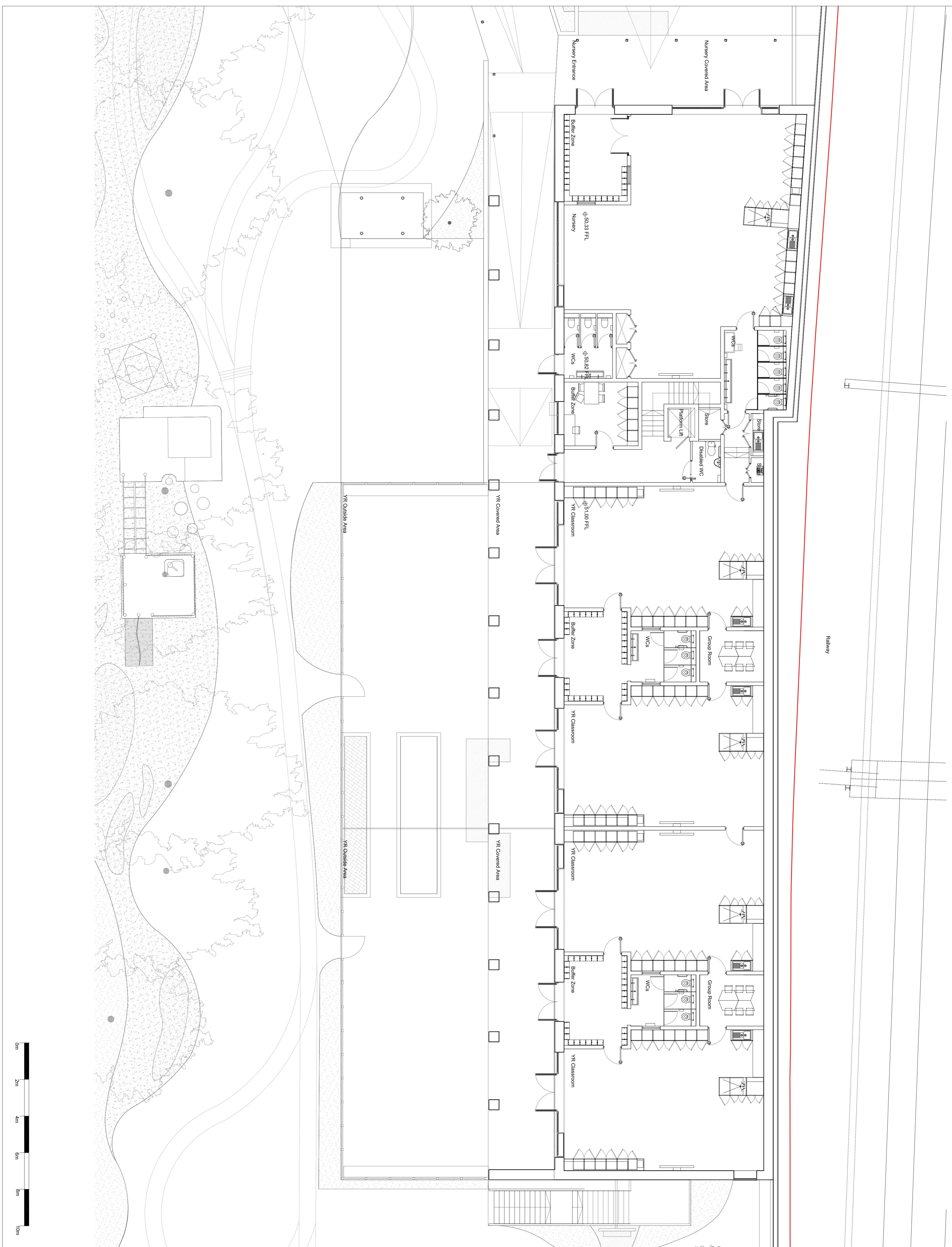

Rev	Details	Dwn	Date
-----	---------	-----	------

Application 01
Expansion of Kingsgate Primary School & Redevelopment of Liddell Road Phase 01
Client: London Borough of Camden
Title: School Building 02
Ground Floor Plan
Scale: 1:100 @ A1 / 1:200 @ A3
Date: 01-12-2014
Drawn: HDJP
MLA / 403 / P1 / 130

MaccreanorLavington
3rd Floor
19-21 Niles Street
London N1 7LL
t +44(0)207 336 73 53
f +44(0)207 336 76 55
e uk@mlsarchitects.com

