

Broomsleigh Street

Sequential Views, Broomsleigh Street, eastern side of the street

The orientation of the street and the location of the rail line at the southern end of the street will mean that the proposed workspace building will be visible in all views. Only parts of the taller residential building will reveal itself as the views move from north to south. The commercial building and the lower floors of the taller residential building will be largely screened by existing trees located in the adjacent Maygrove Park.

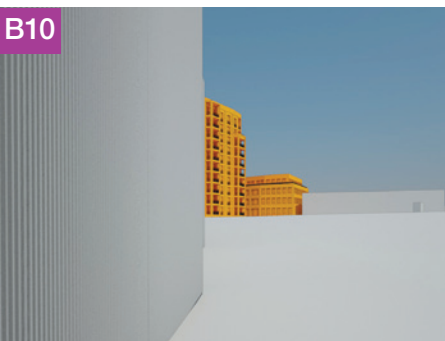

Sumatra Road

Sequential Views, Sumatra Road, western side of the street.

The top floors (maximum two floors) of the residential terrace will be visible in the background sitting behind the residential terrace that backs onto the railway line to the south in views A1 to A8. The development disappears from view A9 onwards due to the topography/ slope of the street and the position of the existing residential terrace fronting onto Sumatra Road to the south.

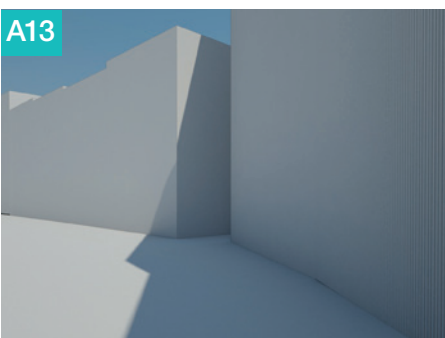
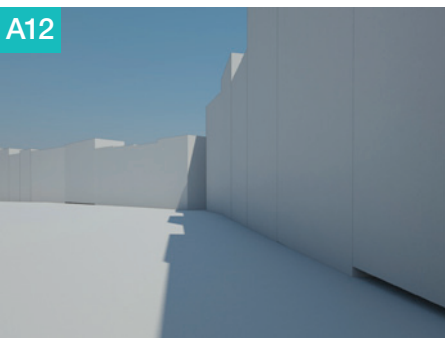
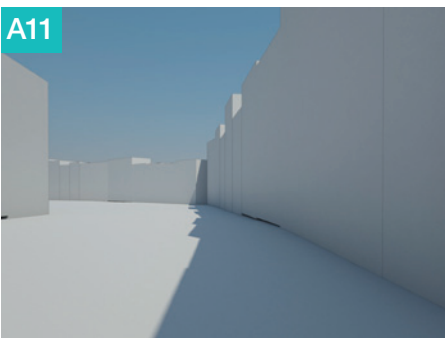
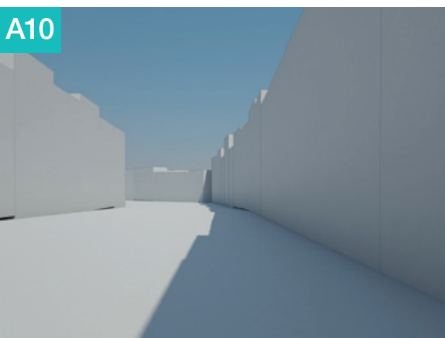
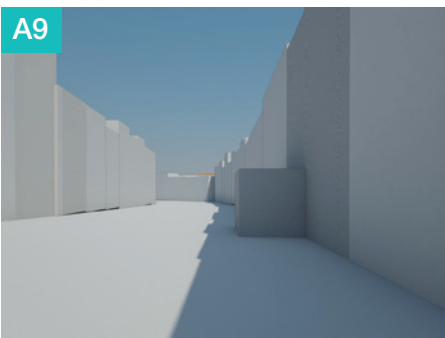

Sumatra Road

Sequential Views, Sumatra Road, eastern side of the street

The upper floors of the taller residential building and the upper floor of the residential terrace will be visible in the background to views B1 to B7. From B8 onwards the residential terrace will disappear and only the top two floors of the taller residential building will be visible in the background to these views and at distances in excess of 100 metres.

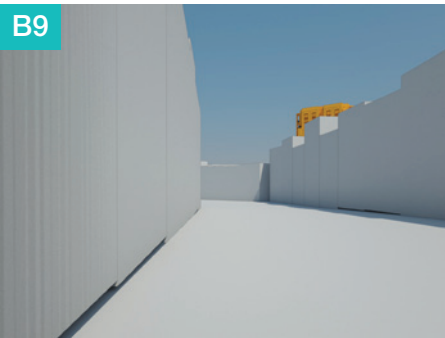
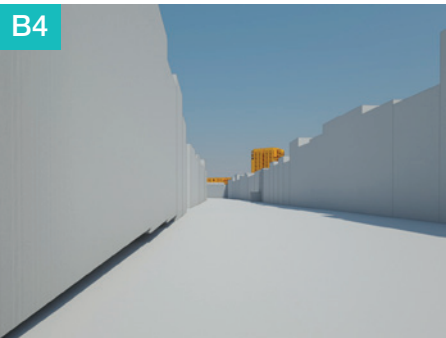

Pandora Road

Sequential Views, Pandora Road, northern side of street

The upper floors of the tower will be visible in the background to views A1 to A6. However as the views move southwards and the topography falls the proposed buildings will disappear.

