

Closely knit & continuous shrub & plant finishes of a consistent height, density & colour  
 80mm biodiverse growing medium  
 25mm high impact polystyrene drainage layer/  
 125 g/m<sup>2</sup> thermally strengthened polypropylene filter membrane

Root barrier bituminous membrane  
 'L'-shaped metal edge retention trim  
 Vegetation barrier in rounded washed stones  
 160mm rigid extruded polystyrene insulation  
 Hot melt rubberised bitumen membrane  
 Reinforced concrete roof slab

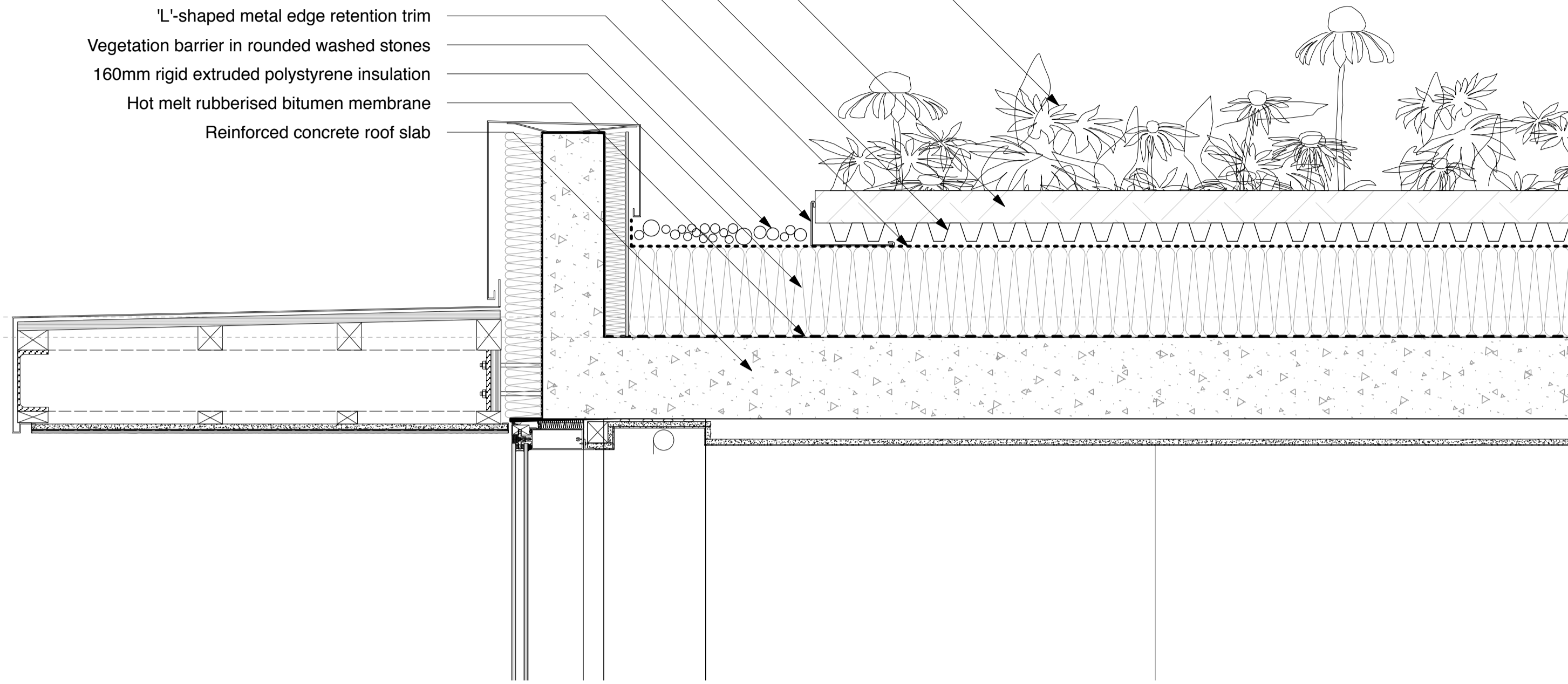

**Biodiverse (Extensive) Green Roof**  
 Typical Buildup (1:10)



**Landscape Key:**

- Areas of green roof
- Habitat boxes

**GENERAL NOTES:**  
 All dimensions to be checked on site prior to commencement of any works, and/or preparation of any shop drawings.  
 Sizes of and dimensions to any structural elements are indicative only. See structural engineers drawings for actual sizes / dimensions.  
 Sizes of and dimensions to any service elements are indicative only. See service engineers drawings for actual sizes and dimensions.  
 This drawing to be read in conjunction with all other Architect's drawings, specifications and other Consultants' information.  
 All proprietary systems shown on this drawing are to be installed strictly in accordance with the Manufacturers/Suppliers recommended details.  
 Any discrepancies between information shown on this drawing and any other contract information or manufacturers/suppliers recommendations is to be brought to the attention of the Architect.  
**DO NOT SCALE FROM THIS DRAWING.**

**DRAWING NOTES:**

P4	Landscape & green roof detail added	15.04.14							
P3	Planning amendments submission	16.12.13							
P2	Post-planning changes	20.02.13							
P1	PLANNING AMENDMENTS	29.11.12							
STATUS	REVISION	DATE							

<b>DRAWING PROPOSED PLAN</b>	
<b>Roof</b>	
SCALE <b>1:200 @ A1</b> <b>(1:400 @ A3)</b>	DRAWING FILE REF <b>770_GA_Plans_DESIGN</b>
DATE <b>Dec 2011</b>	DRAWN BY <b>BJ</b>
DWG No. <b>770_PL_10</b>	REVISION <b>P4</b>
DRAWING STATUS <b>PLANNING</b>	

<b>Buckley Gray Yeoman</b>	
Studio 4.04 The Tea Building 56 Shoreditch High Street London E1 6JJ T: 020 7033 9913 F: 020 7033 9914	
CLIENT	<b>London &amp; Regional Properties</b>
PROJECT	<b>St. George's Court</b>

Information contained on this drawing is the sole copyright of Buckley Gray Yeoman and is not to be reproduced without their permission.