

EXISTING FROGNAL GARDENS STREET
ELEVATION WITH PEDESTRIAN GATE
1:50@A1

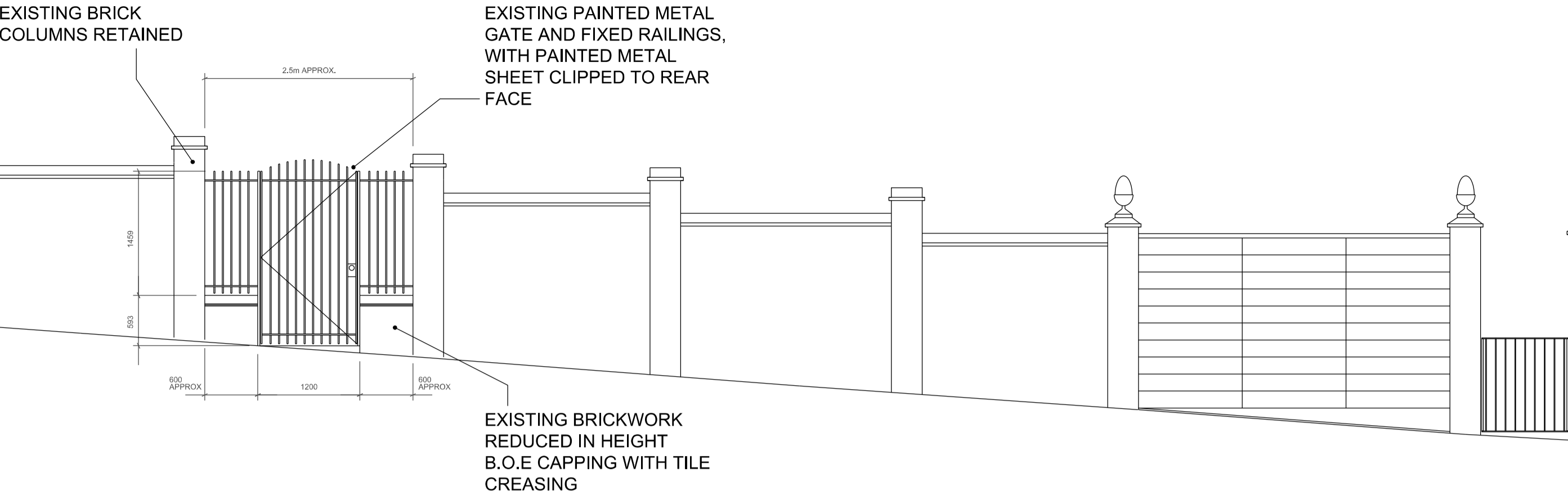

EXISTING SITE PLAN
1:100@A1

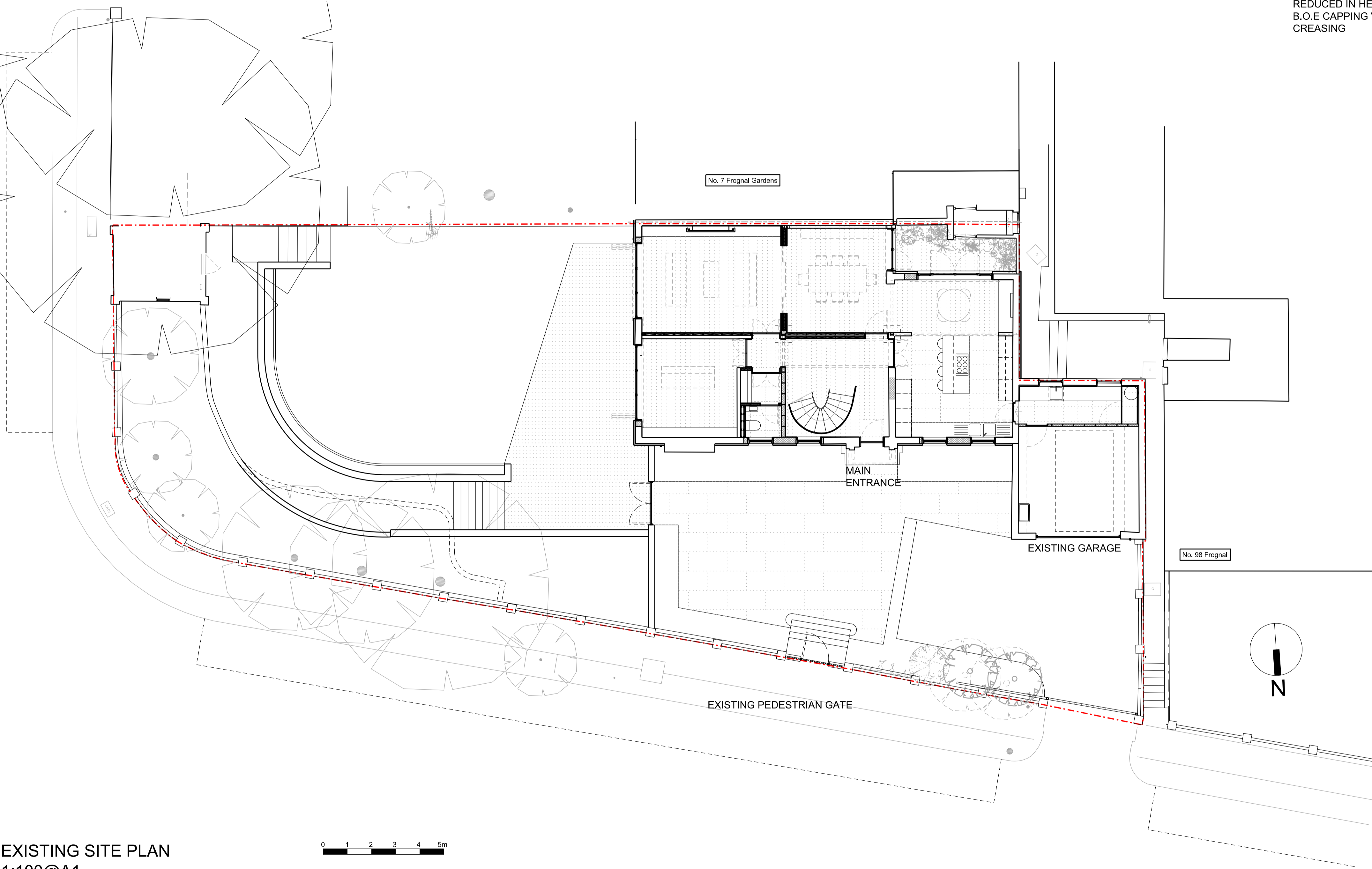

D L A

DAVID LONG ARCHITECTS LTD
Architecture and Development Management

Unit 1, 10A Ellingfort Road
LONDON E8 3PA
Tel: +44(0) 208 533 5555
fax: +44(0) 208 533 6055
e-mail: dlong@dlatd.com
www.dlatd.com

NOTES:

1. DO NOT SCALE
2. ALL DIMENSIONS ARE IN METRES OR MILLIMETRES UNLESS NOTED OTHERWISE
3. ALL DISCREPANCIES TO BE NOTIFIED TO THE ARCHITECT IMMEDIATELY
4. ALL CONSTRUCTION WORK TO COMPLY WITH LOCAL AUTHORITY CODES AND BUILDING REGULATIONS, BRITISH STANDARDS AND OTHER REGULATIONS APPLICABLE TO BOTH DESIGN AND EXECUTION OF THE WORK.

CLIENT:

Mrs Varshika Manji,
4 Woodland Terrace,
Twyford Avenue,
LONDON
N2 9NF

STRUCTURAL ENGINEERS:

IAN LEVETT
EDWARD PARSELY ASSOCIATES
WEST END BARN, THE STREET,
RAYNE, BRAINTREE,
ESSEX CM77 6RY
T: 01376 349929
E: ian.spa@btconnect.com

BUILDING SERVICE ENGINEERS:

QUANTITY SURVEYOR:

PLANNING SUPERVISOR:

ISSUE RECORD

rv.	date	comment	by	ch
-	16.10.12	Issued for Planning	by	
A	10.12.12	NEW PEDESTRIAN ENTRANCE GATE AMENDED	by	
B	20.01.14	NEW TIMBER MAIN GATE ADDED	by	
C	05.12.14	RETROSPECTIVE PLANNING APPLICATION	DL	

PROJECT:

Refurbishment and External
Amendments to
9 Frognal Gardens
LONDON NW3 6UY

STATUS:

PLANNING

TITLE:

**EXISTING SITE PLAN +
STREET ELEVATION**

SCALE:
1:50/100 @ A1
1:100/200 @ A3

JOB NO:
152

DRAWING No:

P-01

REVISION:

C

ORIGINAL
PAPER SIZE:

A1