



Ordnance Survey Plan

Published 1990 - 1996

Source map scale - 1:10,000

The historical maps shown were reproduced from maps predominantly held at the scale adopted for England, Wales and Scotland in the 1840's. In 1854 the 1:2,500 scale was adopted for mapping urban areas; these maps were used to update the 1:10,560 maps. The published date given therefore is often some years later than the surveyed date. Before 1938, all OS maps were based on the Cassini Projection, with independent surveys of a single county or group of counties, giving rise to significant inaccuracies in outlying areas. In the late 1940's, a Provisional Edition was produced, which updated the 1:10,560 mapping from a number of sources. The maps appear unfinished - with all military camps and other strategic sites removed. These maps were initially overprinted with the National Grid. In 1970, the first 1:10,000 maps were produced using the Transverse Mercator Projection. The revision process continued until recently, with new editions appearing every 10 years or so for urban areas.

Map Name(s) and Date(s)

TQ28NE	TQ38NW
1996	1990
1:10,000	1:10,000
TQ28SE	TQ38SW
1991	1995
1:10,000	1:10,000

Historical Map - Slice A

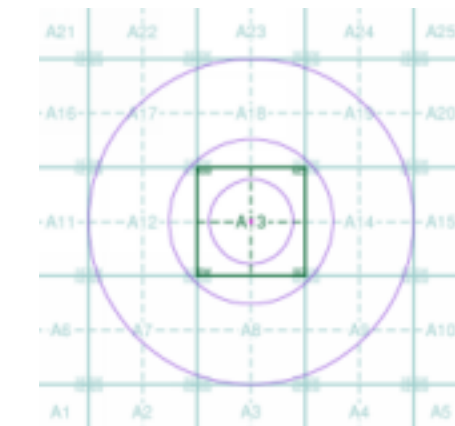

Order Details

Order Number: 62355366_1_1
 Customer Ref: Bayham Street - A090167
 National Grid Reference: 529100, 183660
 Slice: A
 Site Area (Ha): 0.02
 Search Buffer (m): 1000

Site Details

Heckscher & Co Ltd, 75 Bayham Street, LONDON, NW1 0AA



Tel: 0844 844 9952
 Fax: 0844 844 9951
 Web: www.envirocheck.co.uk



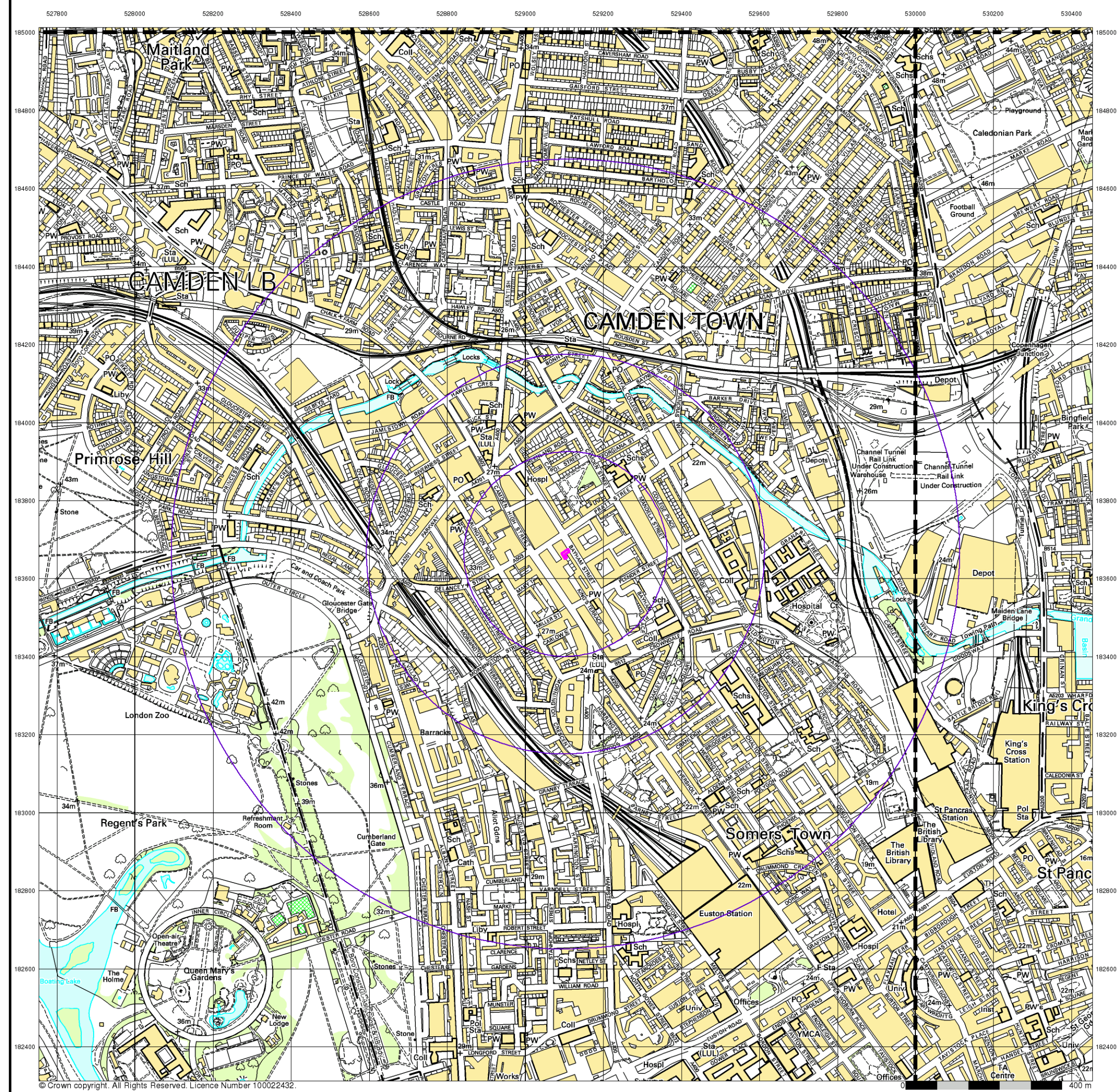

10k Raster Mapping
Published 2006
Source map scale - 1:10,000

The historical maps shown were produced from the Ordnance Survey's 1:10,000 colour raster mapping. These maps are derived from Landplan which replaced the old 1:10,000 maps originally published in 1970. The data is highly detailed showing buildings, fences and field boundaries as well as all roads, tracks and paths. Road names are also included together with the relevant road number and classification. Boundary information depiction includes county, unitary authority, district, civil parish and constituency.

Map Name(s) and Date(s)

TQ28NE	TQ38NW
2006	2006
1:10,000	1:10,000
TQ28SE	TQ38SW
2006	2006
1:10,000	1:10,000

Historical Map - Slice A

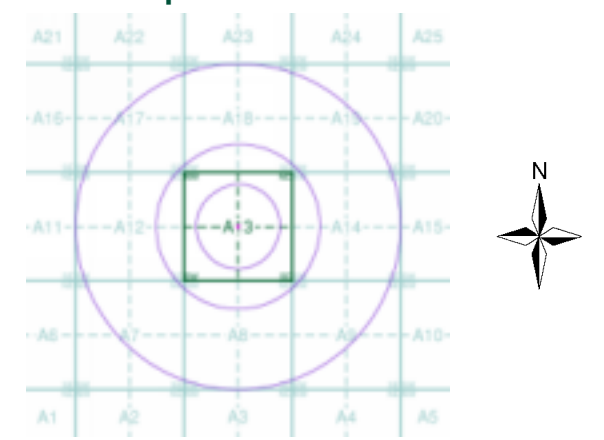

Order Details

Order Number: 62355366_1_1
 Customer Ref: Bayham Street - A090167
 National Grid Reference: 529100, 183660
 Slice: A
 Site Area (Ha): 0.02
 Search Buffer (m): 1000

Site Details

Heckscher & Co Ltd, 75 Bayham Street, LONDON, NW1 0AA



Tel: 0844 844 9952
 Fax: 0844 844 9951
 Web: www.envirocheck.co.uk

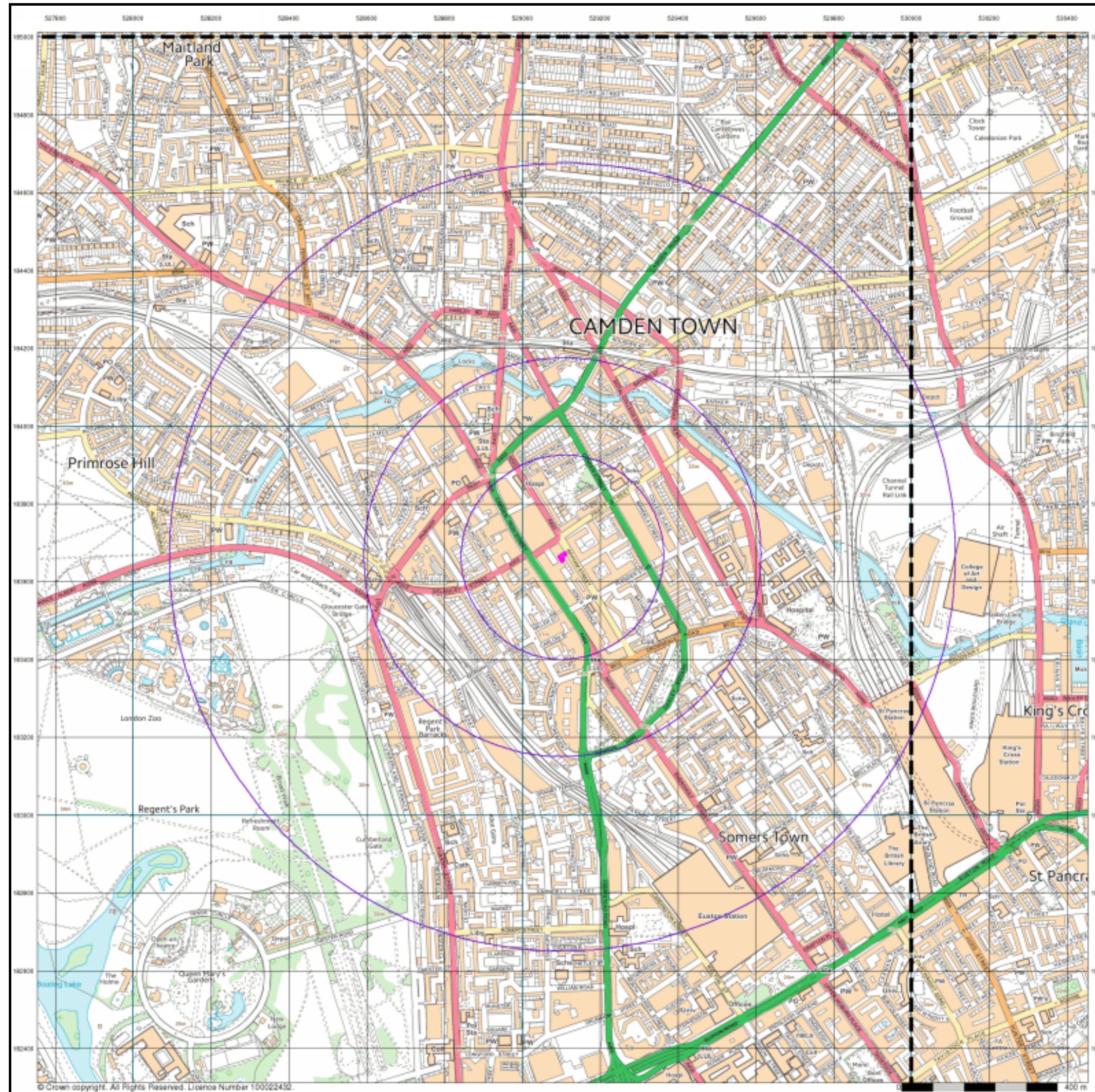

VectorMap Local
Published 2014
Source map scale - 1:10,000

VectorMap Local (Raster) is Ordnance Survey's highest detailed 'backdrop' mapping product. These maps are produced from OS's VectorMap Local, a simple vector dataset at a nominal scale of 1:10,000, covering the whole of Great Britain, that has been designed for creating graphical mapping. OS VectorMap Local is derived from large-scale information surveyed at 1:1250 scale (covering major towns and cities), 1:2500 scale (smaller towns, villages and developed rural areas), and 1:10 000 scale (mountain, moorland and river estuary areas).

Map Name(s) and Date(s)

TQ28NE 2014 Variable	TQ38NW 2014 Variable
TQ28SE 2014 Variable	TQ38SW 2014 Variable

Historical Map - Slice A

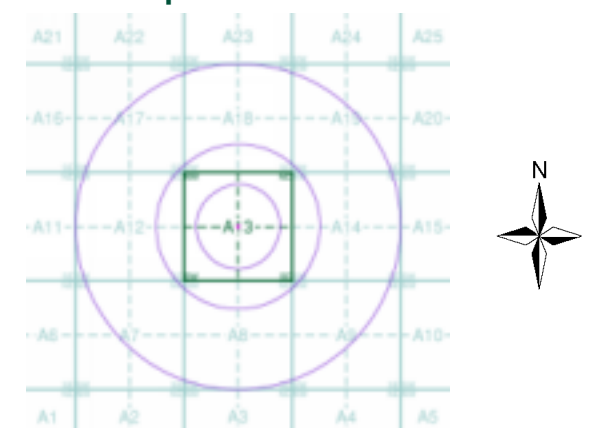

Order Details

Order Number: 62355366_1_1
 Customer Ref: Bayham Street - A090167
 National Grid Reference: 529100, 183660
 Slice: A
 Site Area (Ha): 0.02
 Search Buffer (m): 1000

Site Details

Heckscher & Co Ltd, 75 Bayham Street, LONDON, NW1 0AA



Tel: 0844 844 9952
 Fax: 0844 844 9951
 Web: www.envirocheck.co.uk

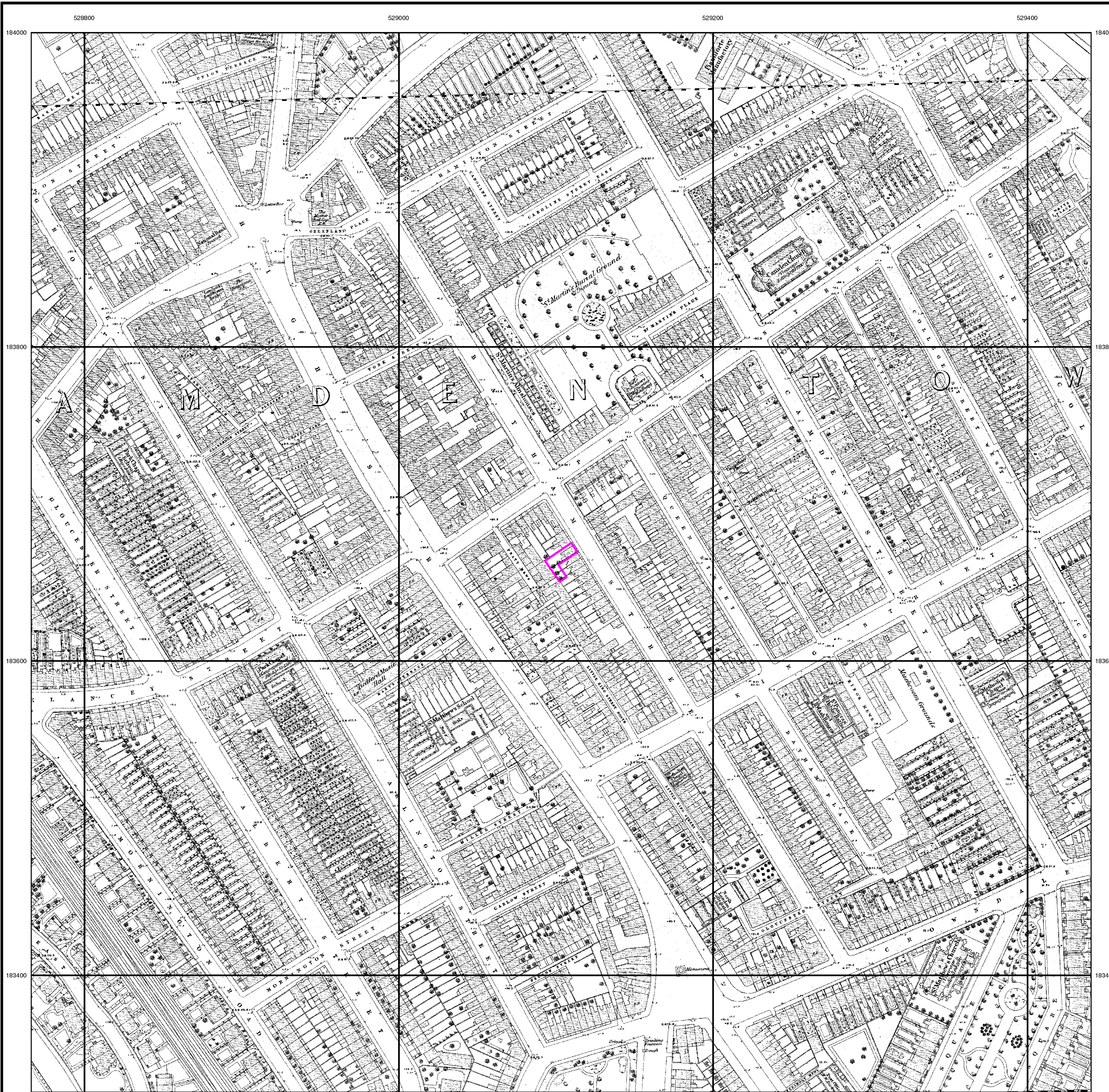

London

Published 1873

Source map scale - 1:1,056

The 1:1056 scale of Ordnance Survey mapping was adopted from Ireland in 1848 and was used to survey towns with a population of over 4000, plus county towns of lesser population, in those counties mapped at the six-inch scale in 1841-55. The scale was the largest scale at which London was mapped by the Ordnance Survey and a 'skeleton' survey of the capital, showing little more than streets, street names, frontages and altitudes, was undertaken between 1848 and 1850. The majority of the 1:1056 surveys were later replaced by 1:500 surveys; although almost all the remainder were revised at this scale, sometimes more than once before 1895. The type of detail shown on the 1:1056 scale is broadly similar to that on 1:500; the apparent omission of minor details such as sewer access points and street lights may be as much a reflection of the generally earlier date of these plans, as of the specification of the map.

Please note: Due to the partial coverage of Historical Town Plans, it is possible that not all segments within an order will contain mapping. Only the segments that have Town Plan coverage will be generated.

Map Name(s) and Date(s)

007_00_012
1873
1:1,056
007_00_022
1873
1:1,056
007_00_032
1873
1:1,056

Historical Town Plan - Segment A13

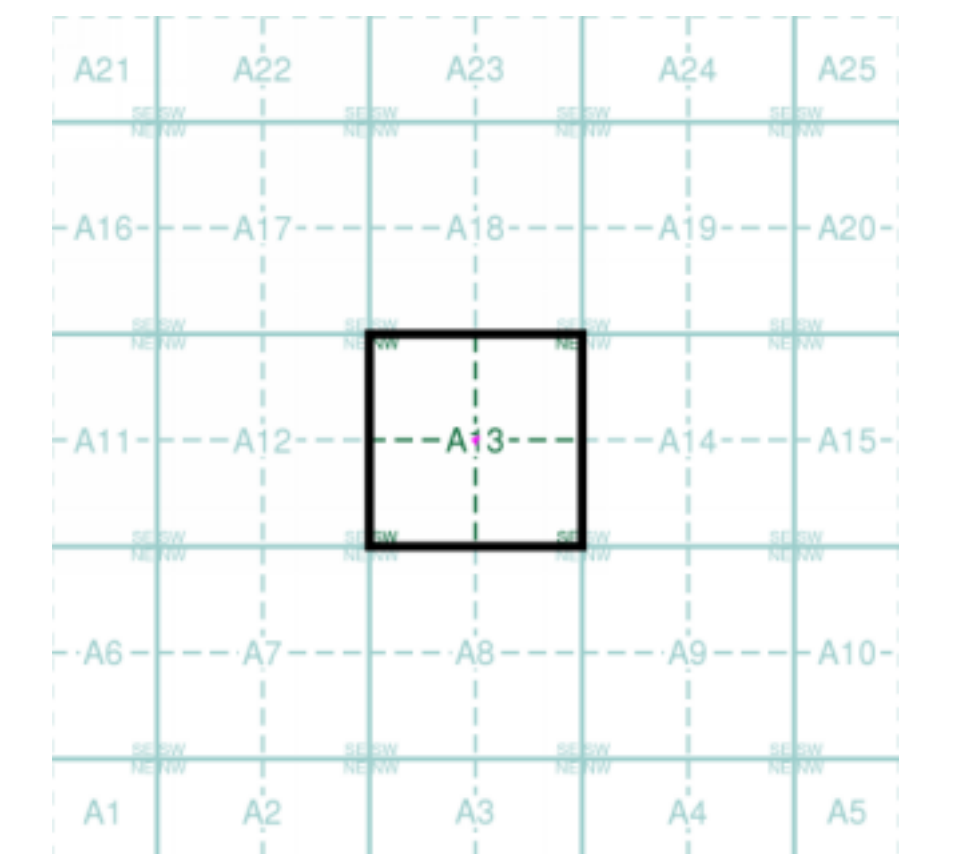

Order Details

Order Number: 62355366_1_1
Customer Ref: Bayham Street - A090167
National Grid Reference: 529100, 183660
Slice: A
Site Area (Ha): 0.02
Search Buffer (m): 0

Site Details

Heckscher & Co Ltd, 75 Bayham Street, LONDON, NW1 0AA



Tel: 0844 844 9952
Fax: 0844 844 9951
Web: www.envirocheck.co.uk

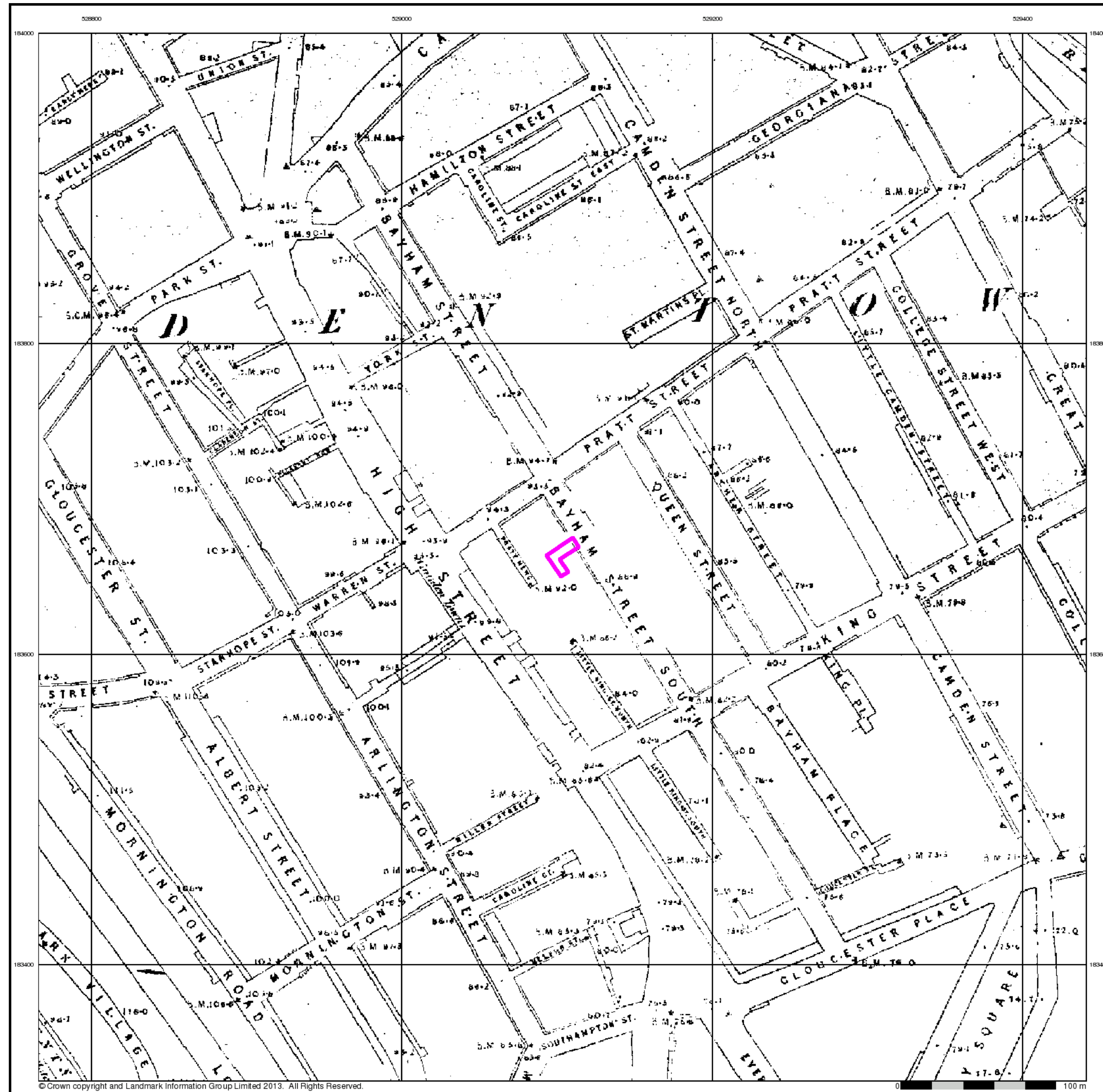

London
Published 1851
Source map scale - 1:5,280

The historical town plans shown derive from Ordnance Survey mapping from the early to mid 1850s. The 1:2640 scale was introduced in the early 1850s, to survey districts covered by the Local Boards of Health and for a map of the Osborne Estate of Queen Victoria. The general style is similar to that of the early 1:2500s published shortly afterwards. 1:5280 scale was surveyed shortly afterwards in the mid 1850s as general purpose mapping with a standard of content similar to the more contemporary 1:10,560 mapping. The scale was also used for a reduction of the 1:1056 'skeleton survey' of London that was undertaken between 1848 and 1850.

Please note: Due to the partial coverage of Historical Town Plans, it is possible that not all segments within an order will contain mapping. Only the segments that have Town Plan coverage will be generated.

Map Name(s) and Date(s)

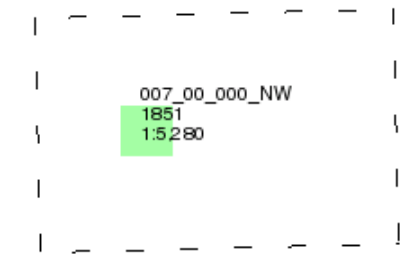

Historical Town Plan - Segment A13

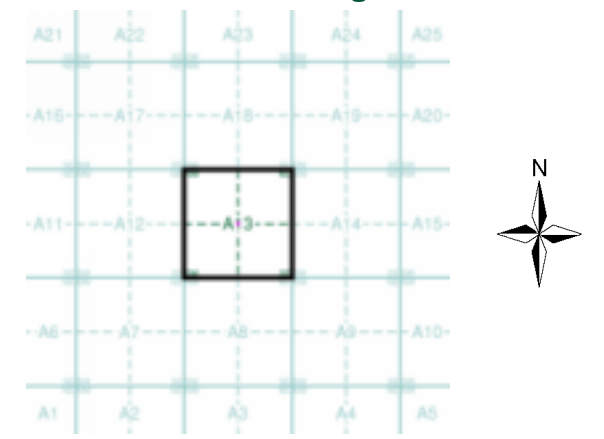

Order Details

Order Number: 62355366_1_1
 Customer Ref: Bayham Street - A090167
 National Grid Reference: 529100, 183660
 Slice: A
 Site Area (Ha): 0.02
 Search Buffer (m): 0

Site Details

Heckscher & Co Ltd, 75 Bayham Street, LONDON, NW1 0AA



Tel: 0844 844 9952
 Fax: 0844 844 9951
 Web: www.envirocheck.co.uk

APPENDIX C
SITE PHOTOGRAPHS



Photo 01: Facade



Photo 02: Inside View of Facade



Photo 03: Internal View of Extension

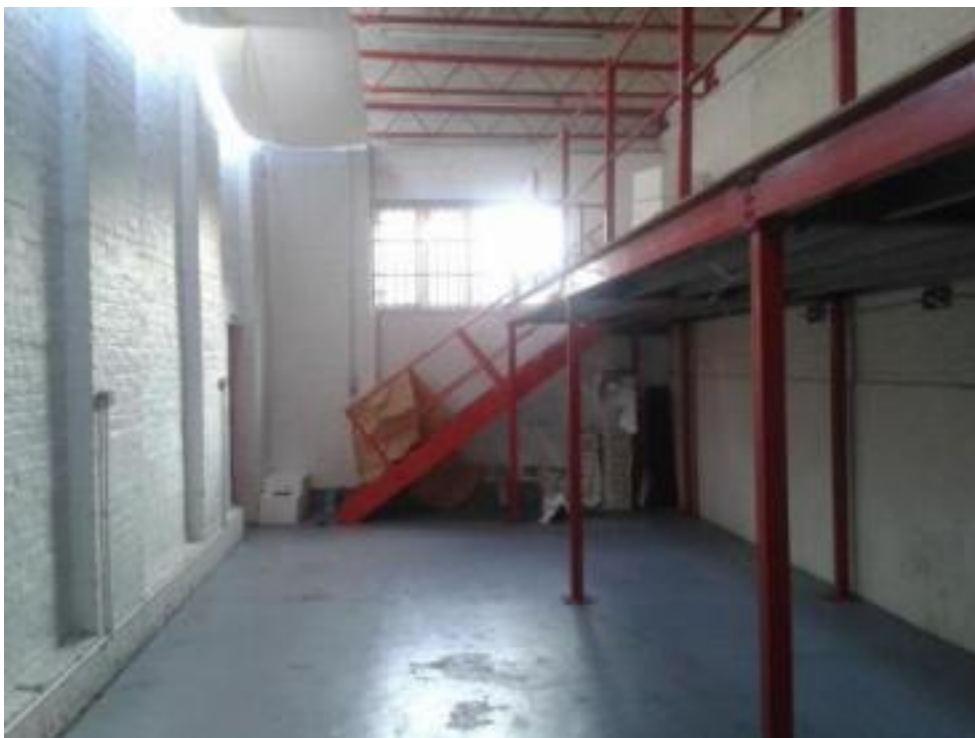

Photo 04: Mezzanine



Photo 05: Kitchenette on First Floor