

ELEVATION AA

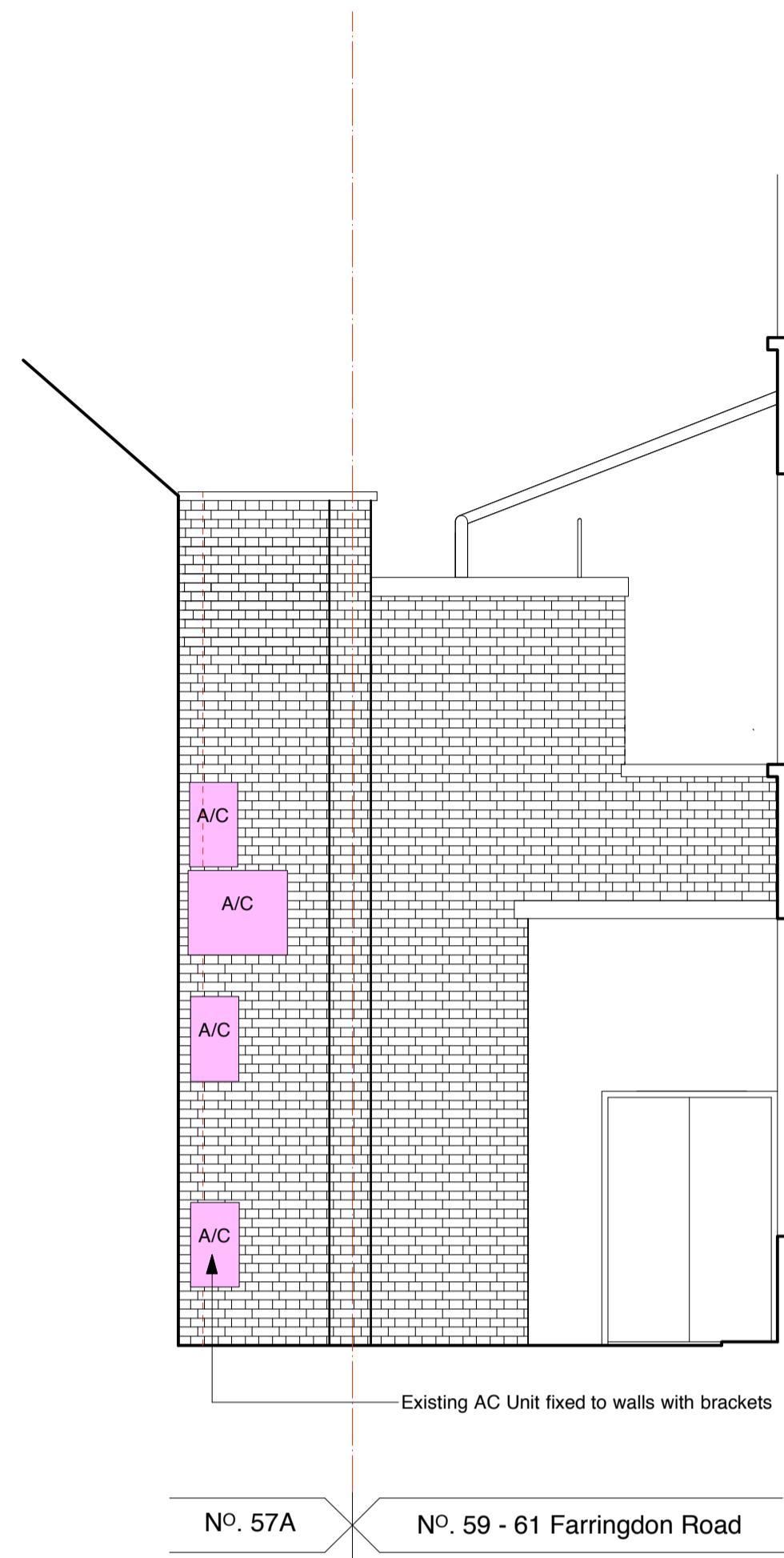

ELEVATION BB

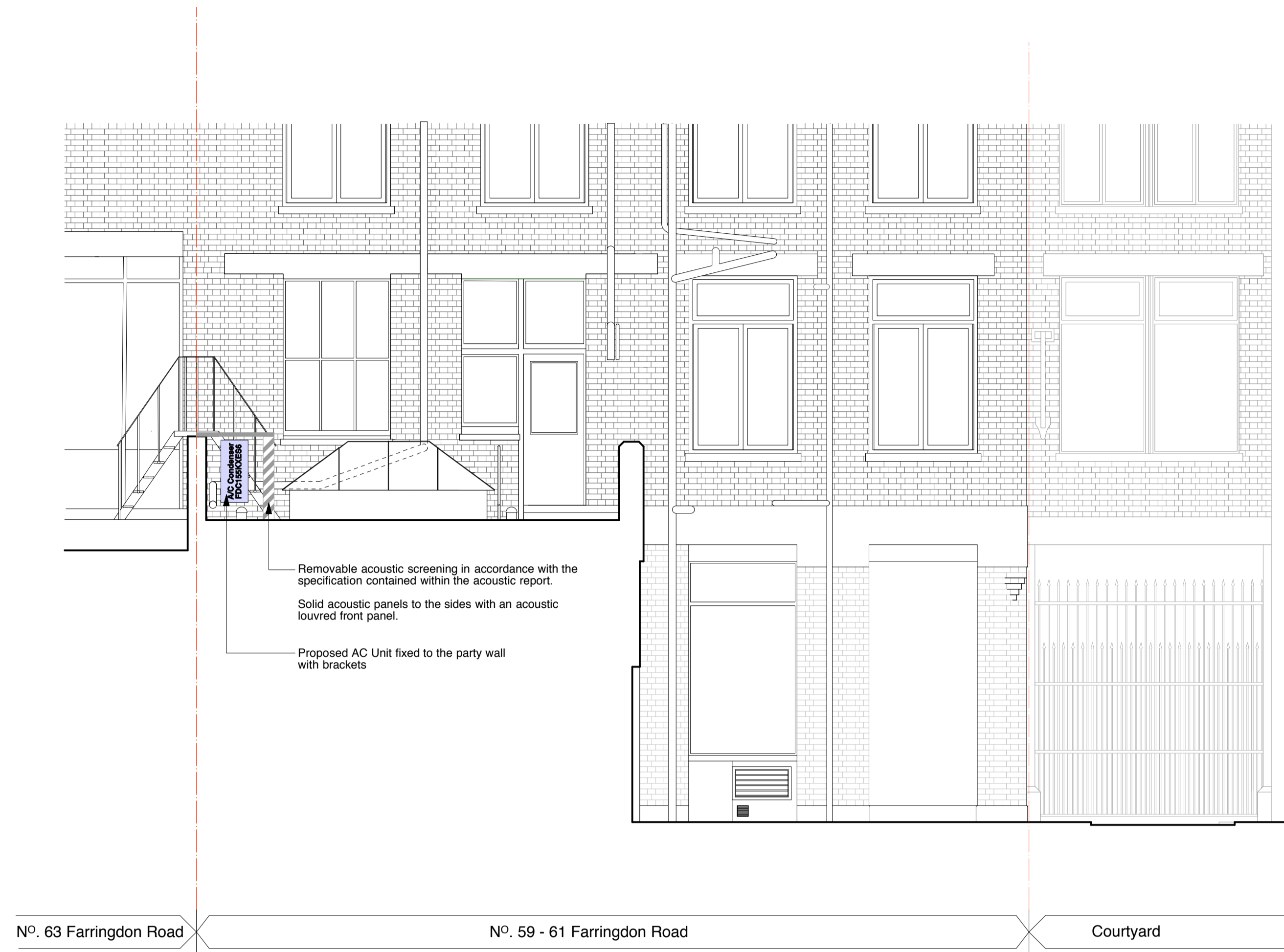

ELEVATION CC

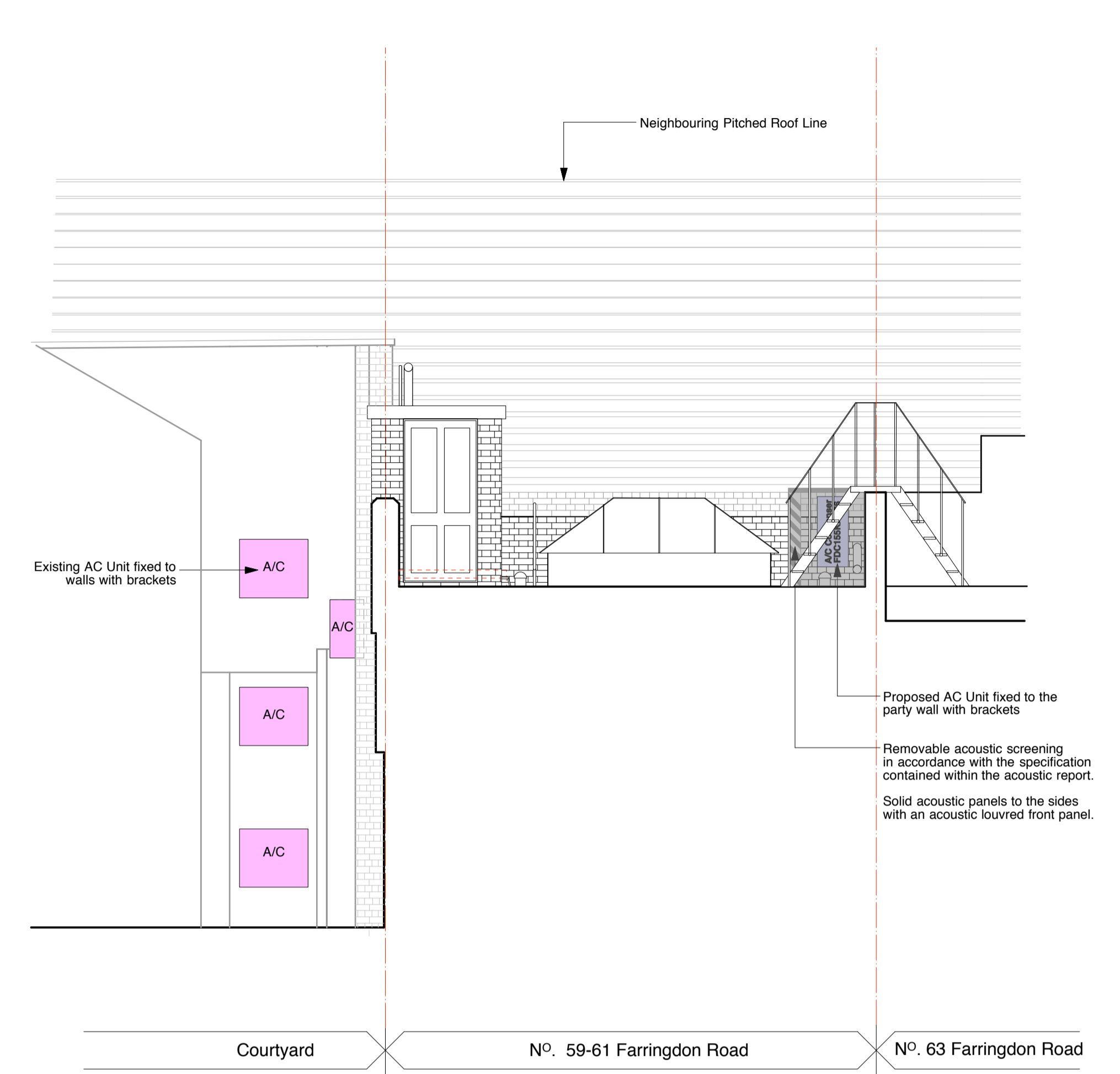

PARTIAL PLAN

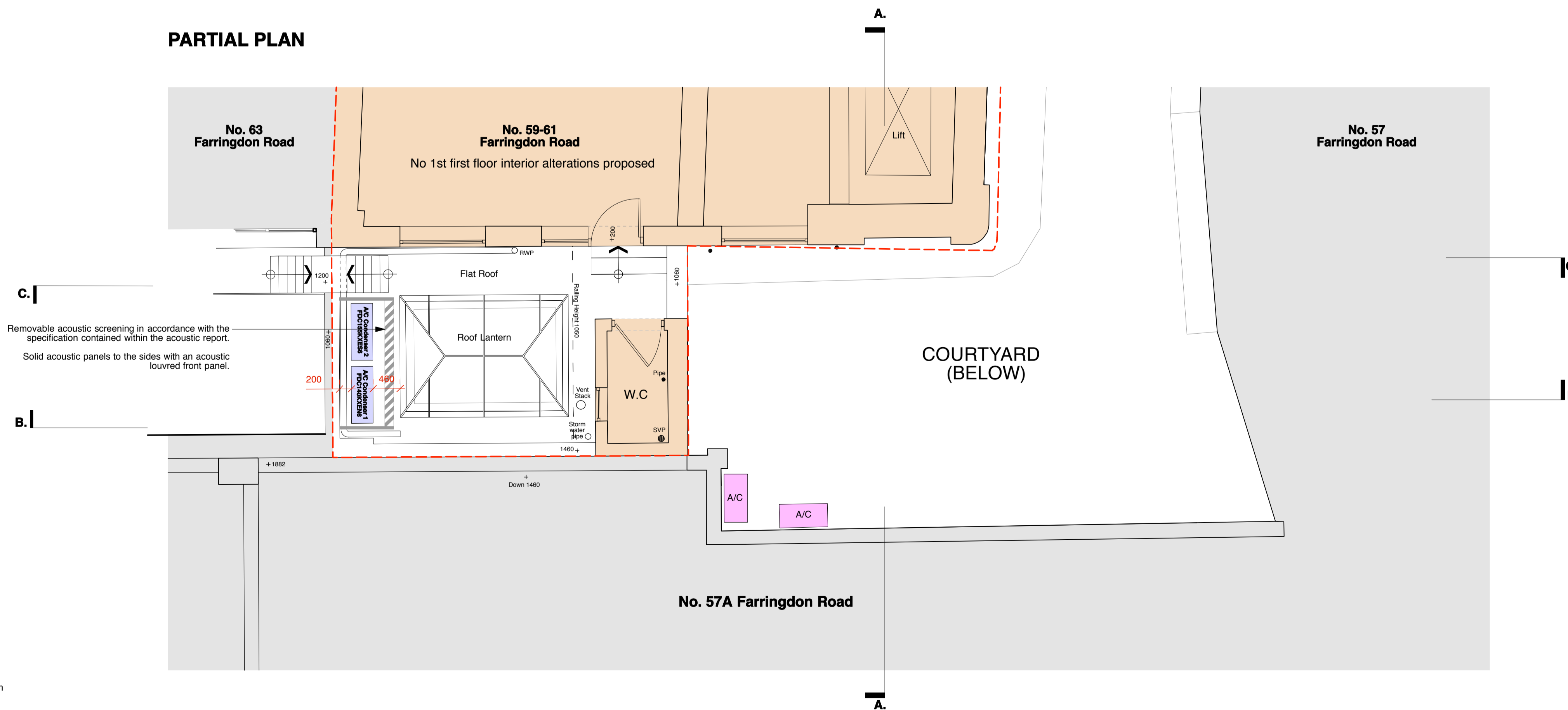

Legend

- Existing A/C Units Belonging to Neighbouring properties
- Proposed A/C Unit to 59-61 Farringdon Road

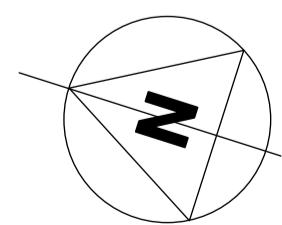

PROPOSED ELEVATIONS & PARTIAL PLAN

rev	date	notes
gpad architecture & interior design		
CLIENT KENRIGHT PROPERTIES LTD		
PROJECT ZEPPELIN BUILDING 59-61 FARRINGTON ROAD LONDON EC1M 3JB		
TITLE PROPOSED ELEVATIONS & PARTIAL PLAN		
DWG NO 398C-PA.07	REV	
DRAWN BY J.W / JE	SCALE 1:50@A1	
CHECKED BY	DATE November 2014	
T: 020 7549 2133 F: 020 7549 2144 E: info@gpadid.com		Unit 1 9a Dollington Street Clerkenwell London EC1V 0BQ
<small>This drawing is the copyright of gpad ltd. Not to be reproduced, returned or disclosed to any unauthorised person without written permission. Do not scale this drawing. All indicated dimensions to be checked and verified on site by the contractor before commencement of any fabrication drawings or work whatsoever on site. Report any discrepancies to the Architect immediately. Drawings to be read in conjunction with relevant drawings and specification.</small>		
FILE NAME	PRINT SIZE	A1