

OUTLINE SCOPE OF WORKS

PHASE 1

- B49 Lobby**
- New external door installed in modified opening.
 - Provide new plasterboard partition (K10/125) and door in arched opening.
 - Make good any damaged existing exposed flooring (assumed terrazzo).
 - Existing coved skirting retained and made good where necessary.
 - Provide new entrance matting (N10/302) to be laid over existing terrazzo flooring.
 - Existing lighting switching modified to suit new layout.
 - Repaint walls and ceiling (M60/110).

B48 Store / New Shop Offices

- Existing carpet and skirting retained, provide new threshold strip to door.
- Dado trunking retained.
- Radiator and panel concealing ducts retained.
- Provide new plasterboard partition (K10/125) and door.
- New partition in arched opening (K10/125).
- Lighting and ceiling fans retained in existing location.
- Repaint walls and ceiling (M60/110).

PHASE 2

Shop office currently occupying B40, B41A & B42 relocated to B48 to enable works to this area.

B40, B41A & B42 New Catering Offices

- Install new D/I/15 doorset.
- Install retained meeting room doorset as D/I/16.
- Provide new independent lining (K10/155) to separate B41A and B41.
- Existing carpet and skirting retained.
- Dado trunking retained and modified to suit new openings.
- Radiator and panel concealing ducts retained.
- Lighting and ceiling fans retained in existing location.
- Repaint walls and ceiling (M60/110).

PHASE 3

B41, B43, B45 Existing Offices.

- Refurbish all windows.
- Apply opaque film (L10/212) to inside face of windows W/17 & W/18.
- Provide new fire lining to 2no. window openings W/17 & W/18.
- Provide new ventilation grille to W/17 & W/18.
- Form new man hole.
- Provide 4no. stub stacks with drainages runs to new man hole.
- Retain existing stub stack and drainage route adjacent to existing kitchenette.
- Retain and make good all existing floor finishes, skirting, lighting, ceiling fans and dado trunking.
- Install 2no. fan units as indicated on MEP drawings.

B46/B47 Kitchenette, Printing and Lockers

- Refurbish window (M60/130).
- Apply opaque film (L10/212) to inside face of windows W/19
- Provide new fire lining to 2no. window openings W/19
- Make good any damaged existing exposed flooring (assumed terrazzo).
- Provide new low level independent wall lining (K10/155) to end of kitchenette units below existing panel and ductwork.
- Provide 30no. locker units (N10/220)
- Install kitchenette (N11)
- Position of existing B46 radiator below end panels adjusted to sit centred between linings. Pipework adjusted to suit.
- Linear ventilation grille adjusted to suit new partitions.
- Dado trunking retained adjacent to printers. New connections made where required around new openings.

B44 Staff Showers and WCs

- Provide new partitions and laminate screens to form WC / Shower Cubicles.
- Provide sanitary fittings as set out in specification (N13).

BEYOND
 HWSF - HOT WATER SERVICE FROM
 HWSR - HOT WATER SERVICE RETURN
 MWS - MAINS COLD WATER SERVICE
 CWS - COLD WATER DRAIN SERVICE
 HL - HIGH LEVEL
 LL - LOW LEVEL.

NOTES!
 1. ALL PIPEWORK WILL BE COPOLYMER
 TUBE FULLY INSULATED
 PIPEWORK IN AREA SUBJECT
 TO FROST WILL BE ELECTRICAL
 TRAILING HEATED

3. THE CONTRACTOR WILL
 DETERMINE ON SITE
 CONNECTION POINT TO
 EXISTING INSTALLATION
 AT THE NEAREST SUITABLE
 FIRE SUPPLY. FOR TOWER
 ALLOW ADDITIONAL
 30M OF PIPEWORK RUN.
 FOR EACH SERVICE

4. HOT WATER RETURN WILL
 BE FITTED WITH DOUBLE
 REGULATING VALVES.

150 MWS AT HL
 200 CWS AT HL
 200 HWS F AT HL
 220 HWS R AT HL.

LEFT TO RIGHT.
 150 HWS F AT HL TO LL
 150 HWS R AT LL TO HL
 150 MWS AT HL TO LL

150 HWS F & CWS TO
 TO SHOWER MIXER

PIPEWORK IN
 STORE AT HL

TOP TO BOTTOM
 220 HWS F AT HL TO LL
 150 HWS R AT LL TO HL
 200 CWS AT HL TO LL

EXISTING SINK &
 SERVICE TO BE
 RETAINED

SEE NOTES

BDP.

JOB TITLE:
UCL WTLR ENABLING WORKS .3

DRAWING TITLE:
**DOMESTIC WATER SERVICES
 HIGH LEVEL**

SCALE: **NTS**
 CREATED BY: **KMF**
 DATE: **APRIL 2014**

JOB No: **P200 5528** DRAWING NUMBER: **SCH-P-53-01** REVISION: **—**

Revision	Date	Amendment	Notes
T1	11.04.14	Tender Issue	Site area

0 5 10 metres

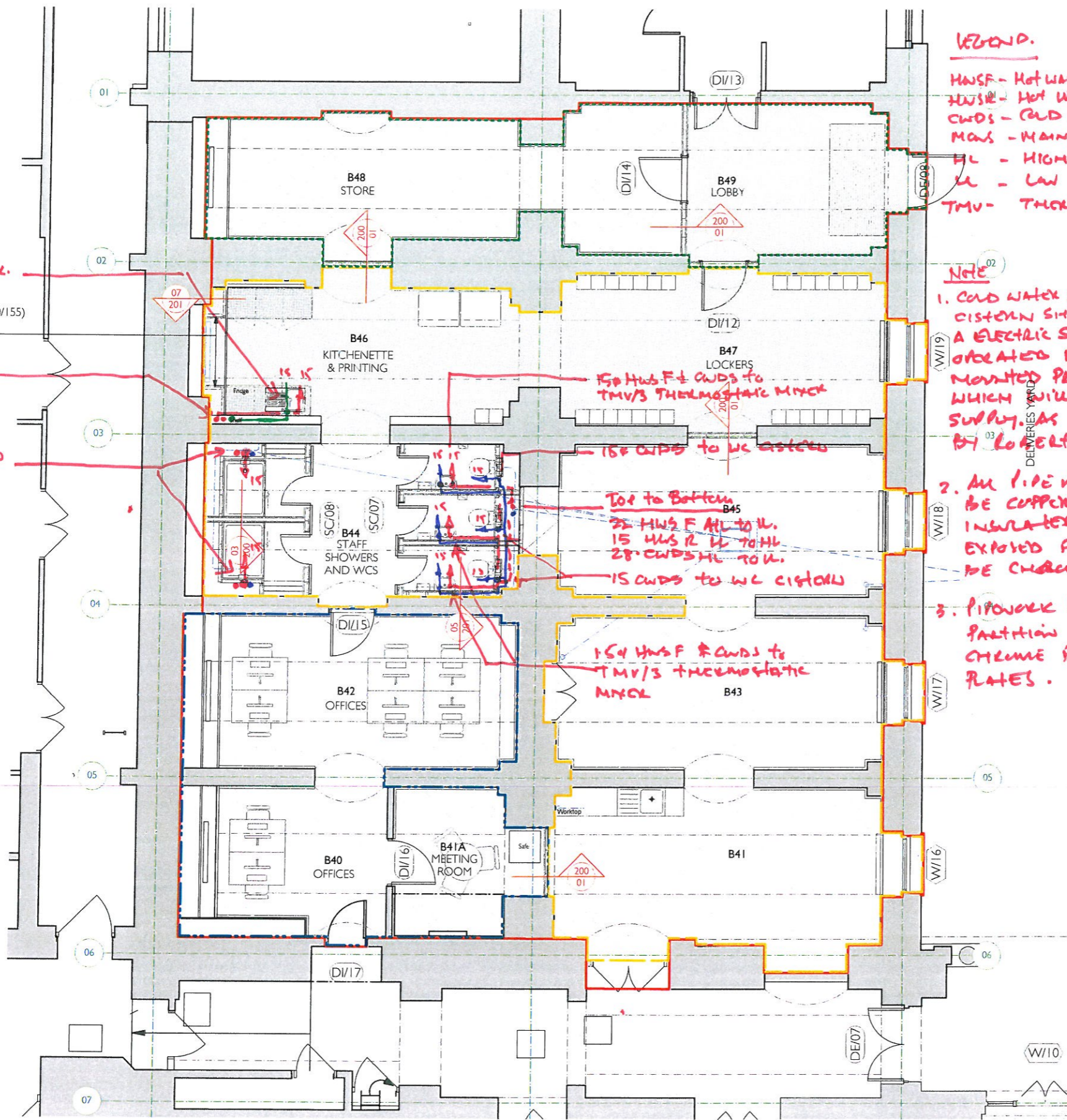

LEGEND.

- HWSF - Hot Water Service Flow
- HWSR - Hot Water Service Return
- CWDs - Cold Water Drain Service
- MWS - Mains Cold Water Service
- HL - HIGH LEVEL
- LL - LOW LEVEL.
- TMV - THERMOSTATIC MIXER VALVE.

OUTLINE SCOPE OF WORKS

PHASE I

- B49 Lobby**
- New external door installed in modified opening.
 - Provide new plasterboard partition (K10/125) and door in arched opening.
 - Make good any damaged existing exposed flooring (assumed terrazzo).
 - Existing coved skirting retained and made good where necessary.
 - Provide new entrance matting (N10/302) to be laid over existing terrazzo flooring.
 - Existing lighting switching modified to suit new layout.
 - Repaint walls and ceiling (M60/110).

- B48 Store / New Shop Offices**
- Existing carpet and skirting retained, provide new threshold strip to door.
 - Dado trunking retained.
 - Radiator and panel concealing ducts retained.
 - Provide new plasterboard partition (K10/125) and door.
 - New partition in arched opening (K10/125).
 - Lighting and ceiling fans retained in existing location
 - Repaint walls and ceiling (M60/110).

PHASE 2

- Shop office currently occupying B40, B41A & B42 relocated to B48 to enable works to this area.

- B40, B41A & B42 New Catering Offices**
- Install new DI/15 doorset
 - Install retained meeting room doorset as DI/16.
 - Provide new independent lining (K10/155) to separate B41A and B41.
 - Existing carpet and skirting retained.
 - Dado trunking retained and modified to suit new openings.
 - Radiator and panel concealing ducts retained.
 - Lighting and ceiling fans retained in existing location
 - Repaint walls and ceiling (M60/110).

PHASE 3

- B41, B43, B45 Existing Offices.**
- Refurbish all windows.
 - Apply opaque film (L10/212) to inside face of windows W/17 & W/18.
 - Provide new fire lining to 2no. window openings W/17 & W/18.
 - Provide new ventilation grille to W/17 & W/18.
 - Form new man hole.
 - Provide 4no. stub stacks with drainages runs to new man hole.
 - Retain existing stub stack and drainage route adjacent to existing kitchenette.
 - Retain and make good all existing floor finishes, skirting, lighting, ceiling fans and dado trunking.
 - Install 2no. fan units as indicated on MEP drawings.

- B46/B47 Kitchenette, Printing and Lockers**
- Refurbish window (M60/130).
 - Apply opaque film (L10/212) to inside face of windows W/19
 - Provide new fire lining to 2no. window openings W/19
 - Make good any damaged existing exposed flooring (assumed terrazzo).
 - Provide new low level independent wall lining (K10/155) to end of kitchenette units below existing panel and ductwork.
 - Provide 30no. locker units (N10/220)
 - Install kitchenette (N11)
 - Position of existing B46 radiator below end panels adjusted to sit centred between linings. Pipework adjusted to suit.
 - Linear ventilation grille adjusted to suit new partitions.
 - Dado trunking retained adjacent to printers. New connections made where required around new openings.

- B44 Staff Showers and WCs**
- Provide new partitions and laminate screens to form WC / Shower Cubicles.
 - Provide sanitary fittings as set out in specification (N13).

NOTE

1. COLD WATER SUPPLY TO WC CISTERN SHALL IN CORRELATE A ELECTRIC SOLENOID VALVE OPERATED BY A CONTACT MOUNTED PRESENCE DETECTOR WHICH WILL OPEN & CLOSE SUPPLY AS MANUFACTURE BY LOVELL PEARSON E.C.

2. ALL PIPE WORK WILL BE COPPER TUBE FULLY INSULATED WHERE EXPOSED PIPEWORK WILL BE CHROME PLATE.

3. PIPEWORK EXISTING WALLS / PARTITION WILL HAVE CHROME PLATE COVER PLATES.

150 HWSF & MWS to Sink.

WFT to B101
150 HWSF HL to U
150 HWSR LL to HL
150 MWS HL TO U

150 HWSF & CWDs HL to U TO SERVE TMV/3 SHOWER MIXER

150 HWSF & CWDs to TMV/3 THERMOSTATIC MIXER

150 CWDs to WC CISTERN

Top to Bottom

28 HWSF HL to U.
15 HWSR LL to HL
28 CWDs HL to U.

15 CWDs to WC CISTERN

150 HWSF & CWDs to TMV/3 THERMOSTATIC MIXER

Independent wall lining (K10/155) below existing panels

BDP.

JOB TITLE:
UCL WTLR ENABLING WORKS 3

DRAWING TITLE:
DOMESTIC WATER SERVICES LOW LEVEL

JOB NO: **2005828** DRAWING NUMBER: **3CH-P-S3-04** SCALE: **MTS.** CREATED BY: **KHF** DATE: **APRIL 2014**

Revision	Date	Amendment	Notes
T1	11.04.14	Tender Issue	Site area



- LEGEND**
- HWS F - HOT WATER SERVICE FLOW
 - HWS R - HOT WATER SERVICE RETURN
 - CWDS - COLD WATER DOWN SERVICE
 - MCS - MAINS COLD WATER SERVICE
 - BV - BALL VALVE
 - FR - FLOW RESTRICTOR
 - NRV - NONE RETURN VALVE
 - DOC - DRAIN OFF COCK
 - DRV - DOUBLE REGULATING VALVE
 - TMV - THERMOSTATIC MIXER VALVE
 - MSCV - MOTORIZED SHUT OFF VALVE
 - IRD - INFRARED DETECTOR
- NOTE**
1. Flow restrictors = WHB = 6L/M
= SHOWER = 9L/M
= SINK = 9L/M

CONNECT TO EXISTING TO BE DETERMINED ON SITE

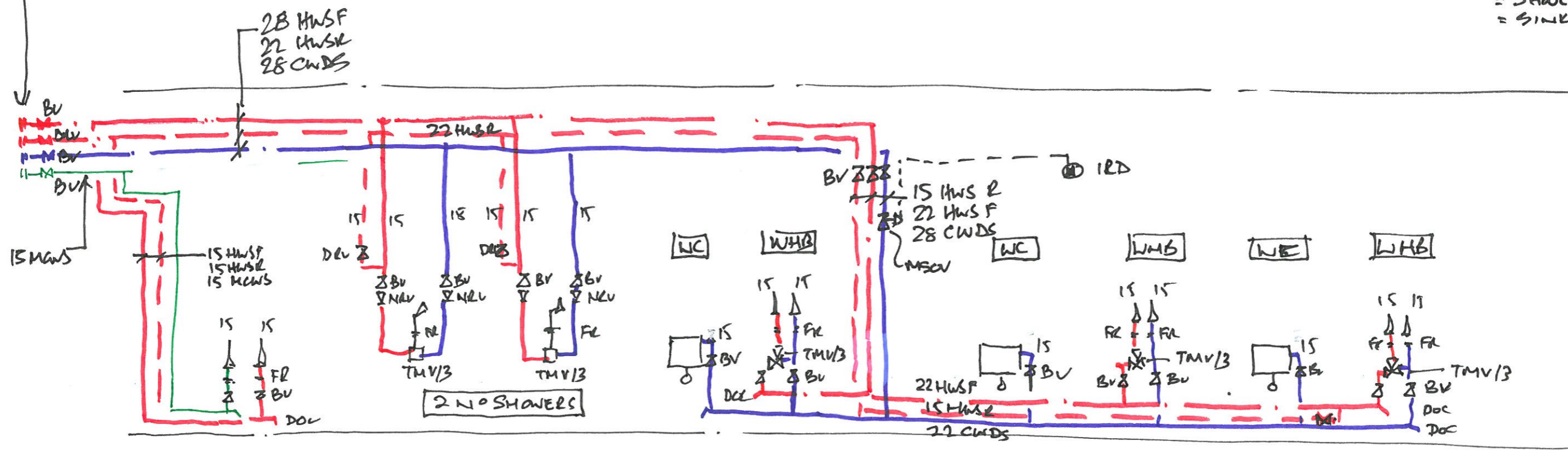

REVISION / DESCRIPTION	DRAWN	CHECKED	DATE	REVISION / DESCRIPTION	DRAWN	CHECKED	DATE	REVISION / DESCRIPTION	DRAWN	CHECKED	DATE
FIRST ISSUE											

16 Brewhouse Yard
Clerkenwell
London EC1V 4LJ
United Kingdom
T +44 (0)20 7812 8000
F +44 (0)20 7812 8399
www.bdp.com

BDP.

PROJECT TITLE UCL WTLR ENABLING WORKS 3	
PROJECT NUMBER	
DRAWING TITLE DOMESTIC WATER SERVICE SCHEMATIC	SCALE NYS
DRAWING NUMBER SCH-P-53-08	DATE APRIL 14
REVISION	REVISION