

# BOLTON ROAD

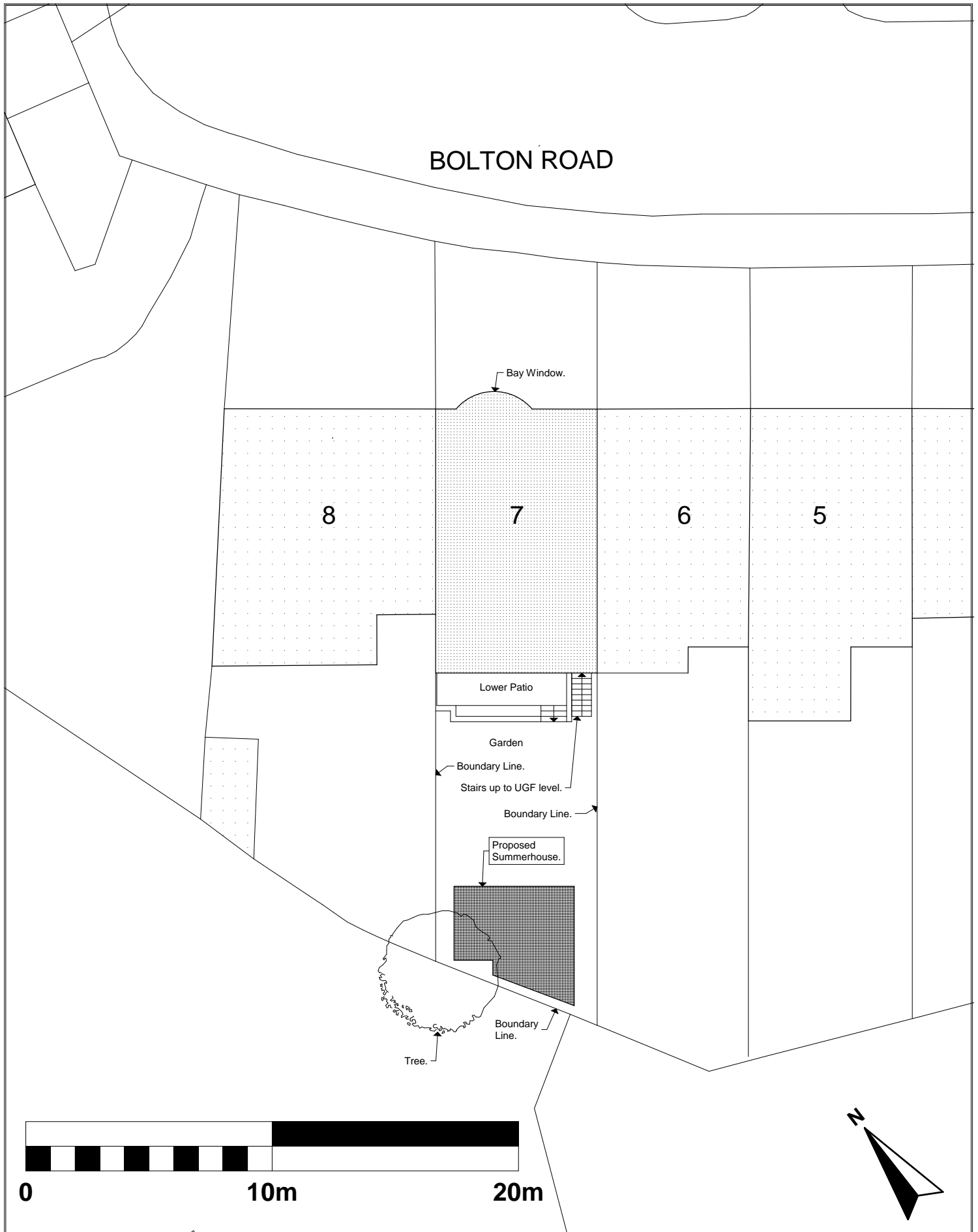

|                            |                                |                 |                         |                    |               |
|----------------------------|--------------------------------|-----------------|-------------------------|--------------------|---------------|
| Project 7A Bolton Road     |                                | Drawing size A4 | File ref: 1137AB013.pln | © Copyright        |               |
| Client Litven Limited      | Date Aug 14                    | Scale 1:200     | Preliminary Planning    | Rev A              | Date 17/11/14 |
| Drawing Proposed Site Plan | Reference Number 1137-BA-105 A | As Built        | Building Regs           | Design amendments. |               |
|                            |                                |                 | Tender                  |                    |               |
|                            |                                |                 | Construction            |                    |               |
|                            |                                |                 | As Built                |                    |               |

© Copyright

**DONALD SHEARER**  
 ARCHITECTS  
 CHARTERED ARCHITECTS

Scholar's House, Shottery Brook Office Park, Tel : 01789 294 560  
 Timothy's Bridge Road, Stratford-upon-Avon, Fax : 01789 294 549  
 Warwickshire, CV37 9NR donald@ds-architects.demon.co.uk