

Proposed new coping to curtain wall head coloured to match existing.

Proposed new thermally broken anodized aluminum curtain walling - Colour Anolok 545 Bronze

Proposed new internal floor finish.

Proposed new cill coloured to match new frames.

Proposed new external render to be applied to the existing walls - Colour RAL 1019

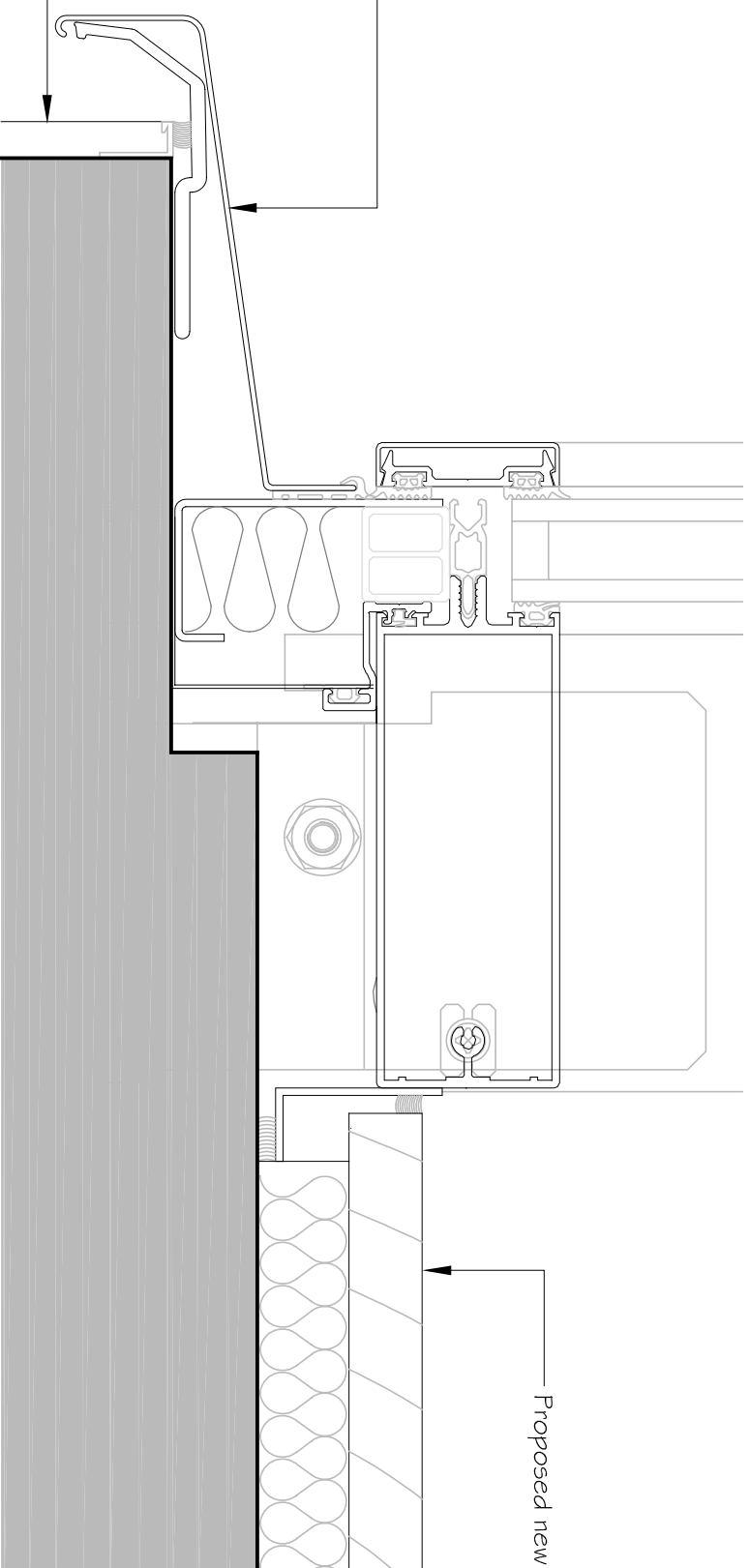

Revision	Description	Drawn	Checked	Date
Preliminary	Information	Tender	Construction	As Built

Title: Station House  
 9 - 13 Swiss Terrace  
 Detail: Proposed Curtain Wall Section

**Woods Hardwick**  
 Architects, Engineers and Development Consultants

15-17 Colindale Avenue  
 London NW9 1QH  
 T: +44 (0)20 8350 3000  
 F: +44 (0)20 8350 3004  
 www.woods-hardwick.com

Scale: 1:2 @ A3  
 Date: November 2014  
 Drawn: DC  
 Checked: CW

17304 - P03