

Date 19 November 2014  
Our Ref 20878-SI-N045  
Your Ref 2014/6672/P  
To Sally Shepherd  
Development Control  
Planning@camden.gov.uk



London Underground Limited

Hello Jonathan,

**192 Haverstock Hill, London NW3 2AJ**

Thank you for your communication of 7th November 2014.

Attached is a 1:1,250 plan @A4 showing the location of Belsize Park London Underground Station which is served by the Northern line.

**Please note:**

- shaded areas represent sub-surface structures which can be as shallow as 0.2 metres below surface level
- the positions of the tunnels on this plan are indicative only and must not be used for design purposes
- due to varying levels within underground stations it is not possible to show tunnel crown depths in the shaded area
- for more accurate tunnel location information a survey will need to be undertaken
- this letter must be distributed with the drawing which it refers to

Though we have no objection in principle to the above planning application there are a number of potential constraints on the redevelopment of a site situated close to underground tunnels and infrastructure. It will need to be demonstrated to the satisfaction of LUL engineers that:

- our right of support is not compromised
- the development will not have any detrimental effect on our structures either in the short or long term
- the design must be such that the loading imposed on our structures is not increased or removed
- we offer no right of support to the development or land

Therefore we request that the grant of planning permission be subject to conditions to secure the following:

The development hereby permitted shall not be commenced until detailed design and method statements (in consultation with London Underground) for all of the foundations, basement and ground floor structures, or for any other structures below ground level, including piling (temporary and permanent), have been submitted to and approved in writing by the local planning authority which:

- provide details on all structures
- accommodate the location of the existing London Underground structures
- demonstrate access to elevations of the building adjacent to the property boundary with London Underground can be undertaken without recourse to entering our land
- demonstrate that there will at no time be any potential security risk to our railway, property or structures
- accommodate ground movement arising from the construction thereof
- mitigate the effects of noise and vibration arising from the adjoining operations within the structures

The development shall thereafter be carried out in all respects in accordance with the approved design and method statements, and all structures and works comprised within the development hereby permitted which are required by the approved design statements in order to procure the matters mentioned in paragraphs of this condition shall be completed, in their entirety, before any part of the building hereby permitted is occupied.

**Reason:** To ensure that the development does not impact on existing London Underground transport infrastructure, in accordance with London Plan 2011 Table 6.1 and 'Land for Industry and Transport' Supplementary Planning Guidance 2012

We also ask that the following informative is added:

The applicant is advised to contact London Underground Infrastructure Protection in advance of preparation of final design and associated method statements, in particular with regard to: demolition; drainage; excavation; construction methods; security; boundary treatment; safety barriers; landscaping and lighting

Should you have any further enquiries, please do not hesitate to contact me.

Shahina Inayathusein  
Information Manager  
LUL Infrastructure Protection  
E-mail: [locationenquiries@tube.tfl.gov.uk](mailto:locationenquiries@tube.tfl.gov.uk)  
Tel: 0207 918 0016

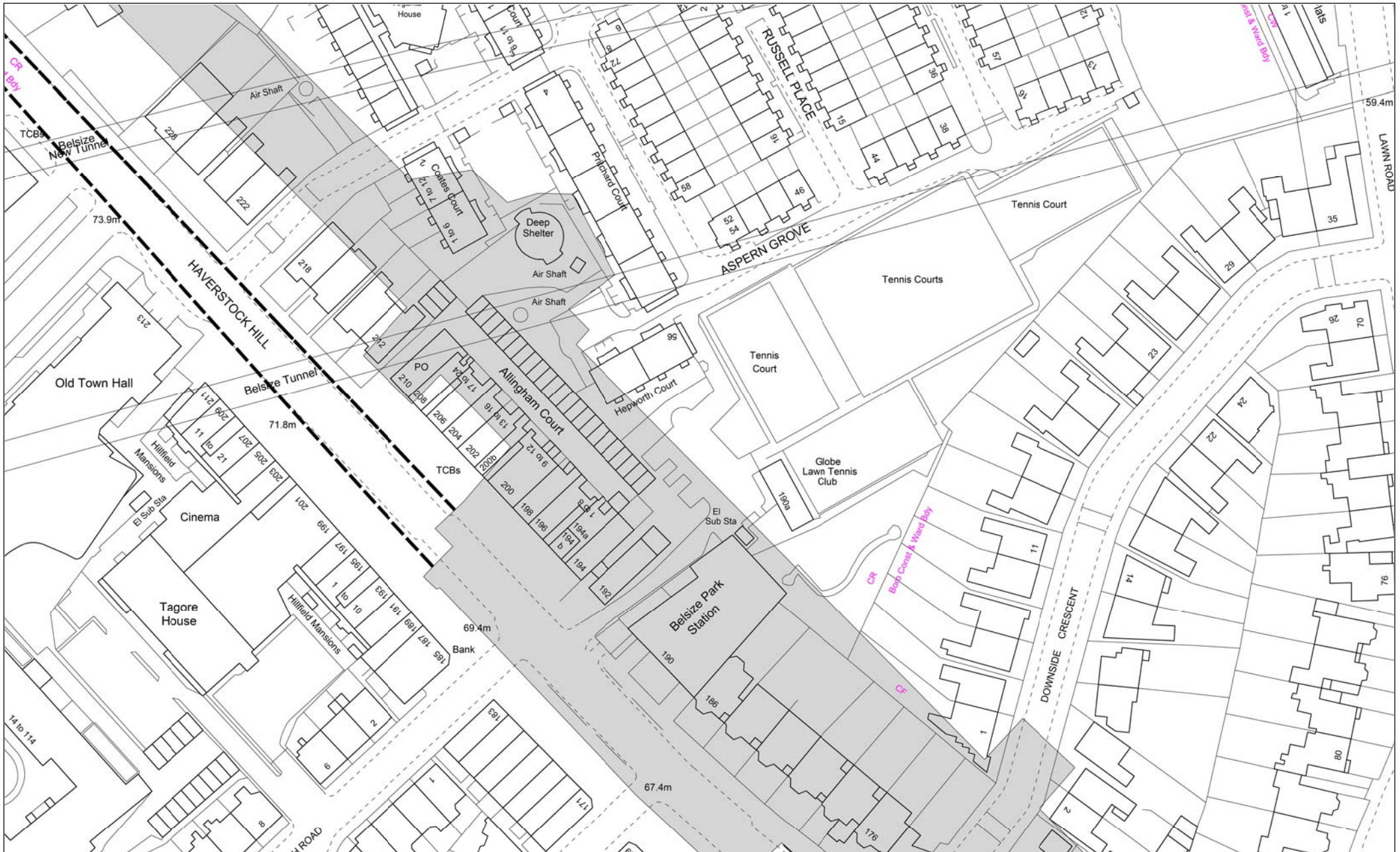

 **London Underground Limited**  
 Infrastructure Protection  
 3rd Floor Albany House, 55 Broadway,  
 London, SW1H 0BD  
 Tel: 0207 918 0016  
 (auto: 40016)  
 Email: Shahina.Inayathusein@tube.tfl.gov.uk

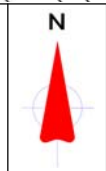

Date	09 Jul 2012
LCS Code	N045
Drawn by	S.Inayathusein
Scale	1:1250 at A4

1. All dimensions and LUL asset locations are approximate
2. This drawing must be read in conjunction with the accompanying letter sent by LUL
3. This drawing is for planning purposes only
4. For more accurate tunnel location information a survey will need to be undertaken.

192 Haverstock Hill,  
 London  
 NW3 2AJ