

USE FIGURED DIMENSIONS ONLY
DO NOT SCALE FROM THIS DRAWING.

ALL DIMENSIONS MUST BE CHECKED ON SITE ANY
INCONSISTENCIES MUST BE REPORTED BACK TO THE ARCHITECT.
THIS DRAWING AND ANY DESIGNS INDICATED THEREON ARE THE
COPYRIGHT OF BROOKS / MURRAY ARCHITECTS.
ALL RIGHTS ARE RESERVED.
NO PART OF THIS WORK MAY BE PRODUCED WITHOUT PRIOR
PERMISSION IN WRITING FROM BROOKS / MURRAY ARCHITECTS.

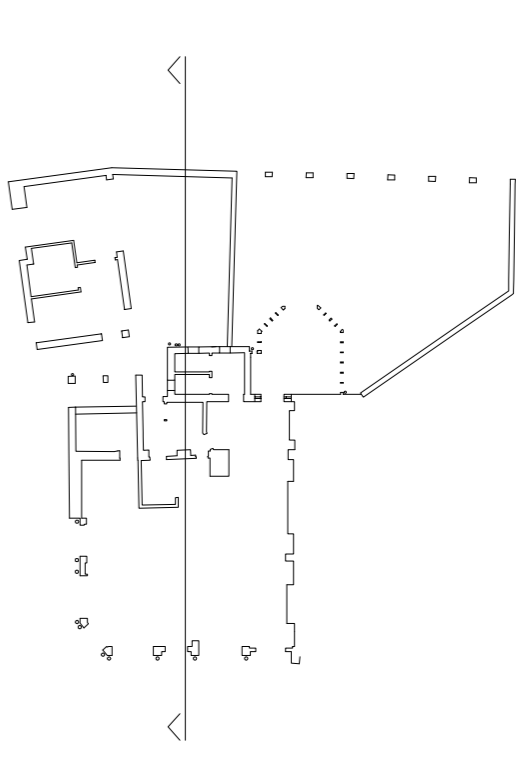

REV.	AMENDMENT	DATE
C		
B	Proposal amended	17.10.2014
A	Previous South West Elevation	23.07.2014

BROOKS / MURRAY

ARCHITECTS

8-10 NEW NORTH PLACE
LONDON EC2A 4JA

TEL 020 7739 9955
FAX 020 7739 9944

architects@brooksmurray.com

CLIENT:
Springcroft Constructions

JOB:
**11 Princess Road
Primrose Hill
London, NW1 8JR**

DATE: SCALE:
April 2014 1:100 @ A3 & 1:50 @ A1

DRAWING TITLE:
Proposed Rear Elevation

DRAWING NUMBER:
985.03 - P2 - 151 B

