

Existing Part Plan

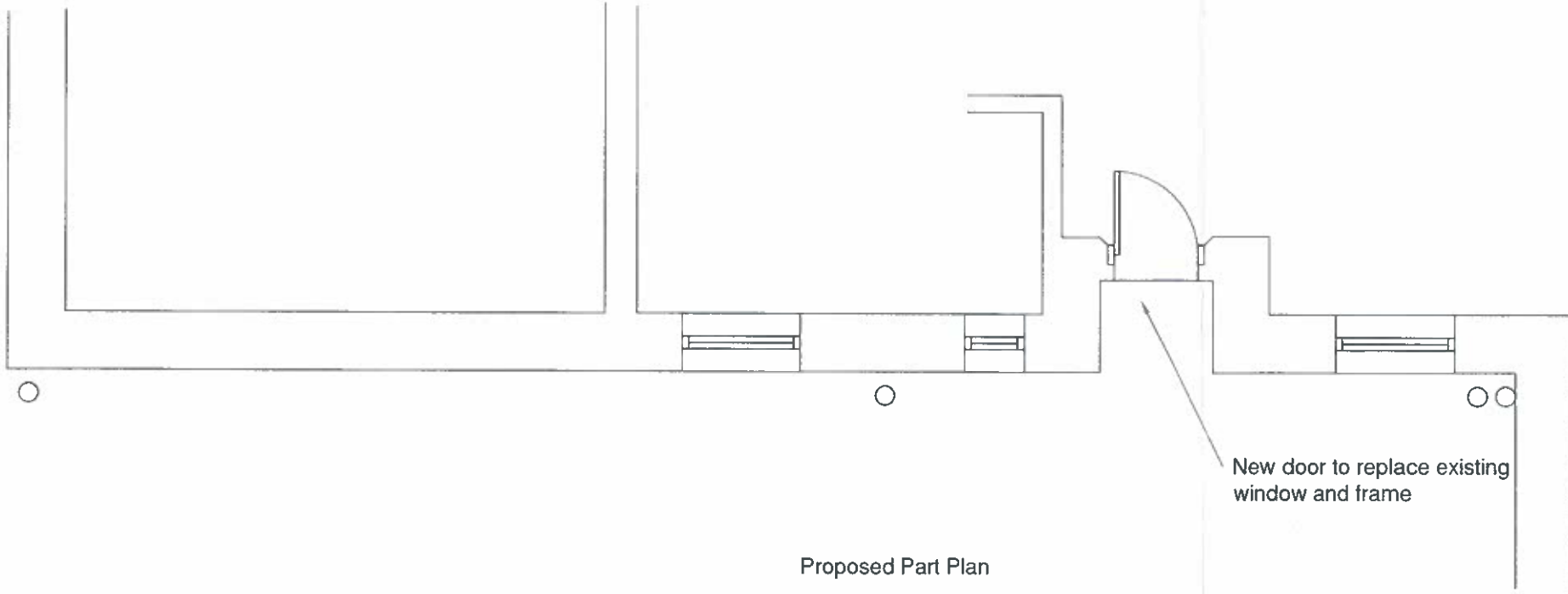

Proposed Part Plan

New door to replace existing window and frame

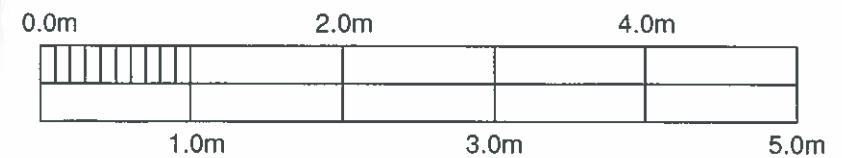

Scale Bar

**NOTES:**  
 This drawing is to be read in conjunction with all relevant Engineers and Architects drawings. Only figured dimensions are to be used, for construction, all dimensions are to be verified on site prior to work commencing.

REV	AMENDMENT	DATE

**TITLE**  
 25 Avenue Mansions  
 Finchley Road  
 London

Part Lower Ground  
 Floor Plan - Showing  
 Existing and Proposed

DATE: July 2014	SCALE: 1:50
DRAWN: RD	APPROVED:

**Glasspool & Thaiss**  
 CONSULTING STRUCTURAL ENGINEERS  
 COUGHTREY HOUSE  
 112- 116 BROAD STREET  
 CHESHAM  
 BUCKS  
 HP5 3ED  
 TELEPHONE: 01494 771314  
 FACSIMILE: 01494 791455  
 E-mail: mail@glasspoolandthaiss.com

**DRAWING STATUS**  
 PROPOSED

DRAWING No 14028/02	REV
------------------------	-----