

- Notes
1. This drawing has been prepared in accordance with the scope of RPS's appointment with its client and is subject to the terms and conditions of that appointment. RPS accepts no liability for any use of this document other than by its client and only for the purposes for which it was prepared and provided.
 2. If received electronically it is the recipient's responsibility to print to correct scale. Only written dimensions should be used.

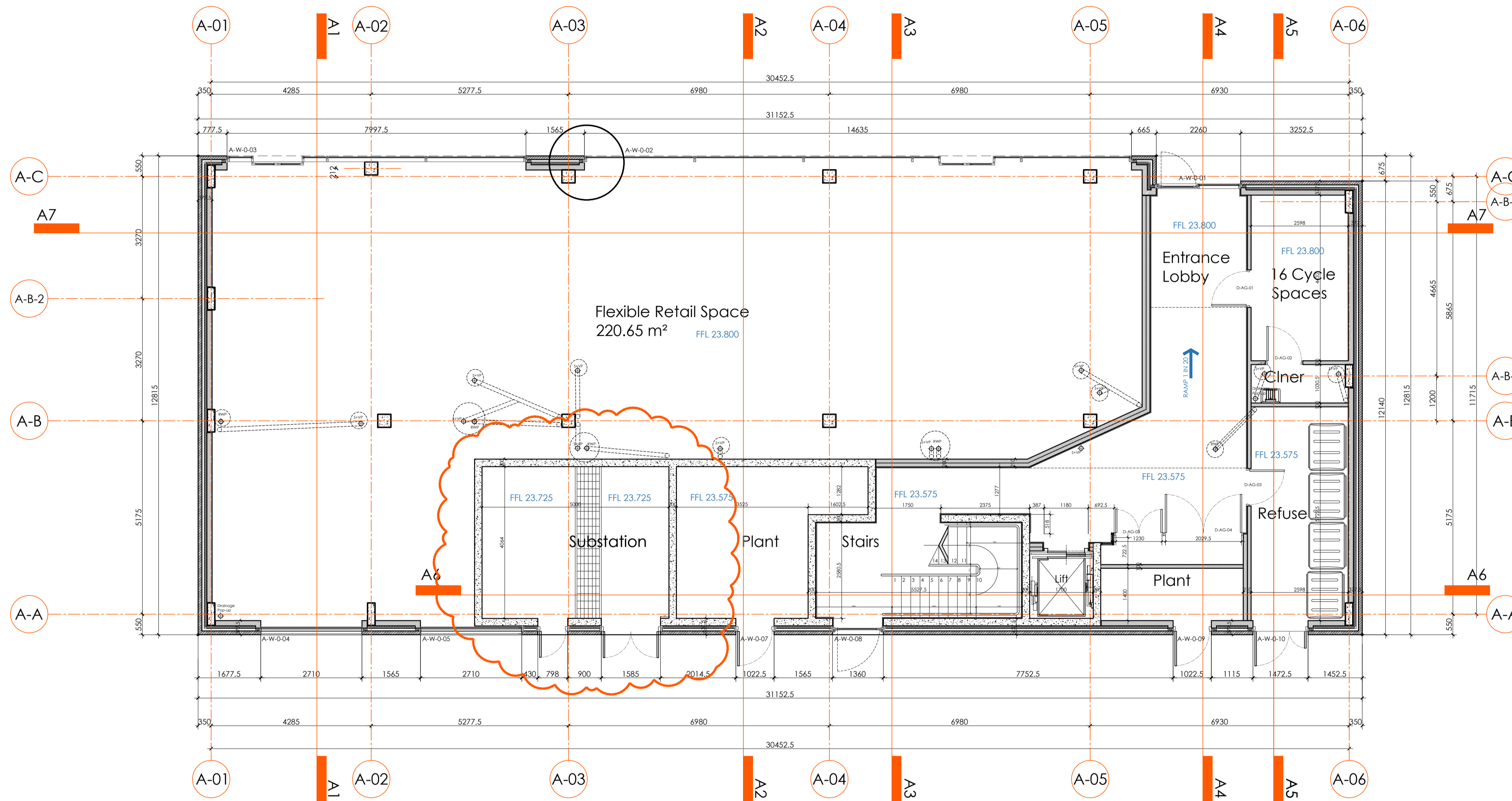

Plender A Ground Floor Plan

Rev	Description	Date	Initial	Checked
H	Substation updated to take account of UK Power Solutions details.	05.08.2014	DH	
G	Brickwork and blockwork hatching added, staircase dimensions added, drawing status amended to Construction.	22.07.2014	KDR	
F	Door references added	23.05.2014	KDR	
E	Lift shaft amended	02.05.2014	KDR	
D	Shopfront glazing and doors added	04.04.2014	KDR	
C	Staircase amended, plant area doors amended to Pinnacle requirements	24.03.2014	KDR	
B	Column positions amended, structural grid amended, cleaners store amended, floor levels adjusted to take account of Cartwright Pickard dig 634-AD-2101	04.03.2014	KDR	
A	Electricity sub station located within ground floor, column positions adjusted, grid lines adjusted to suit	13.02.2014	KDR	

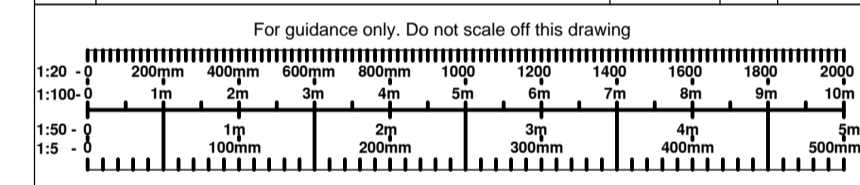

Highfield House, 5 Ridgeway
 Quinton Business Park, Birmingham B32 1AF
 T: +44(0)121 213 5500 E: rpsbm@rpsgroup.com F: +44(0)121 213 5502



Project **Plender Street
 Camden**

Title **Building A
 Ground Floor Plan
 General Arrangement**

Status	Construction	Drawn By	KDR	PM/Checked by	-
Job Ref	AAA5174	Scale @	A1 1:75	Date Created	08.01.2014

Drawing Number	A-A201	Rev	H
----------------	--------	-----	---