

Do not scale from this drawing.
Dimensions are to be verified on site prior to construction.

Notes

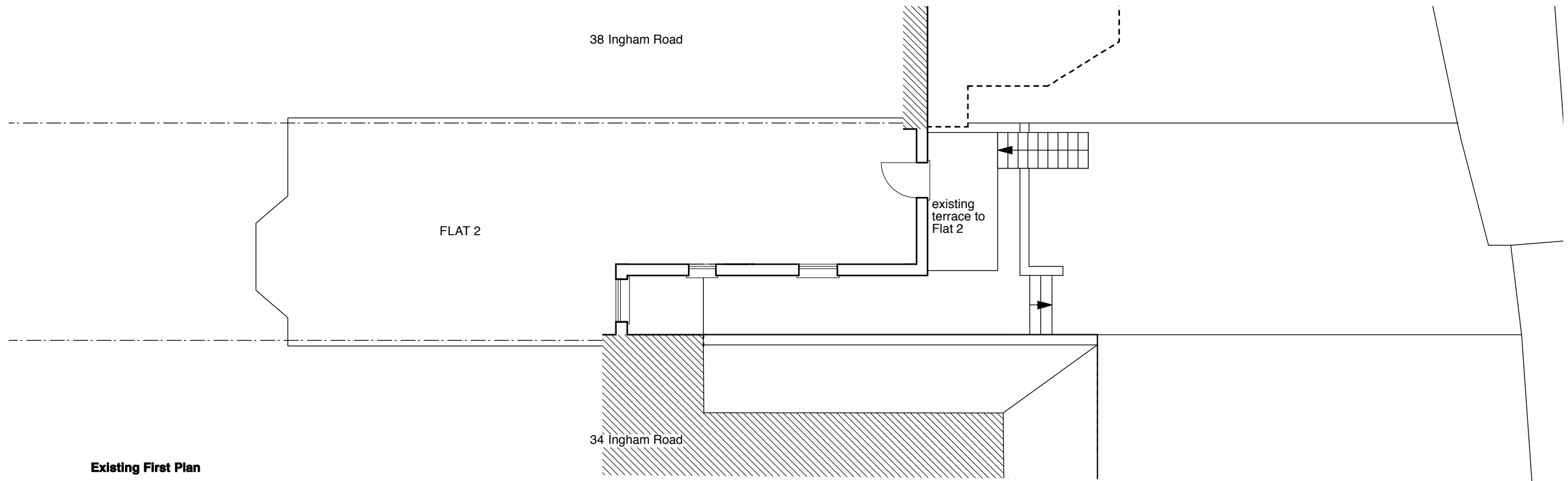

Existing First Plan

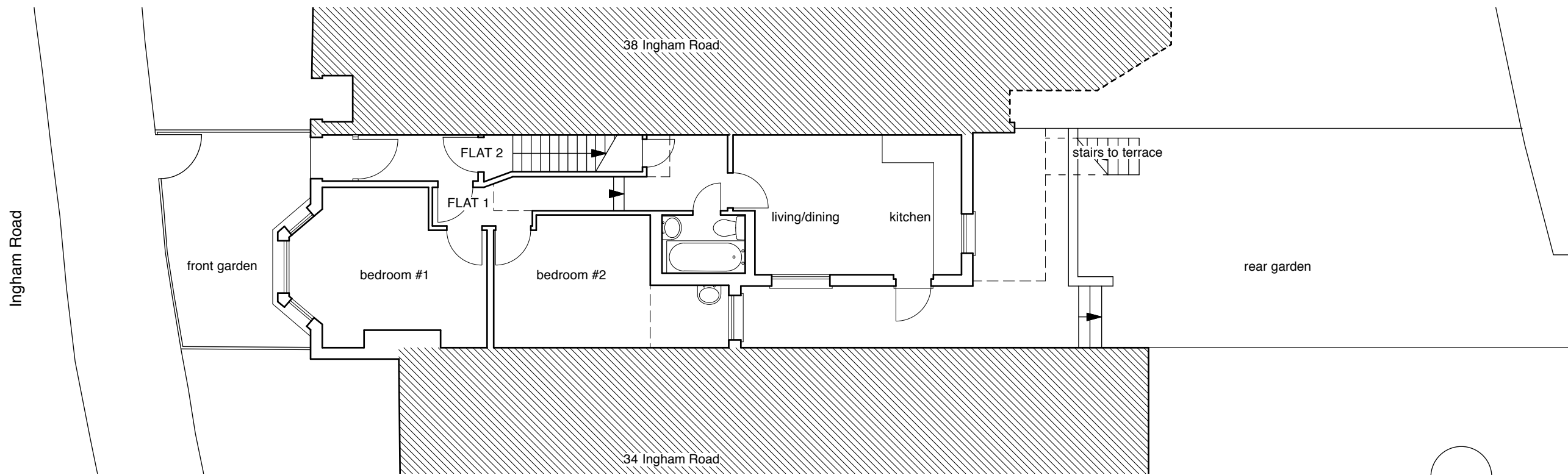

Existing Ground Plan

Revisions

4orm

1-5 Offord Street London N1 1DH

studio@4orm.co.uk
www.4orm.co.uk

Project
36 Ingham Road London NW6 1DE

Drawing Title
Existing Ground & First Floor Plans

Drawing Status
PLANNING

Date: October 2014
Scale @ A3: 1:100
Drawn: JW

Drawing Number
493-X.103_1

