

Do not Scale. Use figured dimensions only. All dimensions to be checked on site.

All drawings to be read in conjunction with the Engineers' drawings. Any discrepancies between consultants drawings to be reported to the Architect before any work commences.

The Contractor's attention is drawn to the Health & Safety matters identified in the Health & Safety plan as being potentially hazardous. These items should not be considered as a complete and final list. The Work Package Contractor's normal Health and Safety obligations still apply when undertaking constructional operations both on and off site.

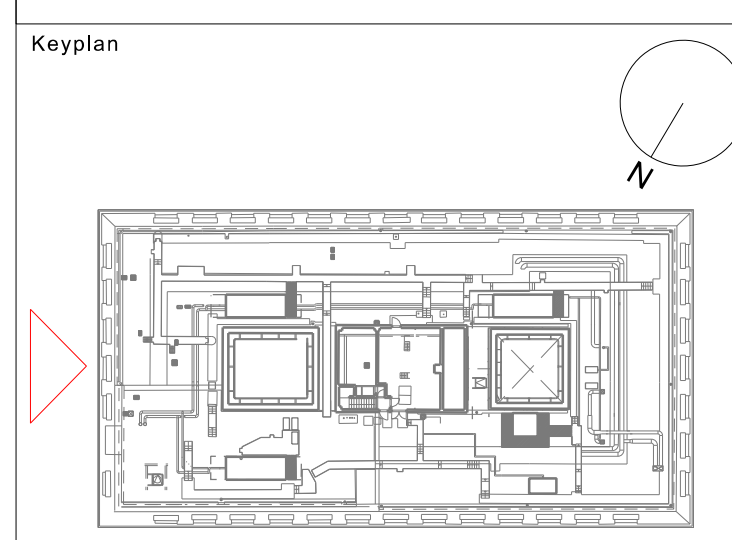

**Notes**  
 Drawings are based on existing information. All setout information to be checked on site prior to construction.  
 Finished floor levels are taken from Plowman Craven survey received 26/09/12 and refer to level at main core unless otherwise indicated.  
 Drawing based on information from Max Fordham Sketch 20120711\_4560\_WCD\_Plant Block Heights and DWG file T16-1001

- FX-51** Existing roller blinds
- FX-52** Existing blackout blinds on track
- Windows permanently blacked out
- Windows with existing frosted film

Unless otherwise stated, all windows have internal secondary glazing with tinted film applied to both layers

P00	13/02/2013	PLANNING APPLICATION	MD	GC
Issue	Date	Description	By	Chkd

33 Bowling Green Lane London EC1R 0BJ +44 (0) 20 7608 7900 T +44 (0) 20 7608 7901 F www.wilkinsonseyre.com

**WilkinsonEyre.Architects**

Client  
**WELLCOME TRUST**



Project  
**WELLCOME COLLECTION DEVELOPMENT PROJECT**

Drawing Title  
**EAST ELEVATION - EXISTING**

Scale at A1 **1:100**

Issue Status  
**PLANNING**

Drawing and CAD File Number **00820-10-P-2002** Issue **P00**

