

PLANNING ISSUE

NOTES:

All dimensions must be confirmed on site and verified with the Architect. Any discrepancies on the drawing must be reported to the Architect prior to any works being carried out on site.

Do not scale off drawing.

The copyright of this schedule / drawing remains with the Architect. No part of this schedule / drawing may be reproduced in any form or by any means without the written permission of Nicholas Lee Architects.

Project: 177 Gloucester Avenue

Drawing Title: Proposed Lower Ground Floor Folding Sliding Door Detail

Drawing No: 1220/AD-001

Date: 28.10.14

Scale: 1:2 @ A3

nicholas lee architects
 34A Rossllyn Hill, London NW3 1NH
 Tel: 020 7435 9315 www.nleearchitects.com

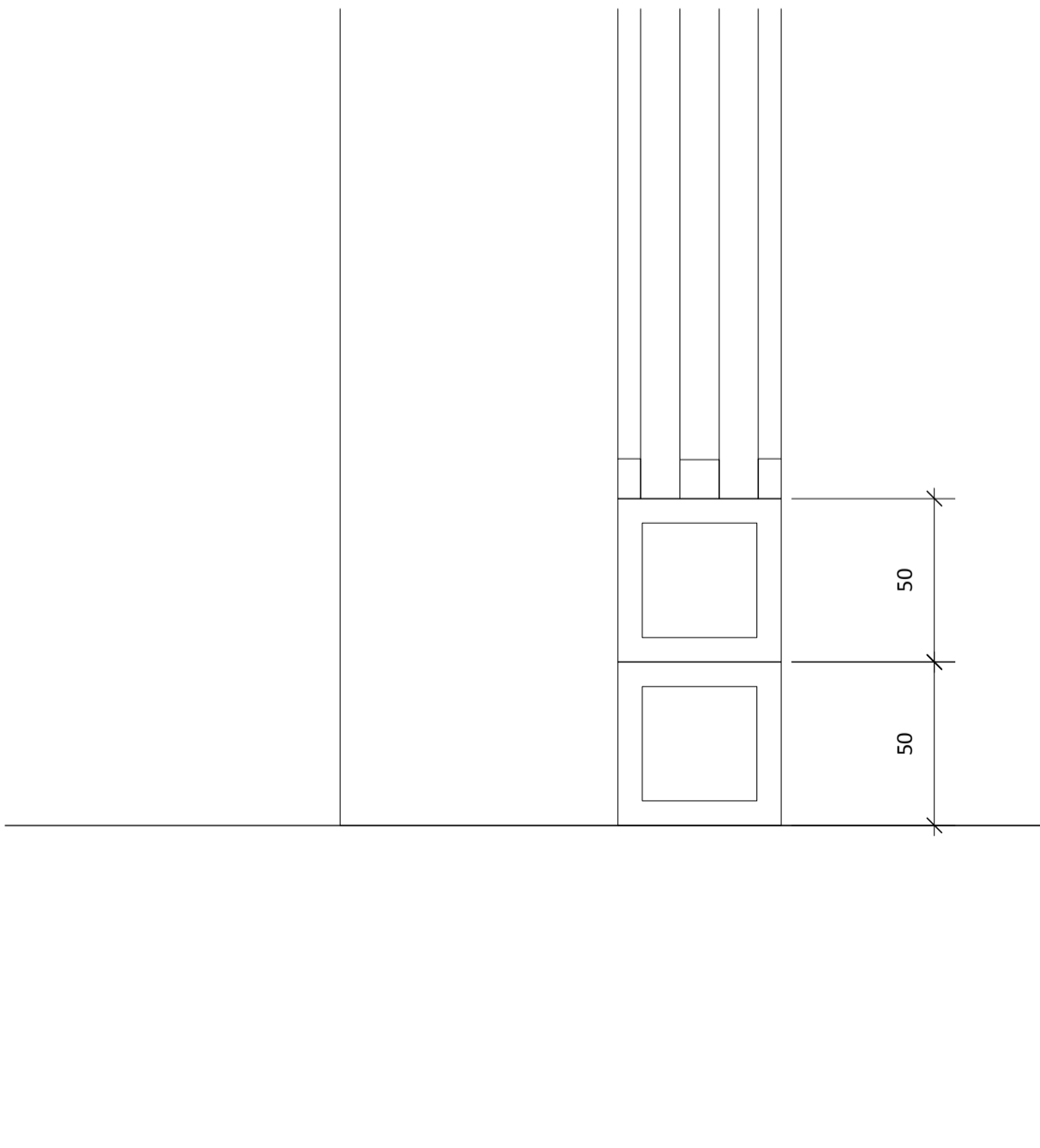
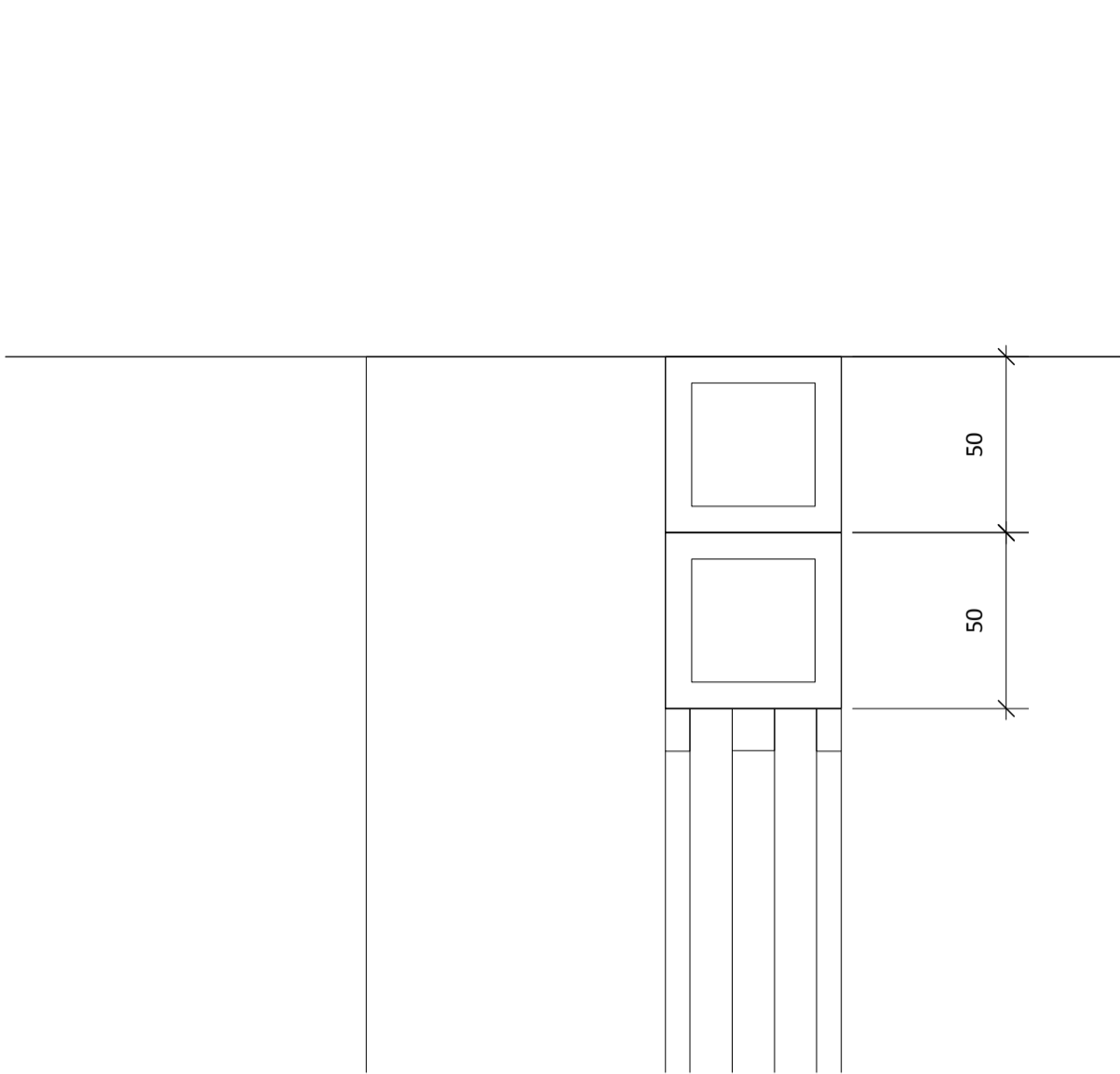

PLANNING ISSUE

NOTES:

All dimensions must be confirmed on site and verified with the Architect. Any discrepancies on the drawing must be reported to the Architect prior to any works being carried out on site.

Do not scale off drawing.

The copyright of this schedule / drawing remains with the Architect. No part of this schedule / drawing may be reproduced in any form or by any means without the written permission of Nicholas Lee Architects.

Project: 177 Gloucester Avenue

Drawing Title: Proposed Ground Floor Balcony Door Detail

Drawing No: 1220/AD-002

Date: 28.10.14

Scale: 1:2 @ A3

nicholas lee architects
 34A Rossllyn Hill, London NW3 1NH
 Tel: 020 7435 9315 www.nleearchitects.com