

DO NOT SCALE OFF THIS DRAWING
ALL DIMENSIONS MUST BE CHECKED ON SITE
INFORM THE ARCHITECT OF ANY
DISCREPANCIES PRIOR TO CONSTRUCTION
PLOT SIZE: A1

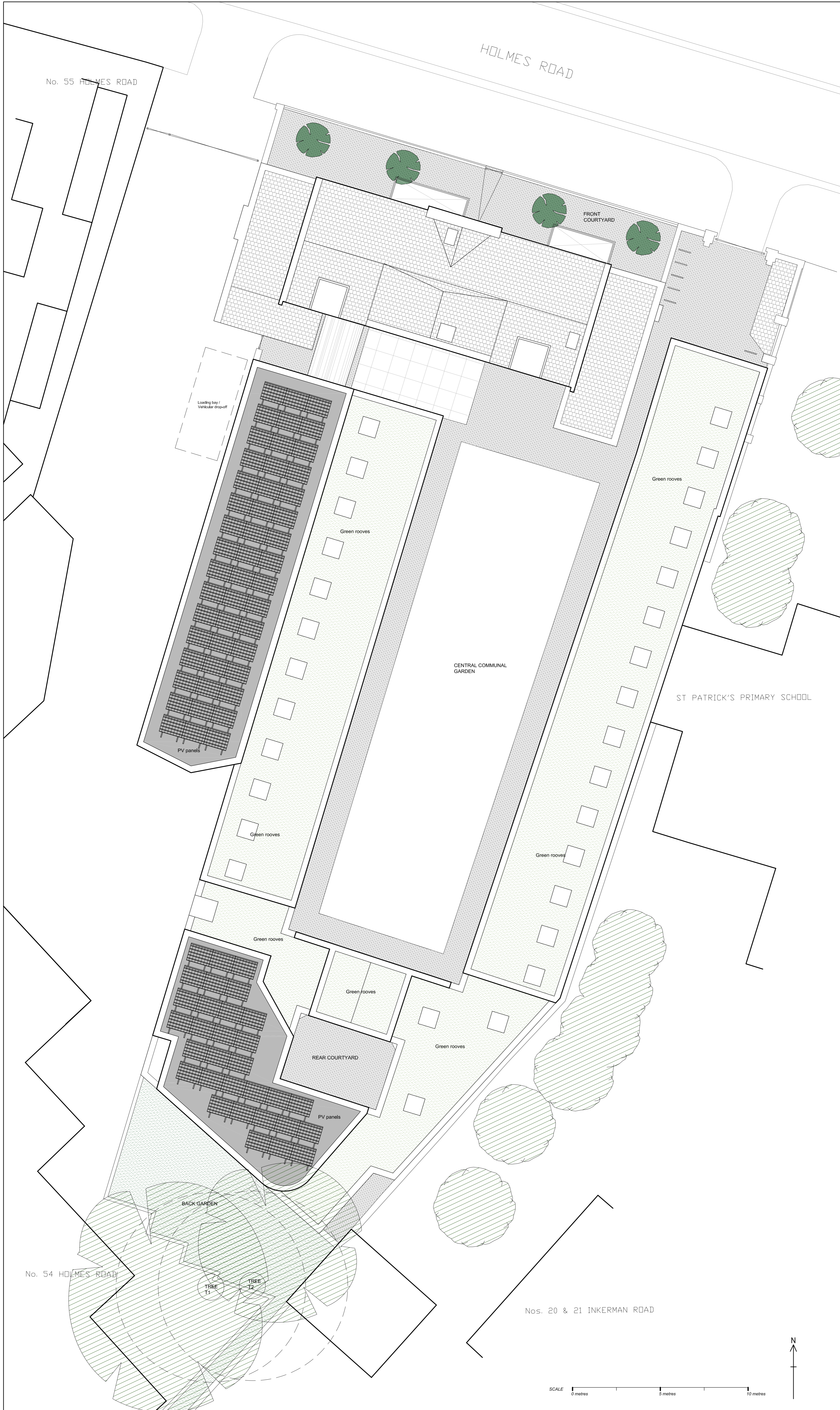

No. 55 HOLMES ROAD

HOLMES ROAD

FRONT COURTYARD

Loading bay /
Vehicle drop-off

PV panels

Green roofs

CENTRAL COMMUNAL
GARDEN

Green roofs

ST PATRICK'S PRIMARY SCHOOL

Green roofs

Green roofs

Green roofs

Green roofs

Green roofs

REAR COURTYARD

PV panels

BACK GARDEN

TREE
11

TREE
12

No. 54 HOLMES ROAD

Nos. 20 & 21 INKERMAN ROAD

SCALE 0 metres 5 metres 10 metres

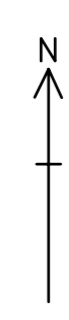

REVISIONS:
A 29.05.12 Draft Stage D
B 18.06.12 For Information
C 26.06.12 Final Client SignOff Record Set
D 20.07.12 FINAL DRAFT PLANNING SET
E 13.09.12 Revised to indicate PV panels
F 15.10.12 FINAL PLANNING SET
G 07.02.13 UPDATED FOR PLANNING
H 14.05.13 PV PANELS AMENDED
J 20.08.13 26 garden studio units reduced to 25
PV panels added
K 09.10.13 Rooflights amended

PETER BARBER
ARCHITECTS

173 Kings Cross Road LONDON WC1X 9BZ
T:020 7833 4499 F:020 7833 4999
e:architecture@peterbarberarchitects.com

JOB: 41 - 43 Holmes Road, NW5 3AN

CLIENT: London Borough of Camden

SCALE: 1/100 @ A1 DATE: 11.11
DRAWN: JP CHECKED: PB

TITLE: PROPOSED SITE PLAN
INCLUDING ROOF PLAN

DRAWING NO: 100_P_01P

REV: K

ISSUED FOR PLANNING