

CONSTRUCTION KEY	
	existing retained
	line over/under/behind
	demolished
	new construction

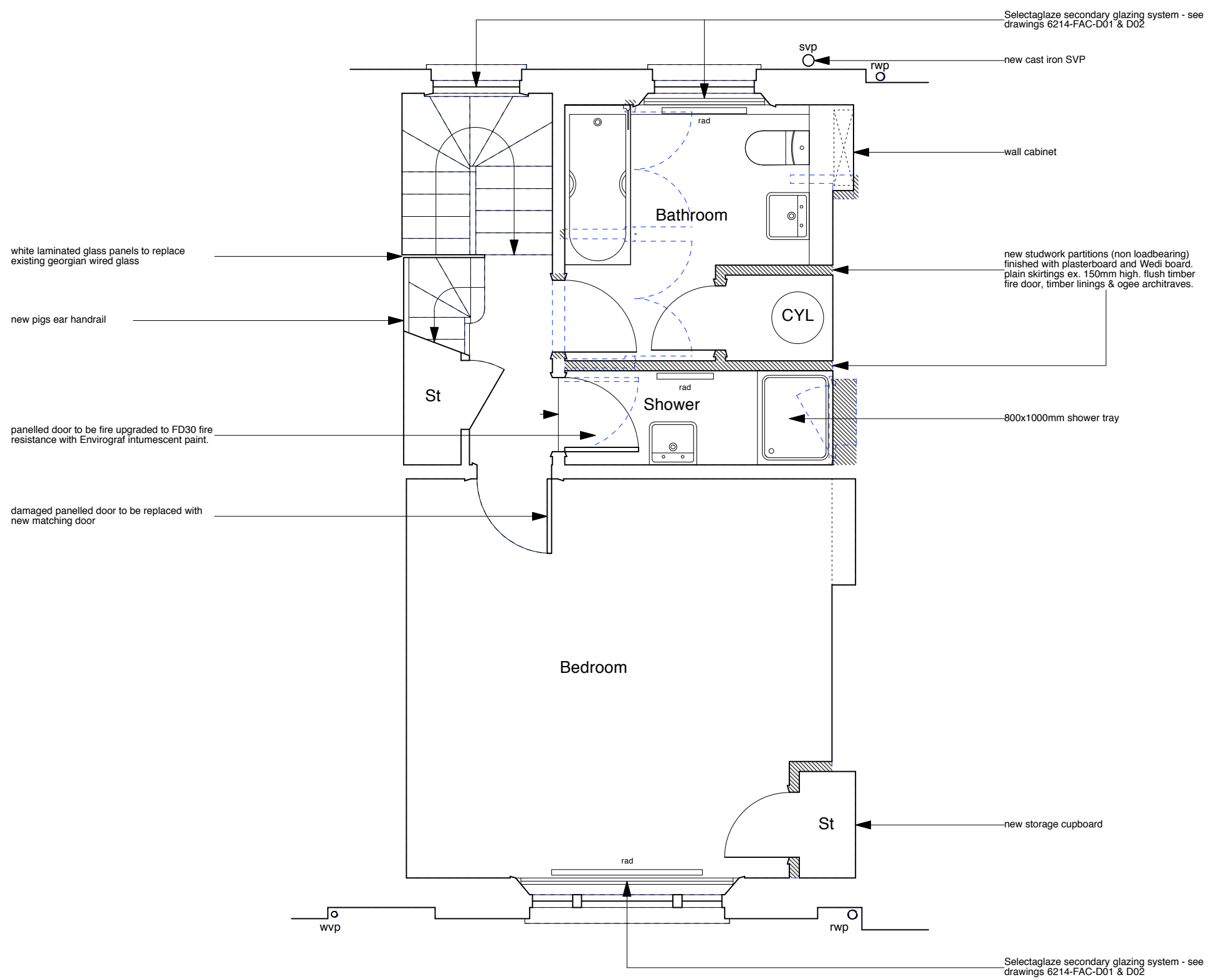

NOTE:
 All ceiling plasterboard to be replaced throughout the second floor (1 hour fire resisting).
 Except for existing panelled doors, all internal doors to be renewed as solid timber flush fire doors.



	PROJECT 5 ARCHITECTURE LLP 8 Waterson Street London E2 8HL T: +44 (0)20 7739 9131 F: +44 (0)20 7739 3687 E: info@p5a.co.uk	job title 60 FREDERICK STREET, LONDON WC1X 0ND	scale 1:50 @ A3	drawn SA	drawing no. 6214-FS60-P04
	drawing SECOND FLOOR PLAN - PROPOSED	date JULY 2014	checked XX		