

- NOTES
- 1 The Contractor must check and confirm dimensions
  - 2 All discrepancies must be reported and resolved by the Architect before works commence
  - 3 This drawing is not to be scaled
  - 4 All work and materials to be in accordance with current applicable Statutory Legislation and to comply with all relevant Codes of Practice and British Standards.

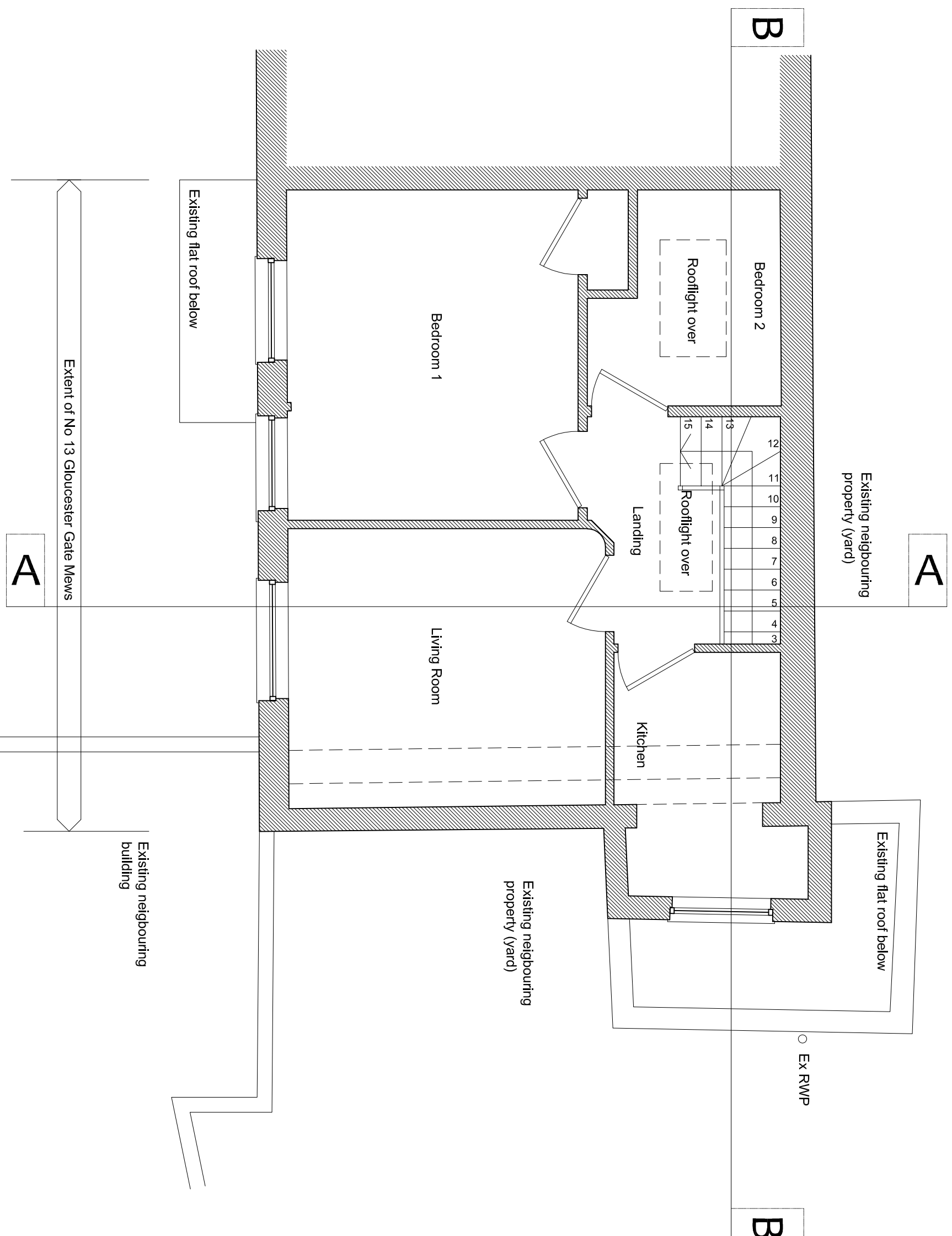

Rev	Initial Issue	Date
-	Initial Issue	06/08/14

**through.**  
*architecture* *musick* *through* *leadership*  
 26 Stone Street, London, WC1E 7BT  
 studio@through.org.uk, @thruul, through.org.uk

Client  
 Mr Peter Higson  
 (Client Agent to Mr Ray Morris)

Project  
 13 Gloucester Gate Mews  
 London

Drawing  
 EXISTING FIRST FLOOR PLAN

Scale	Date	Drawn
1:50@A3	06/08/14	JJ
Drawing No	Revision	
GGM-A-01-1001	-	