

62

60

58

56

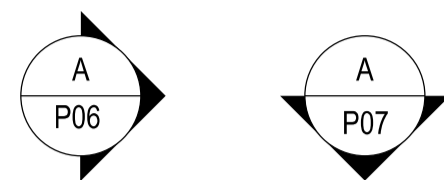

C A M D E N M E W S
(B E L O W)

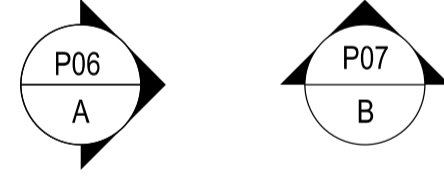
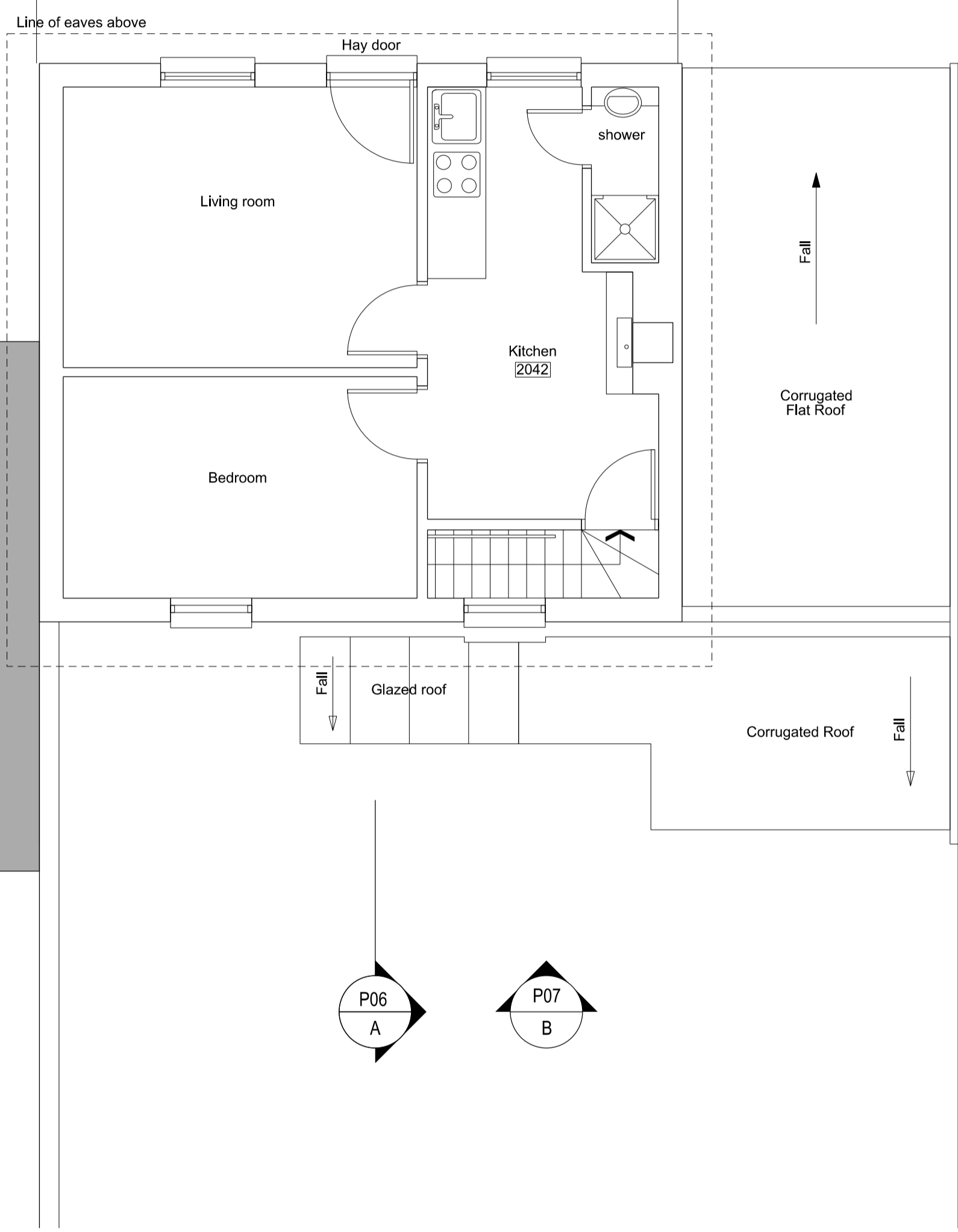

SAFETY, HEALTH AND ENVIRONMENTAL INFORMATION:	
IN ADDITION TO THE HAZARDS / RISKS NORMALLY ASSOCIATED WITH THE TYPES OF WORK DETAILLED ON THE DRAWINGS, NOTE THE FOLLOWING:	
Significant Residual Risks:	
Action to be Taken:	
Refer to Health and Safety Plan	

NOTES:

Gross Internal Floor Area (G.I.F.A)	
Ground	: 66.3m ²
First	: 36.2m ²
Total	: 102.5m ²

REV	DATE	DETAIL	DRN	CHK
P01	18.07.14	Planning Submission	AA	JW

Existing Garages

83

PROJECT TITLE
85 CAMDEN MEWS

DRAWING TITLE
**First Floor Plan:
Existing**

DATE	18.07.14	SCALE	1:50 @A1 1:100 @A3
STATUS	Planning	DRAWN	AA
		CHECKED	JW

DRAWING NUMBER	85_CM_P04	REVISION	P01
----------------	------------------	----------	------------

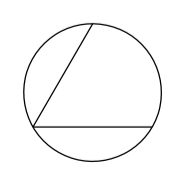

CULLINAN STUDIO
 5 BALDWIN TERRACE LONDON N1 7RU TEL: 020 7704 1975
 PROJECT EMAIL: 85_camdenmews@cullinastudio.com