

62 60 58 56

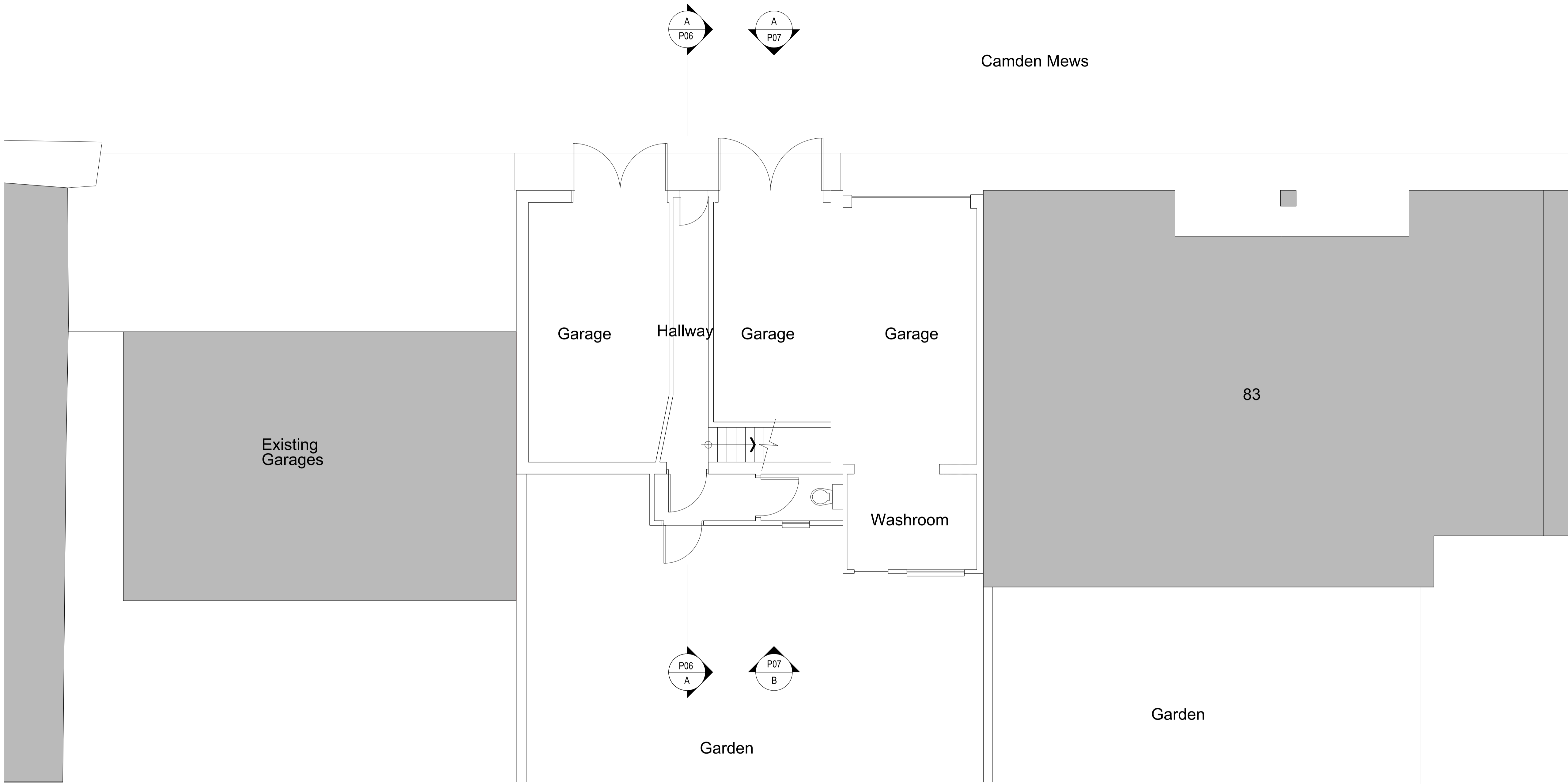

**SAFETY, HEALTH AND ENVIRONMENTAL INFORMATION:**

IN ADDITION TO THE HAZARDS / RISKS NORMALLY ASSOCIATED WITH THE TYPES OF WORK DETAILLED ON THIS DRAWING, NOTE THE FOLLOWING:

Significant Residual Risk:

Action to be Taken:

Refer to Health and Safety Plan

**NOTES:**

Gross Internal Floor Area, (G.I.F.A)

Ground : 66.3m<sup>2</sup>  
 First : 36.2m<sup>2</sup>  
 Total : 102.5m<sup>2</sup>

REV	DATE	DETAIL	DRN	CHK
P01	18.07.14	Planning Submission	AA	JW

PROJECT TITLE  
**85 CAMDEN MEWS**

DRAWING TITLE  
**Ground Floor Plan:  
 Existing**

DATE 18.07.14	SCALE 1:50 @A1 1:100 @A3
STATUS Planning	DRAWN AA
	CHECKED JW

DRAWING NUMBER <b>85_CM_P03</b>	REVISION <b>P01</b>
------------------------------------	------------------------

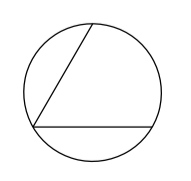

**CULLINAN STUDIO**  
 5 BALDWIN TERRACE LONDON N1 7RU TEL: 020 7704 1975  
 PROJECT EMAIL: 85\_camdenmews@cullinstudio.com