

Do not scale, use figured dims, only. All dims, to be checked on site by builder before work commences. If any discrepancies are found, ATK Designs to be notified for amendments. All work to be carried out to relevant British Standards, codes of practice & current B.Reqs. Where structural alterations take place great care must be taken by the builder, to afford restraint to all affected areas, during & after the building work. If during excavation any basements, cellars, wells etc. are found, ATK Designs must be made aware for design amendments before continuing. Where new loads are imposed on existing lintels, they must be checked by Builder for adequacy & to L.A. approval. If found not to be adequate, lintels must be replaced. Where applicable this Dwg. must be read in conjunction with Structural Calculations. If Dwg. conflict with calculations, calculations must take preference.

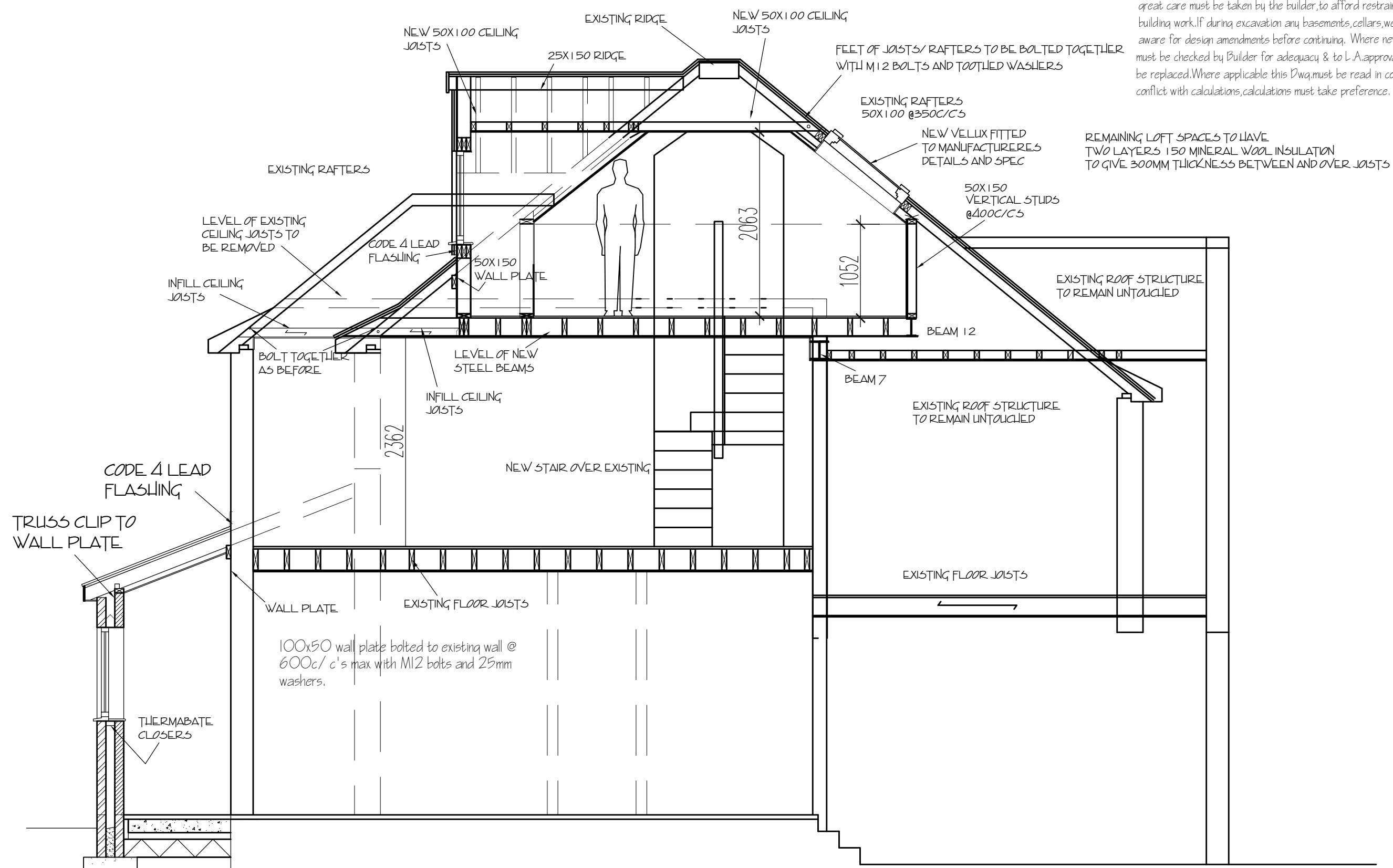

Ground Floor Construction to achieve 0.22W/m<sup>2</sup>K  
 75mm cement/ sand screed  
 150mm ST4 concrete floor slab on  
 500q Visqueen vapour barrier  
 75mm min Celotex FF 4000 insulation turned up at perimeter to suit slab depth  
 1200q polythene D.P.M.  
 50mm sand blinding  
 150mm M.O.T. grade 1 compacted hardcore.

SECTION A-A

A	revised layout	
B	Pr amendments added	
No.	Revision/Issue	Date

**ATK DESIGNS**  
 ARCHITECTURAL DESIGN  
 PLANNING CONSULTANTS  
 16, SCHOOL LANE, OFFLEY, NR. WITTON  
 HERTFORDSHIRE, SG5 9AZ  
 TELEPHONE 01462 768412  
 MOBILE 0759529528  
 E-MAIL atkdesigns2@gmail.com

client  
 J McMallon LTD  
 17 MAKEPEACE AVE  
 LONDON N6 6EL

project  
 LOFT CONVERSION AND  
 SINGLE STOREY REAR  
 EXTENSION  
 SECTION A-A  
**AS BUILT**

Project	ATK/13/JM/BRA	Sheet
Date	SEPT 2013	<b>A3</b>
Scale	1:50	