

DIADEM-150

PERIMETER WALL DRAINAGE OR OVERFLOW / KSA PERIMETER INSPECTION BOX

#901300_A150_01

DIADEM®

Junction

■ Green up the roof!

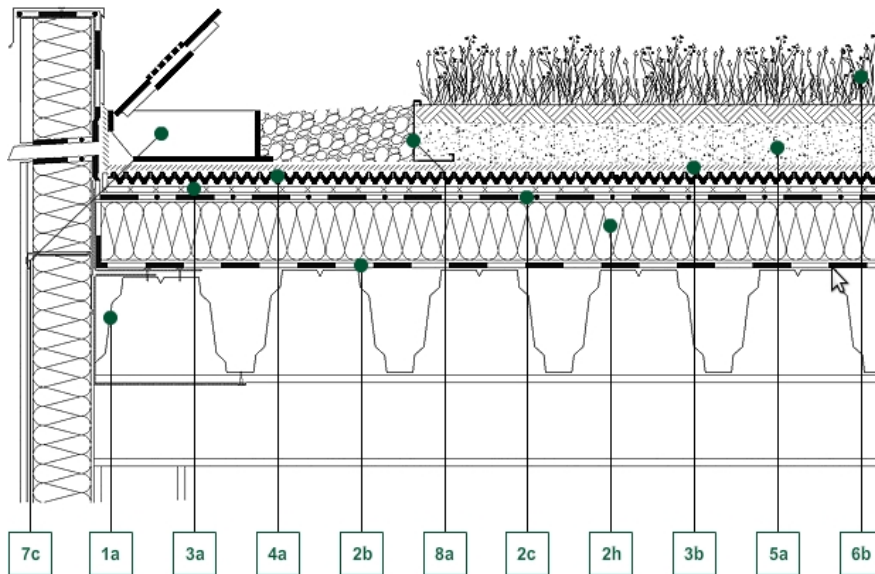

Decking constructions:

1a - Steel trapezoid sheet sloped floor structure

Water isolation:

2b - FLW-400 ext. Root barrier, Vapour control layer

2c - Root-resistant waterproof membrane

2h - Stone wool heat insulation

Geotextile layers:

3a - VLU-300 mechanical protecting layer

3b - VLF-150 filter layer

Drainboards:

4a - DiaDrain-25 drainage board

Growth medias:

5a - SEM-12 extensive growth medium

Vegetation:

6a - Drought-resistant, herbaceous perennials

Hydrotechnical products:

7c - KSA-10 inspection boxes 5-30 cm

Edging element:

8a - KLR-AL-8/12 gravel lath

Description of junction:

Good practice requires that each roof area has a minimum of two drainage points. Local conditions determine where these are located and may also indicate an additional requirement for the installation of an overflow. It is important that these drainage points remain free from any obstruction, therefore access should be provided for maintenance purposes.

APP Kft.

H-9028 Győr, Fehérvári út 75.
E-mail: info@diademroof.com, Web: www.diademroof.com