

- ① new glazed brick panels to window recesses below existing windows
- ② repair facade throughout at ground floor
- ③ new pull out awnings above each window with graphics
- ④ new metal hanging sign above door 500mm X 600mm approx
- ⑤ new vertical flagpole above aligned with hanging sign below – 3m x 600mm approx.
- ⑥ new full height, metal, pivot-hinged door
- ⑦ reinstated existing glazed vent and refurbish existing door
- ⑧ new graphics to reinstated fascia above windows and new lighting above entrance

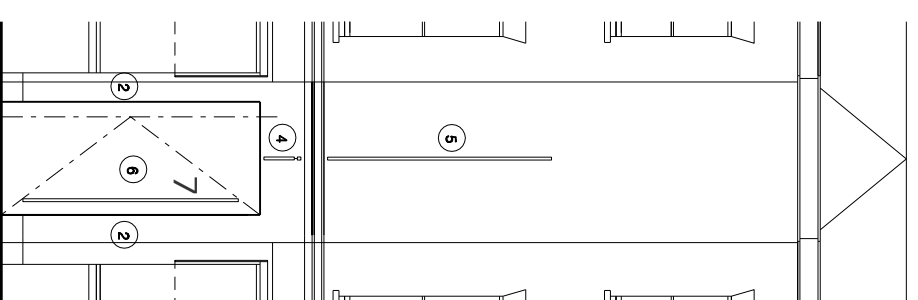

proposed elevation



proposed corner elevation



proposed elevation

Rev	Notes	Date

- all dimensions are to be checked on site and any discrepancies reported to the architect
 - do not scale this drawing
PRELIMINARY



WORKS
 ARCHITECTURE

16 UPPER MORTLAU STREET
 LONDON W1H 2AN
 020 7224 8750
 WWW.WORKSARCHITECTURE.COM

Title: **proposed elevations**
 Project: **goodge place**

Date: 21.07.14 Drawn: js Scale: 1:100@A3 Drawing Number: e 101 Revision: