

SITE INVESTIGATION REPORT

Client:

London Borough of Camden

Client Ref:

1585728/1

Site Address:

**1-44 Denyer House/
Grove End Lodge
London
NW5 1BN**

Date of Site Investigation:

31st October 2013

REPORT CONTENTS

<u>Item</u>	
1.0	Trial Pit/Borehole location drawing
2.0	Photographs
3.0	Trial Pit section
4.0	Borehole Log
5.0	Root Identification results
6.0	Laboratory test results

Note: The above sections are part of a standard numbering system. Only the sections required for this report have been enclosed, therefore the numbering may not run sequentially.

BOWBUILD

Quadrant House, 65B Croydon Rd, Caterham, Surrey, CR3 6PB
Tel/Fax: 01883 349 091
Email: admin@bowbuild.co.uk Website: www.bowbuild.co.uk

Client:	London Borough of Camden	Date:	31-10-13
Site Address:	1-44 Denyer House/Grove End Lodge, London, NW5 1BN	Job No:	13/109

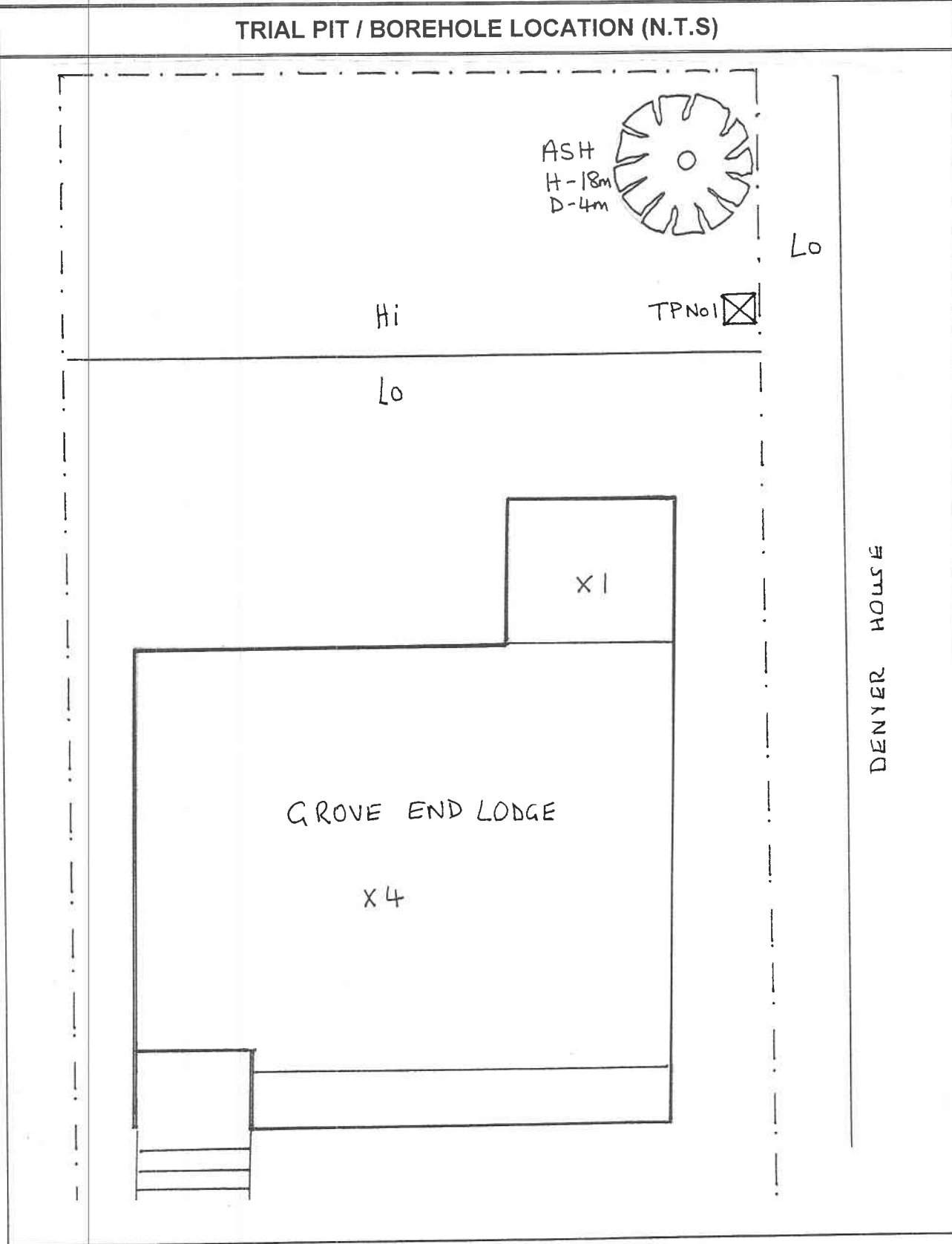

BOWBUILD

Quadrant House, 65B Croydon Rd, Caterham, Surrey, CR3 6PB
Tel/Fax: 01883 349 091
Email: admin@bowbuild.co.uk Website: www.bowbuild.co.uk

Client:	London Borough of Camden	Date:	31-10-13
Site Address:	1-44 Denyer House/Grove End Lodge, London, NW5 1BN	Job No:	13/109

PHOTOGRAPHS

TPNo1 next to Ash tree



TPNo1 location



TPNo1 detail



Grove End Lodge/Denyer House



BOWBUILD

93 Stanstead Road, Caterham, Surrey, CR3 6AG

Tel/Fax: 01883 341736

Email: admin@bowbuild.co.uk Website: www.bowbuild.co.uk

Client: London Borough of Camden

Date: 31-10-13

Site Address: 1-44 Denyer House/Grove End Lodge, London, NW5 1BN

Job No: 13/109

TRIAL PIT 1 SECTION

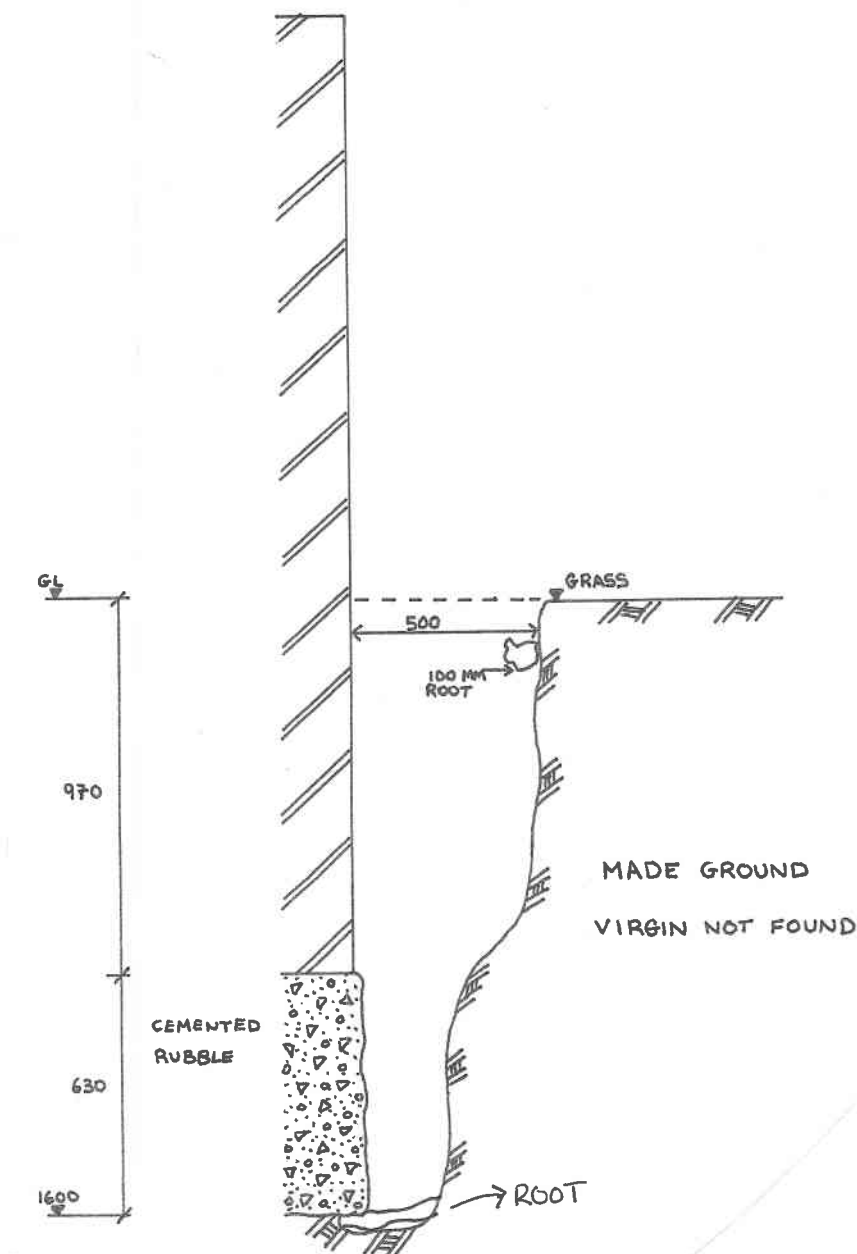

Location: LH boundary wall at Grove End Lodge

Scale: 1:20

Note: All dimensions in millimetres.

BOWBUILD

93 Stanstead Road, Caterham, Surrey, CR3 6AG

Tel/Fax: 01883 341736

Email: admin@bowbuild.co.uk Website: www.bowbuild.co.uk

Client:	London Borough of Camden	Date:	31-10-13
Site Address:	1-44 Denyer House/Grove End Lodge, London, NW5 1BN	Job No:	13/109

BOREHOLE LOG – BH1

Water/ Roots	Samples		Strata		N.B. All depths in millimetres from local G.L.		
	Type	Depth	Legend	Depth	Description		
<u>Root Samples:</u> root 1.0mmø 1600(test) Last visible roots 1600	J(1A)	1550	MADE GROUND	200	Footings 1600+	Topsoil	Trial Hole +probe
						MADE GROUND	
						Very dry clay fill and hardcore	
				1200		(Damp) firm/stiff silty sandy clay fill	
				1500 1600		Abundant brick from 1500	
						Borehole aborted at 1600 due to brick and large root	

Remarks

Boring method: Hand auger. Borehole 100mm diameter.

Ground level = Datum. Descriptions taken from drillers logs.

Key

J (Disturbed Jar Sample) 1A (Sample number)

U38 (Undisturbed 38mm tube sample) SU38 (Soil suction on undisturbed 38mm tube sample)

BOWBUILD

93 Stanstead Rd, Caterham, Surrey, CR3 6AG

Tel/Fax: 01883 341 736

Email: admin@bowbuild.co.uk Website: www.bowbuild.co.uk

Client:	London Borough Of Camden	Date:	31-10-13
Site Address:	1-44 Denyer House/Grove End Lodge, London, NW5 1BN	Job No:	13/109

ROOT IDENTIFICATION RESULTS



Richardson's Botanical Identifications

Root identification
Vegetation surveys
Tree Building investigations
Plant taxonomy

Bowbuild
Quadrant House
65B Croydon Road
CATERHAM
CR3 6PB

12/11/2013

Dr Ian B K Richardson
BSc PhD, C Biol, MIBiol, MIBot, FLS
James Richardson
BSc (Hons. Biology)

Enterprise House
49-51 Whiteknights Road
Reading
RG6 7BB

Tel: (0118) 986 9552 (Direct line)
E-mail: richardsons@botanical.net
Web: www.botanical.net

Your ref: -

Our ref: 73/1803

Dear Sirs

1-44 Denyer House, Grove End Lodge, London

The sample you sent in relation to the above on 06/11/2013 has been examined. The structure was referable as follows:

TH1.1600

1 root: FRAXINUS (Ash). 1mm diameter (approximately). Alive, recently*.

I trust this is of help. Please call us if you have any queries; our Invoice is enclosed.

Yours faithfully

Dr Ian B K Richardson

* Based mainly on the Iodine test for starch. Starch is present in some cells of a living woody root, but is more or less rapidly broken down by soil micro-organisms on death of the root, sometimes before decay is evident. This result need not reflect the state of the parent tree.

** Try out our web site on www.botanical.net **

Identified with no information on vegetation, on or off site

Report commissioned by BOWBUILD

BOWBUILD

Quadrant House, 65B Croydon Rd, Caterham, Surrey, CR3 6PB
 Tel/Fax: 01883 349 091
 Email: admin@bowbuild.co.uk Website: www.bowbuild.co.uk

Client:	London Borough of Camden	Date:	31-10-13
Site Address:	1-44 Denyer House/Grove End Lodge, London, NW5 1BN	Job No:	13/109

SOIL TESTING RESULTS

Sample Details			Description	Classification Tests					Chemical Tests		Other tests and comments	
TP/BH	Depth (M)	No.		MC %	LL %	PL %	PI	<425 μ m %	Water Soluble SO ₄ g/L	<2mm %	MC % <425 μ m	
1	1.55	A	Dark brown mottled grey gravelly silty clay with roots and rootlets. Gravel is fine to medium flint, brick, concrete and wood	32	67	28	39	76			42	Sample washed Class CH

Plasticity characteristics: Plots above the A-line

CLAYS CL Low plasticity
 CI Intermediate plasticity
 CH High plasticity
 CV Very high plasticity
 CE Extremely high plasticity

Plots below the A-line

SILTS M

GEOLABS
 Project No.
 GEO / 20552

British Standard references for tests:

- Moisture content - BS1377: Part 2: Clause 3.2: 1990
- Liquid and plastic limits - BS1377: Part 2: Clauses 4.4, 5.3 and 5.4: 1990 (One point cone penetrometer method)
- Non-plastic - BS1377: Part 2: Clauses 3.2 and 5.3: 1990 (Determination of plastic limit - where results are recorded as non-plastic)
- Moisture content of material passing 425 micron sieve - Non British Standard test for recalculated moisture content of material passing 425 micron sieve. Test carried out in accordance with BS1377: Part 2: Clause 3.2.4, Note 1: 1990