

GENERAL NOTES:
 Detail drawings show layouts and design intent and should be read in accordance with Architectural General Arrangement drawings, Architectural Outline Specification, and any Schedules.

All details and interfaces to be developed with Contractor and key Subcontractors. Sealant and weathertightness joints may be omitted for clarity.

Key references are typically to Architectural Outline specification.

Drawings may indicate elements to be designed and specified by other Consultants for coordination purposes. Please also refer to these drawings, schedules and specifications. Please report any discrepancies to Architect for confirmation.

Full fabrication drawings to be provided for approval of all elements, details and interfaces.

All insulation thicknesses, levels and calculations to be confirmed by the Contractor

NOTE:

Flexwood to provide detailed drawings from their own site survey & install windows. Final Design and specification to be confirmed by Flexwood and signed off by ABSE & PTAL.

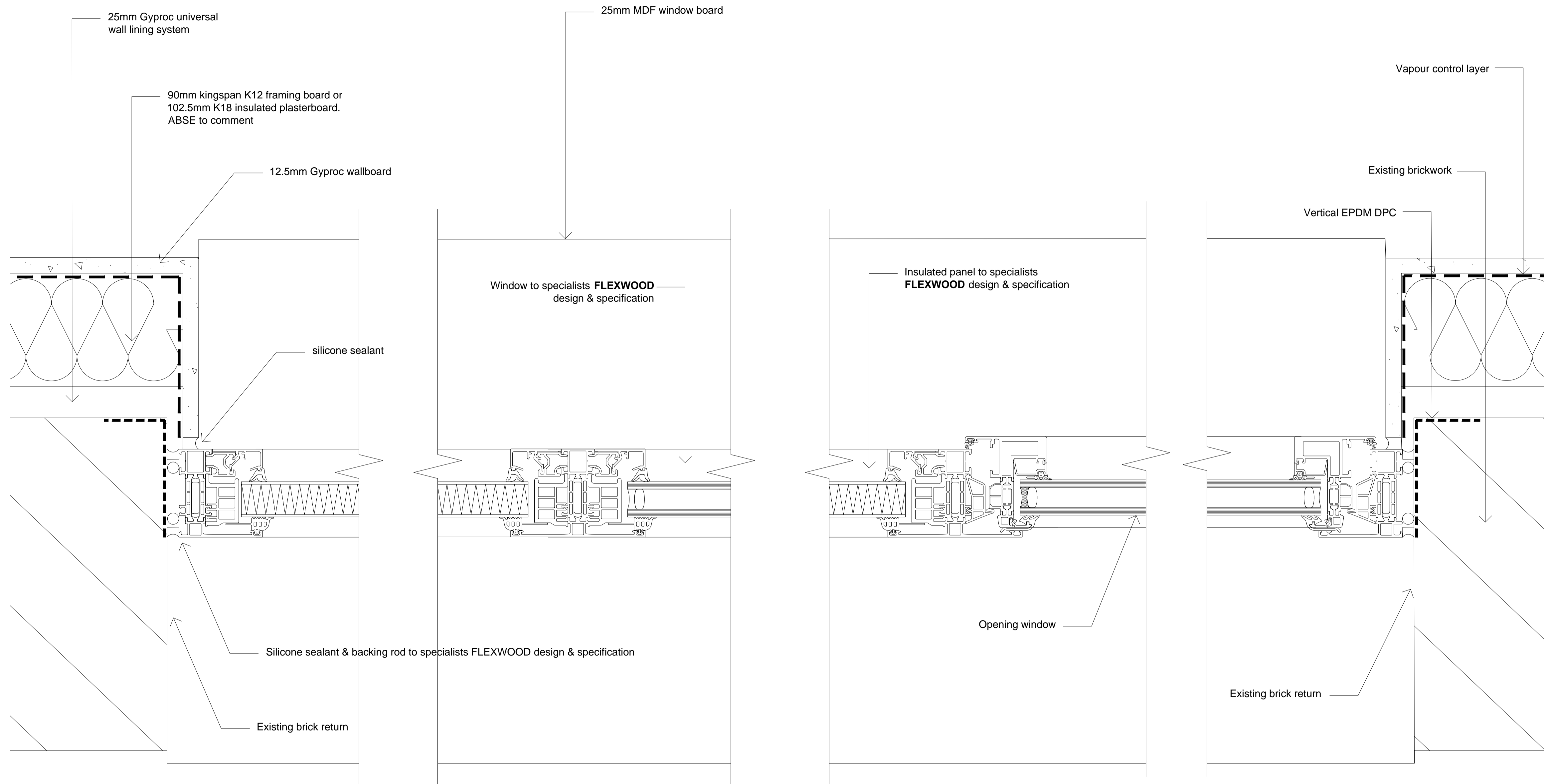

1 Insulated Panel Jamb Detail

2 Insulated Panel / Window Mullion Detail

3 Insulated Panel / Opening Light Mullion Detail

4 Opening Light Jamb Detail

C2 date: 29/07/14 Second construction issue. drawn: DS checked: PGB
 C1 date: 27/09/13 First construction issue. drawn: DS checked: NR
 revisions

status: CONSTRUCTION
 This drawing is protected under The Copyright, Designs and Patents Act 1988. Do not scale. Figured dimensions only are to be taken from this drawing. All dimensions are to be checked on site before any work is put in hand. If in doubt, ASK.

P T A L
 PETER TAYLOR ASSOCIATES LIMITED
 THE ROLLER MILL - MILL LANE
 UCKFIELD - EAST SUSSEX TN22 5AA
 TELEPHONE + 44 (0) 1825 768 377
 FACSIMILE + 44 (0) 1825 765 752
 EMAIL SOUTHERN@PTAL.CO.UK
 WWW.PTAL.CO.UK

client: ALLENBUILD
 project: SUFFOLK HOUSE
 WHITFIELD PLACE
 LONDON W1
 title: UNIT A1 FIRST FLOOR WINDOW DETAILS
 scale: 1:2 @ A1 1:4 @ A3
 date: JULY 2013
 drawn: AS
 checked: NR
 job no: H13-079 drawing no: (60) 002 revision: C2