

**All windows new unless otherwise stated****Windows & Doors**

All new and altered windows and doors cut into existing brickwork, to align with existing brick joints

For all new and altered structural openings cut into existing brickwork the dimensions shown here are **indicative and measurements need to be taken on site by the contractor prior to manufacture and pricing**

**measurements need to be taken on site by the contractor prior to manufacture and pricing**

For replacement of windows into existing brickwork structural openings the dimensions shown here are also indicative and measurements need to be taken on site by the contractor prior to manufacture and pricing

All windows within 800mm of FFL to be fixed or have 100mm opening restrictors and provide suitable containment for the glazing to accord with AD K2, 0.36kN/m load resistance over drops/height changes, to manufacturers details.

All glazing in critical locations; e.g. between finished floor level and 800mm above that level in internal and external walls and between finished floor level and 1500mm above that level in a door or side panel close to either edge of the door must break safely; be robust or in small panes or be permanently protected in accordance with BS6206 1961 and approved document N.

-New first floor window opening size to be a minimum of 450mm height and width with total opening area to be greater than 0.33m<sup>2</sup> for means of escape.

-New first floor window cills to be positioned no greater than 1100mm from FFL to enable escape.

-All habitable rooms to provide minimum 5000mm<sup>2</sup> total background ventilation through window ventilators. Kitchen, utility and bathrooms to provide minimum 2500 mm<sup>2</sup> total background ventilation through window ventilators.

-For all doors handing please refer to plans.

-Glazing fitted to manufacturers details

-All existing structural openings to be measured on site prior to manufacture, particularly in relation to skimming ceilings.

-Structural openings of all internal doors include a 7mm gap

-Architraves for all houses made to be fit site dimensions

REV	DATE	DESCRIPTION	DRAWN	CHECKED

## Planning

Approved Planning Validated

**Mr. Pirie**  
Client

**6 Leigh Str., Bloomsbury**  
Project

**Windows Schedule**  
(Types LL and QQ)  
Issued

**J14893W**  
Project Code

**AD580**  
Drawing Code

**23/07/2014**  
Date

**PW**  
Author

**MW**  
Approver

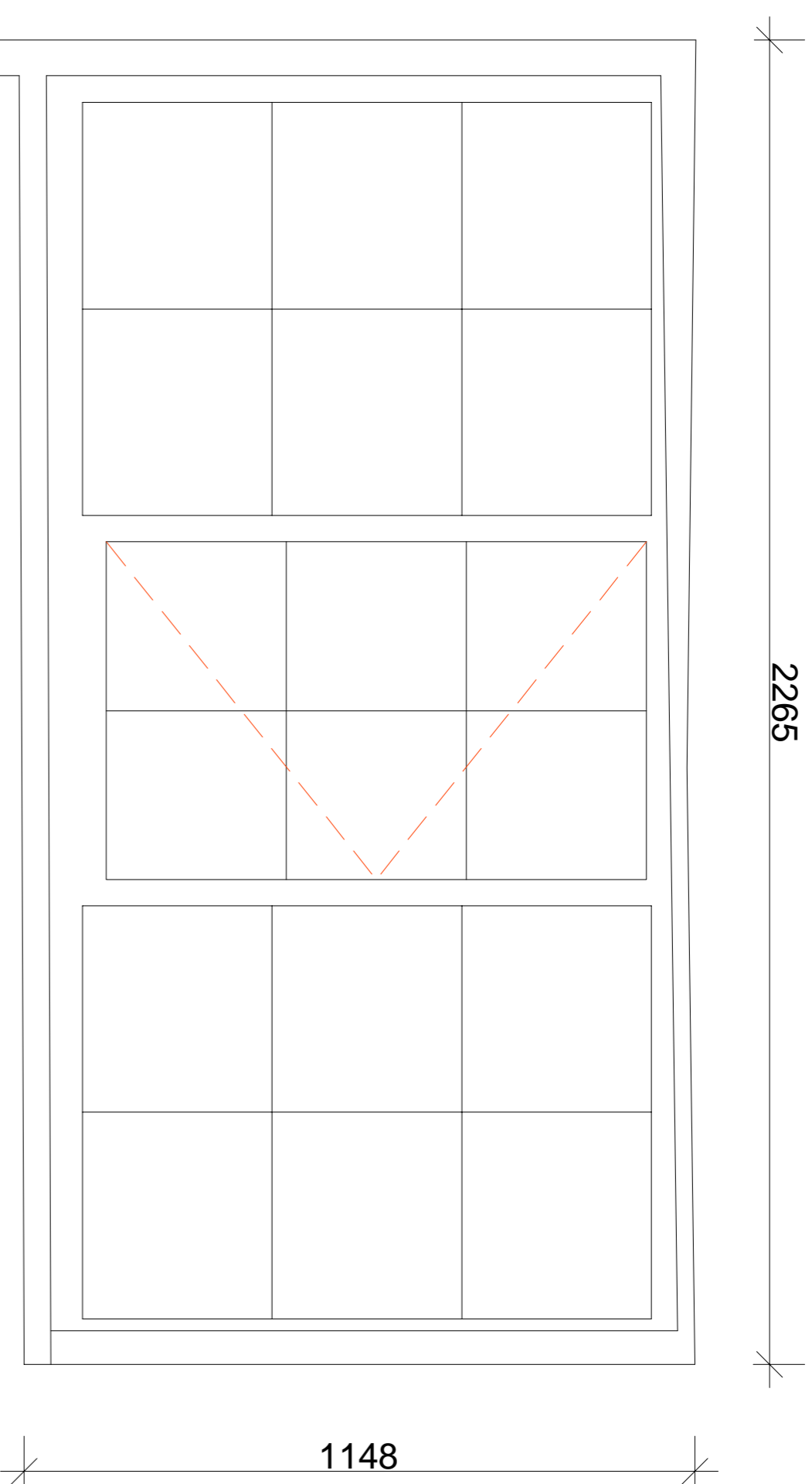
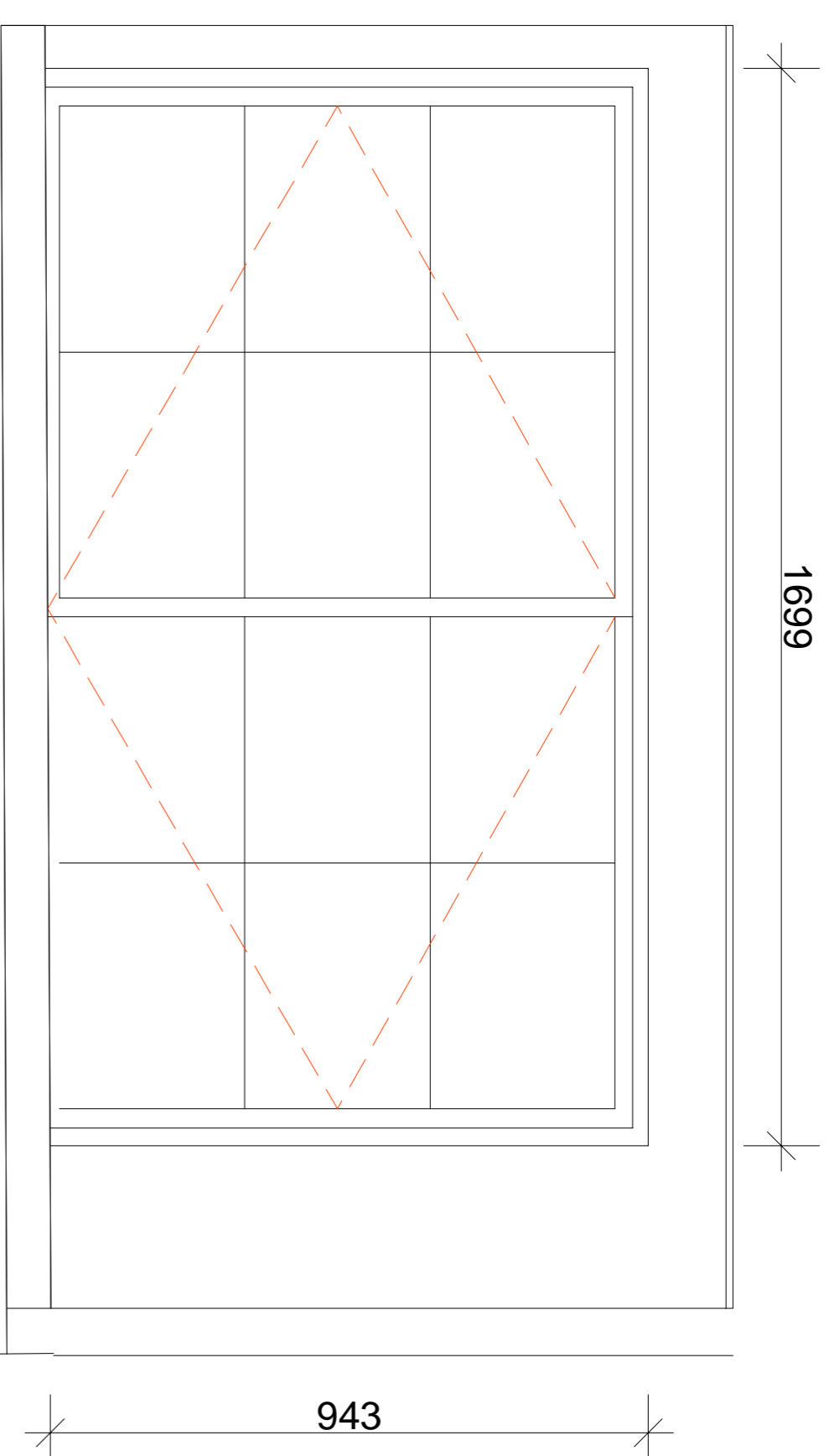

Type LL:	WG 4
Str Opening: (w/h)	1300 x 1038 mm
Frame:	Sapele
Finish:	Primed & painted
Window head:	none
Sill:	Portland stone
Sub-sill:	Iroko sub-sill primed and painted
Glazing:	Simlile 14mm double glazed units
Obscure:	none
U-Value:	1.4W/m <sup>2</sup> K
Egress:	-
Caseament:	Weighted sash
Trickle Ventilation:	2500mm <sup>2</sup> per room
Lintel:	To engineer details
Ironmongery:	

Type QQ:	WG 1.B
Str Opening: (w/h)	1300 x 1038 mm
Frame:	Sapele
Finish:	Primed & painted
Window head:	none
Sill:	Portland stone
Sub-sill:	Iroko sub-sill primed and painted
Glazing:	Simlile 14mm double glazed units
Obscure:	none
U-Value:	1.4W/m <sup>2</sup> K
Egress:	-
Caseament:	Weighted sash
Trickle Ventilation:	2500mm <sup>2</sup> per room
Lintel:	To engineer details
Ironmongery:	

Also at:  
Norwich  
London

**Chaplin Farrant**  
Architect  
Wiltshire Limited

Bank Chambers  
69 High Street  
10, 11, 12  
Hamphire  
SO23 9DA

Tel: 01962 862334  
Fax: 01962 840596  
email: studio@cfwarchitects.com  
www.cfwarchitects.com

This drawing is copyright of the Architects and shall not be reproduced without their permission.

Check all dimensions and report any errors or omissions.