

KEY:

APPROX RIDGE HEIGHT
 3205
 FFL 03
 2520
 FFL 02
 900
 FLAT ENTRANCE LEVEL

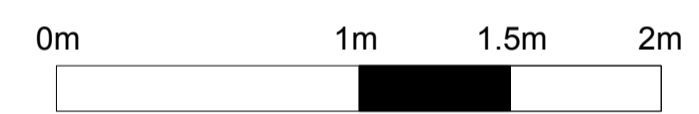
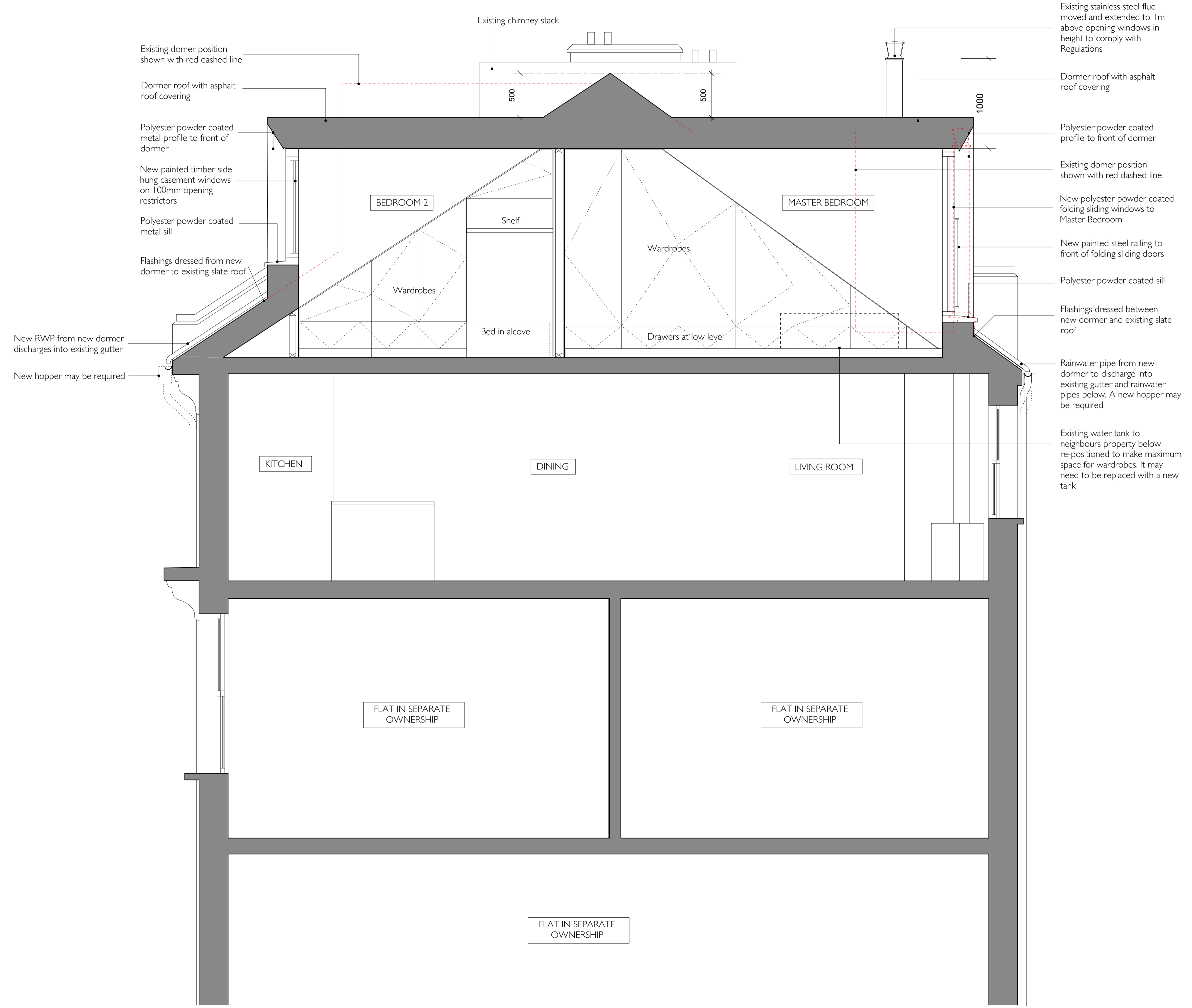

NOTES:
 - DO NOT SCALE FROM THIS DRAWING USE FIGURED DIMENSIONS ONLY
 - ALL DIMENSIONS ARE TO BE CHECKED ON SITE BY THE CONTRACTOR AND SUCH DIMENSIONS ARE TO BE THEIR RESPONSIBILITY
 - THIS DRAWING SHOULD NOT BE USED TO CALCULATE AREAS FOR THE PURPOSES OF VALUATION
 - REPORT ANY DISCREPANCIES, DRAWING ERRORS AND OMISSIONS TO THE ARCHITECT IMMEDIATELY
 - ALL STRUCTURAL ELEMENTS ARE TO BE DESIGNED BY THE STRUCTURAL ENGINEER
 - ALL WORK MUST COMPLY WITH RELEVANT BRITISH STANDARDS AND BUILDING REGULATIONS REQUIREMENTS

REVISIONS:
 A 15/7/14 Design updated following Pre-Planning advice

COPPIN DOCKRAY ARCHITECTS
 56 Highpoint North Hill Highgate London N6 4AZ
 Bev Dockray 07904 920 144
 Sandra Coppin 07906 025 428
 mail@coppindockray.co.uk
 www.coppindockray.co.uk

Drawing No. 1301-GA-012
 Title Proposed Section C-C
 Rev A

SCALE @ A1: 1:25 1:50 @ A3 STATUS: PRELIMINARY
 DATE: 11.03.13 DRAWN BY: BD
 JOB NUMBER: 1301 CHECKED BY: SC

GA-012 - PROPOSED SECTION C-C 1:25