

EXISTING MOULDED TIMBER CORNICE & WALL PANELLING AND FIREPLACE SURROUND TO BE RETAINED AS EXISTING/OVERHAULED AND CLEANED

NEW MOULDED TIMBER CORNICE TO MATCH EXISTING AND SCRIBED TO EXISTING ORIGINAL

EXISTING CEILING LEVELED UP MADE GOOD WHERE EXISTING CUPBOARDS REMOVED

WEST ELEVATION (SOUTH END) TO ROOM 42 RETAINED AS EXISTING

OFFICE 51 WALL PANEL

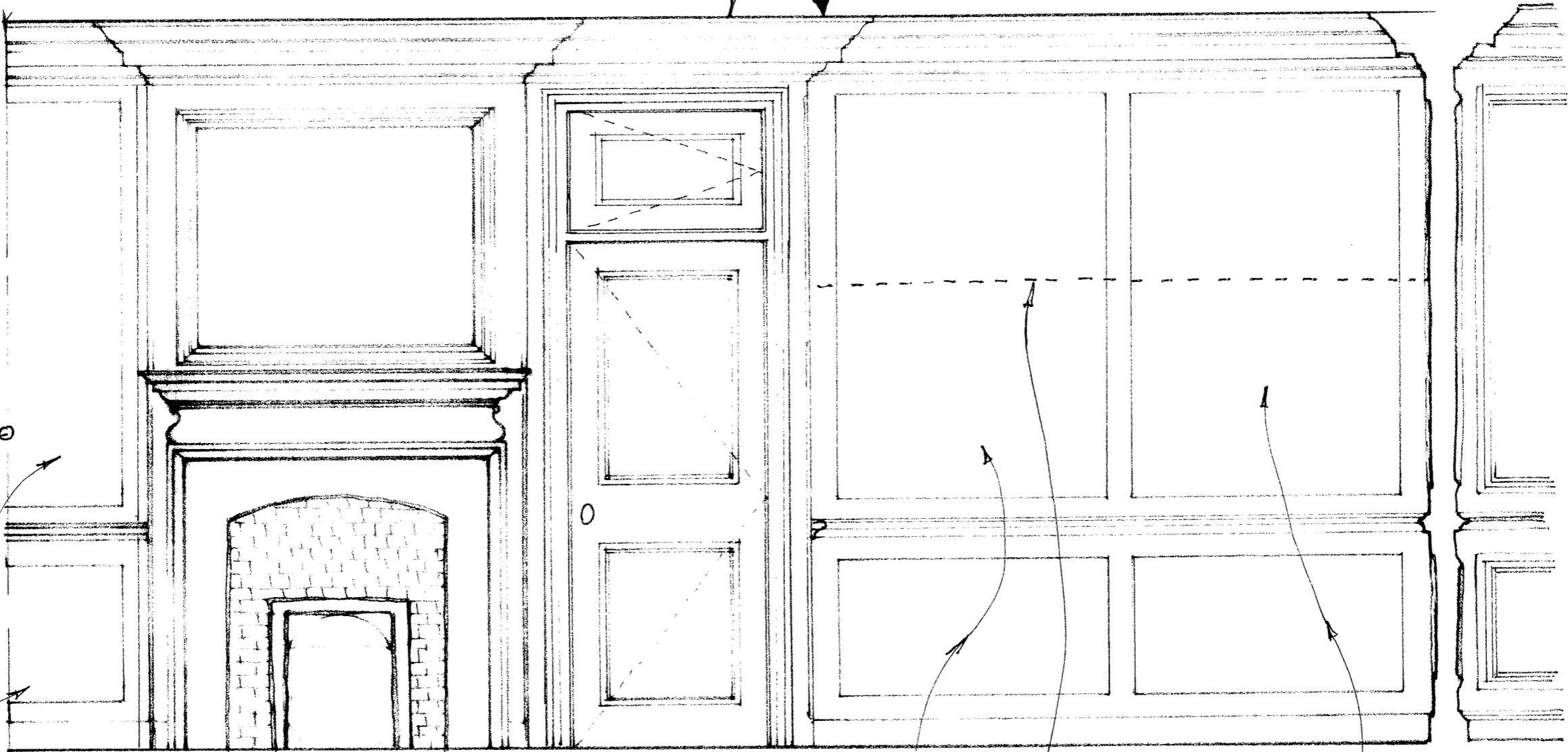

WEST WALL ELEVATION TO OFFICE 42, NORTH END

3mm PLYWOOD/HARDBOARD OVERLAY TO ORIGINAL WALL PANELLING TO BE REMOVED TO CHECK ORIGINAL WALL PANELLING AND EXISTING PANELLING OVERHAULED/REPAIRED OR OVERCLAD PLYWOOD PANELS TO MATCH EXISTING PATTERN

EXISTING CUPBOARDS REMOVED AND 3mm PLYWOOD/HARDBOARD OVERLAY TO ORIGINAL WALL PANELLING TO BE REMOVED TO CHECK ORIGINAL WALL PANELLING AND EXISTING PANELLING OVERHAULED/REPAIRED OR OVERCLAD PLYWOOD PANELS TO MATCH EXISTING PATTERN

No 7 GRAYS INN SQUARE
 FOR THE HONOURABLE SOCIETY OF GRAYS INN
 PROPOSED WEST ELEVATION - SOUTH OFFICE GROUND FLOOR.

GHK ARCHITECTS
 Architects · Designers · Historic Building Specialists
 530 Fulham Road, London SW6 5NR
 Tel +44 (0)20 7471 8000 mail@ghkarchitects.co.uk
 www.ghkarchitects.co.uk

DWG NO : HK 2065/01.183
 SCALE : 1:20 D.A.S.
 DATE : 26 FEB 2014
 DRAWN : AM, LM