

Responsibility is not accepted for errors made by others in scaling from this drawing. All construction information should be taken from figured dimensions only.

0mm 50mm 100mm

A1 Original Sheet Size

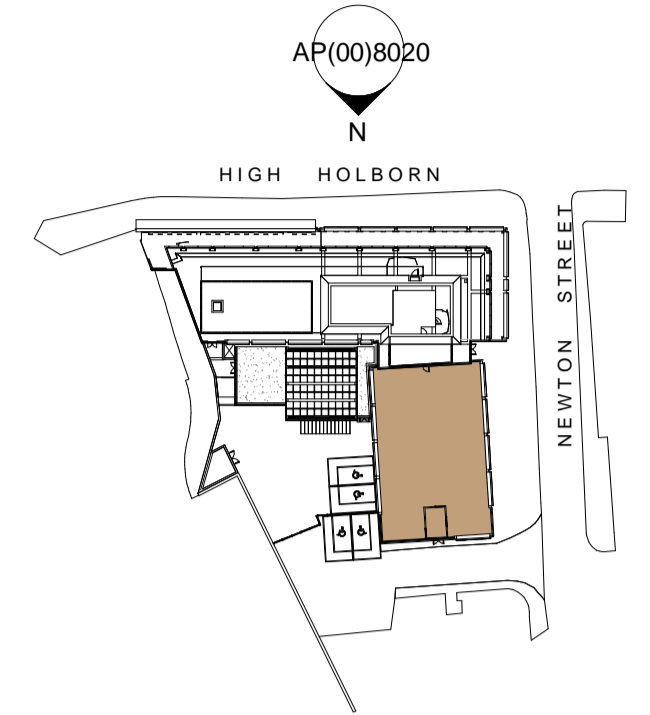

KEY PLAN

C
AR(00)80.02

C
AR(00)80.02



- ▼ Top of Plant Screen
25500
- ▼ Roof (Proposed FFL)
22550
- ▼ Roof (Existing FFL)
22500
- ▼ Fifth Floor (Proposed FFL)
19200
- ▼ Fifth Floor (Existing FFL)
18900
- ▼ Fourth Floor (Proposed FFL)
15600
- ▼ Fourth Floor (Existing FFL)
15300
- ▼ Third Floor (Proposed FFL)
12000
- ▼ Third Floor (Existing FFL)
11700
- ▼ Second Floor (Proposed FFL)
8400
- ▼ Second Floor (Existing FFL)
8100
- ▼ First Floor (Proposed FFL)
4800
- ▼ First Floor (Existing FFL)
4500
- ▼ Ground Floor (Proposed FFL)
50
- ▼ Ground Floor (Existing FFL)
0
- ▼ Basement (Proposed FFL)
-3700
- ▼ Basement (Existing FFL)
-3750

N NORTH ELEVATION
1 : 100

13.05.13	A	DW	AB	PLANNING ISSUE
date	rev	name	chk	note

© Stride Treglown Limited 2012.

Stride Treglown

Architecture Town Planning Interior Design Building Surveying Landscape Design Graphic Design
3 Cosser Street, London, SE1 7BU
T 020 7401 0700 F 020 7401 0701 www.stride-treglown.co.uk

PROJECT
HOXTON HOTEL
199-206 HIGH HOLBORN
LONDON WC1V 7BU

DRAWING TITLE
NORTH ELEVATION (PROPOSED)

STATUS			
INFORMATION			
SCALE	DATE	DRAWN BY	CHECKED BY
As indicated	JAN 2013	DW	AB
PROJECT NUMBER	DRAWING NUMBER	REVISION	
20918	AP(00)8020	A	