

Existing Basement Plan

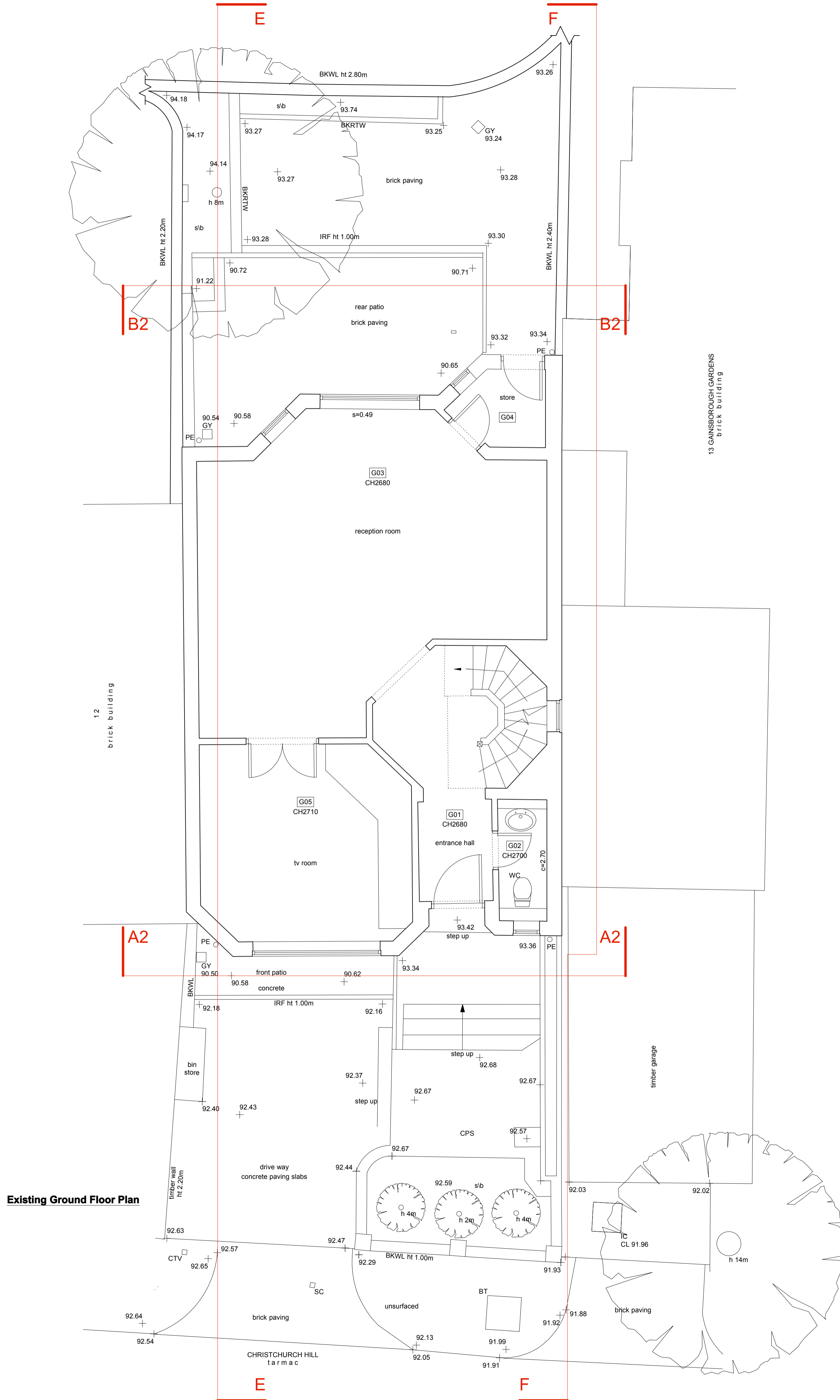

Existing Ground Floor Plan

Do not scale from this drawing.
The contractor to check all dimensions on site.
All discrepancies to be reported to the contract administrator.

NOTES:
Area to be demolished

PROJECT:	Alteration & Extension 10 Christchurch Hill NW3 1LB	WORK STAGE:	Planning
CLIENT:	Mr Nadir Khamissa 10 Christchurch Hill London NW3 1LB	JOB No:	1208A
DRAWING TITLE:	Existing Basement & Ground Floor Plan Areas To Be Demolished	DATE:	29.01.14
		CHECKED BY:	AG
		SCALE:	1:100@A1
		DRAWING No:	PL_SK001
		REVISION No:	N/A
		Issue to:	CL

ashton porter
architects
ajb@ashton-porter.co.uk
andrew.porter@ucl.ac.uk

11 second avenue
bush hill park
enfield
middlesex
t: 020 8372 1619
f: 020 8372 1629