

Hatched area indicates part of ground floor which accommodates Charity Children with Cancer UK

EXISTING GROUND FLOOR PLAN

See drawing no CE/CA 0758/1 for views of the staircase

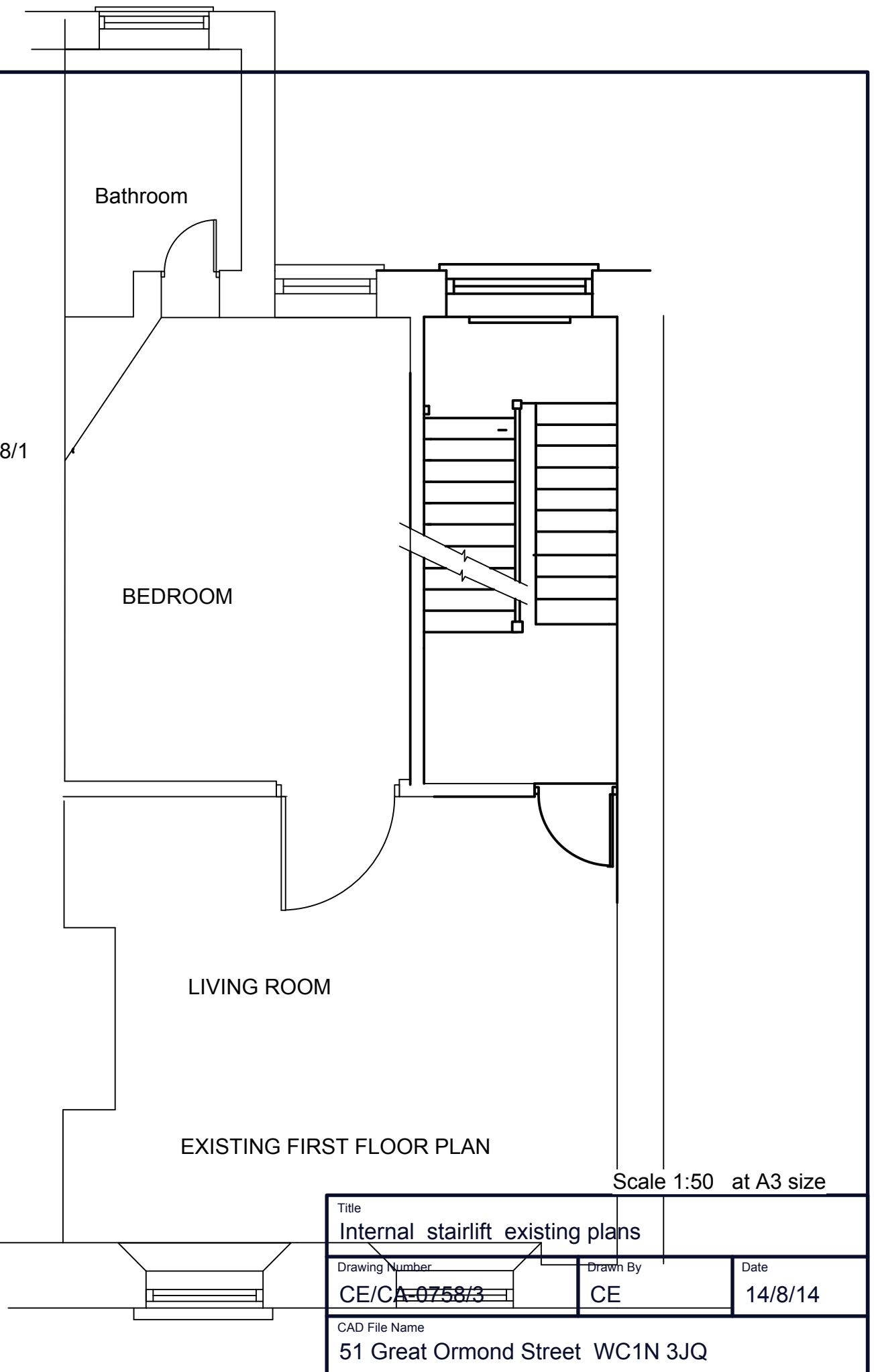

Bathroom

BEDROOM

LIVING ROOM

EXISTING FIRST FLOOR PLAN

Scale 1:50 at A3 size

Title Internal stairlift existing plans		
Drawing Number CE/CA-0758/3	Drawn By CE	Date 14/8/14
CAD File Name 51 Great Ormond Street WC1N 3JQ		

N-C-C