

End of wagon to be clad: 18mm PLY (By CSE)
Allowance for 6mm Hardboard & 20mm OAK (By Others)

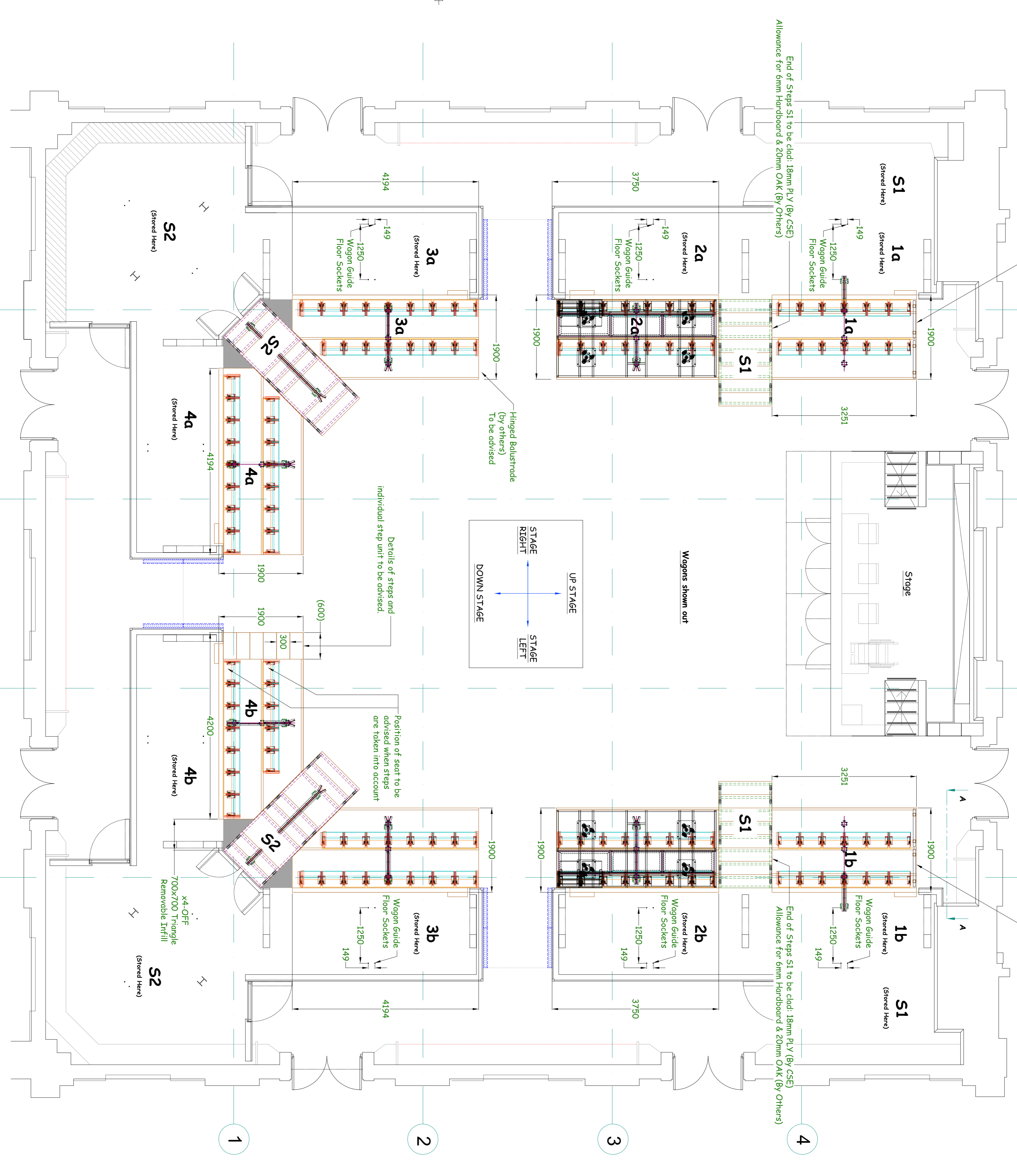

Seating Wagon Operation
The compressor is attached to the wagon via a pvc male connector filling station. The wagon is filled with air and can then be moved around on the turtle castors to its new position. Once positioned the air is released and the wagon then rests on the base frame to help distribute the entire load evenly to a larger area.

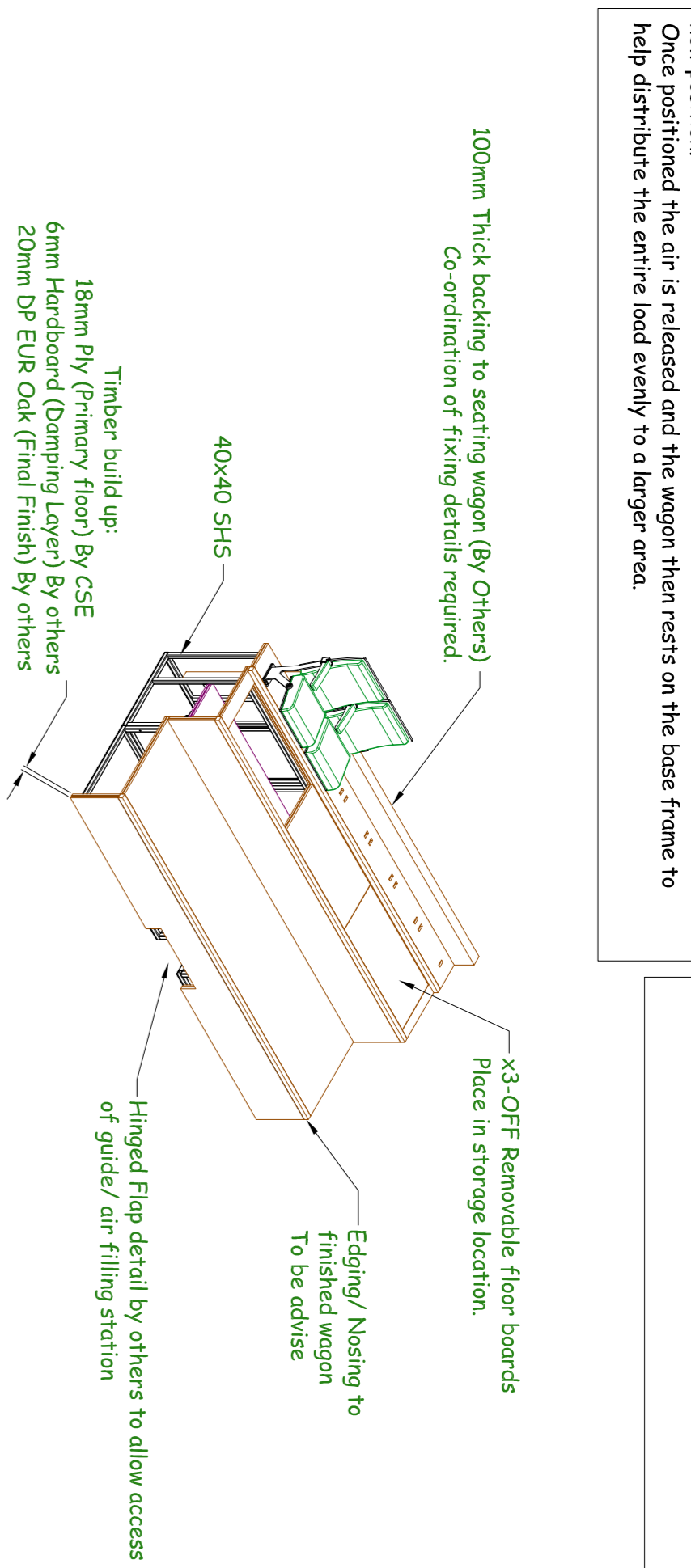

Typical Detailed View - (Wagon 2a Shown)
 QTY: x8-OFF Wagons total
 (1a, 1b, 2a, 2b, 3a, 3b, 4a & 4b)
 Finish: Steelwork = Matt Black
 18mm Ply by CSE other timber works by others

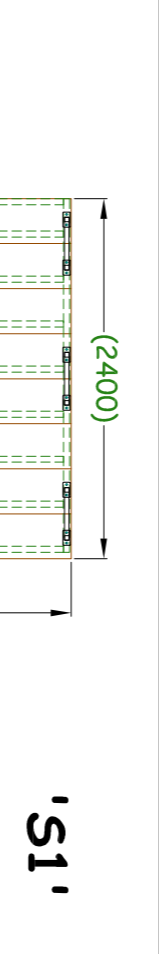
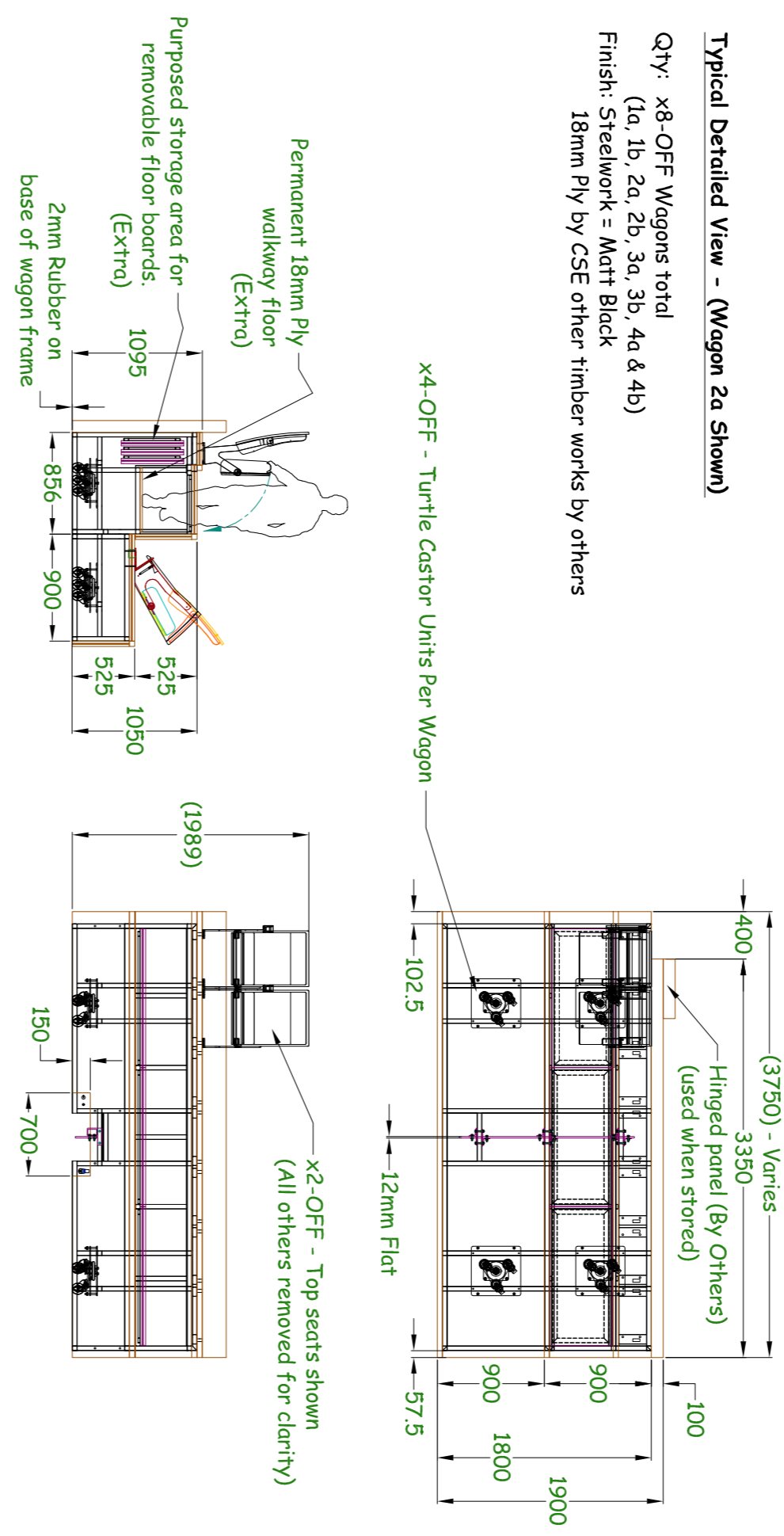

Typical Detailed View - (Step Units 'S1')
 QTY: x2-OFF Steps total
 Finish: Steelwork = Matt Black
 18mm Ply by CSE other timber works by others

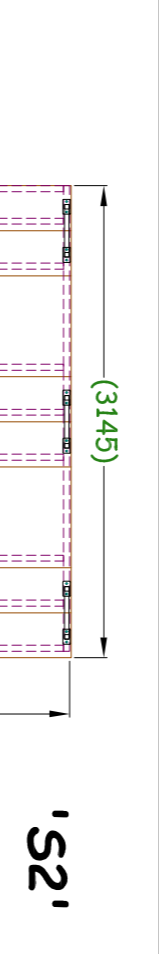

Typical Detailed View - (Step Units 'S2')
 QTY: x2-OFF Steps total
 Finish: Steelwork = Matt Black
 18mm Ply by CSE other timber works by others

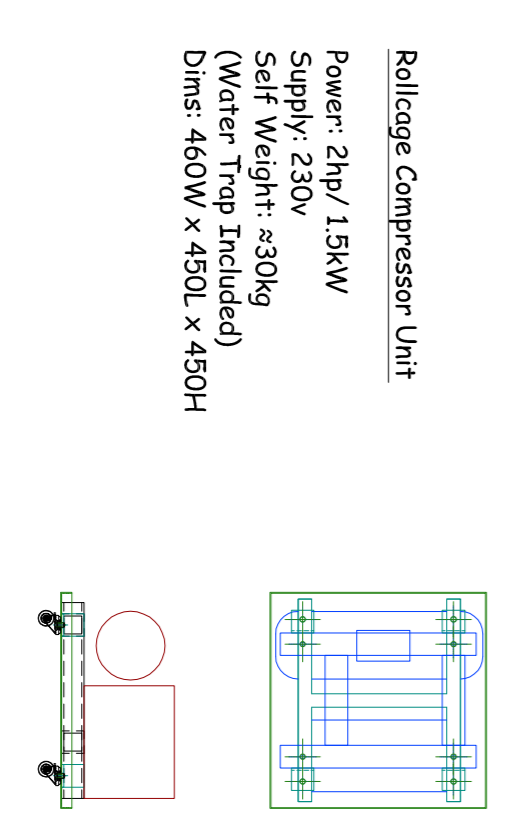

FABRICATED MILD STEEL ITEMS TO BE FINISHED POWDER COATED MATT BLACK, UNLESS OTHERWISE STATED.
FINAL DESIGN AND DIMENSIONS ARE REFERENCE ONLY AND ARE PENDING SITE SURVEY.
NYLON UNLESS OTHERWISE STATED TO BE DARK GREY OR BLACK IN COLOUR.

CENTRE STAGE ISSUED FOR APPROVAL
 28/07/2014
 RETURN COMMENTS/ APPROVAL TO CENTRE STAGE DRAWING OFFICE VIA EMAIL: drawings@centre-stage.co.uk

STATUS

REVISION	DATE	BY	DESCRIPTION
1	28/07/14	1350	01-08-14

<p>REMOVE ALL DIMENSIONS AND SHAPE CODES DO NOT SCALE ALL DIMENSIONS IN MM OTHER DIMENSIONS STATED: X.X - 1/10.0 X.X - 1/1.000 X.X - 1/1.000</p> <p>DATE: 28/07/14 TIME: 1350 DRAWN BY: 1350 CHECKED BY: 1350 PROJECT: Seating Wagons & Steps SHEET: 1 of 2</p>	<p>STATUS</p> <p>C</p> <p>NA = PARTS DRAWING # = MANUFACTURING STATION A = MANUFACTURE BUT WITH COMMENTS C = DO NOT MANUFACTURE</p>
--	---