

FRIENDS HOUSE

PROPOSED JOINERY FINISHES IMAGES

AUGUST 2014

PROPOSED JOINERY FINISHES | LARGE MEETING HOUSE - GROUND FLOOR

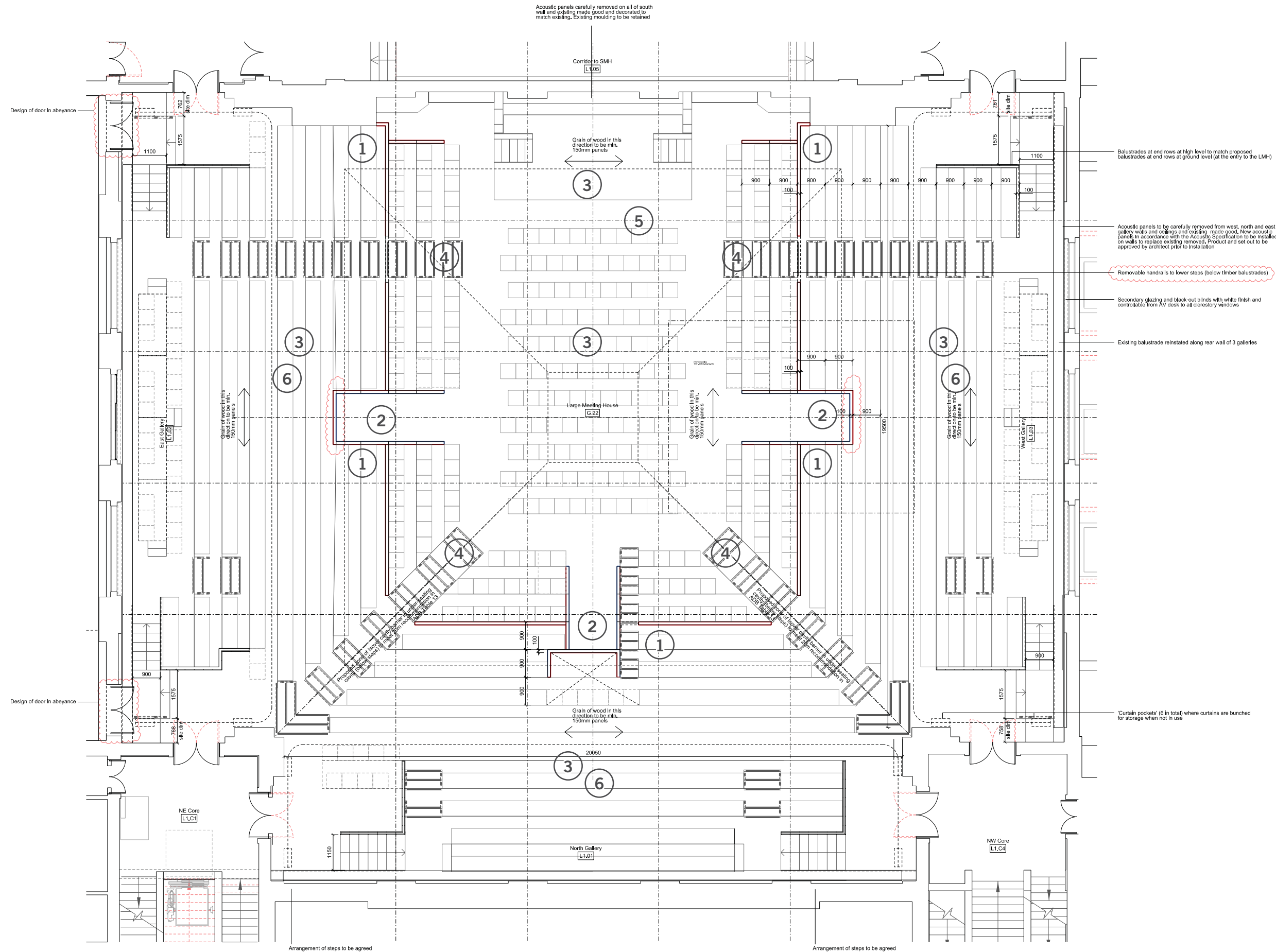

KEY

- ① 16mm thick x 32mm wide oak veneer acoustic panelling
- ② 16mm thick x 8mm wide oak veneer acoustic panelling
- ③ 20mm DPEUR Oak engineered timber flooring, Grotto colour
- ④ Dark oak nosings to stairs to match existing oak
- ⑤ Oak panelling to stage to match flooring
- ⑥ Timber Seating

Balustrades at end rows at high level to match proposed balustrades at end rows at ground level (at the entry to the LMH)

Acoustic panels to be carefully removed from west, north and east gallery walls and ceilings and existing made good. New acoustic panels in accordance with the Acoustic Specification to be installed on walls to replace existing removed. Product and set out to be approved by architect prior to installation

Removable handrails to lower steps (below timber balustrades)

Secondary glazing and black-out blinds with white finish and controls from AV desk to all clerestory windows

Existing balustrade reinstated along rear wall of 3 galleries

'Curtain pockets' (6 in total) where curtains are bunched for storage when not in use

Arrangement of steps to be agreed

Arrangement of steps to be agreed

PROPOSED JOINERY FINISHES | LARGE MEETING HOUSE - SECTION

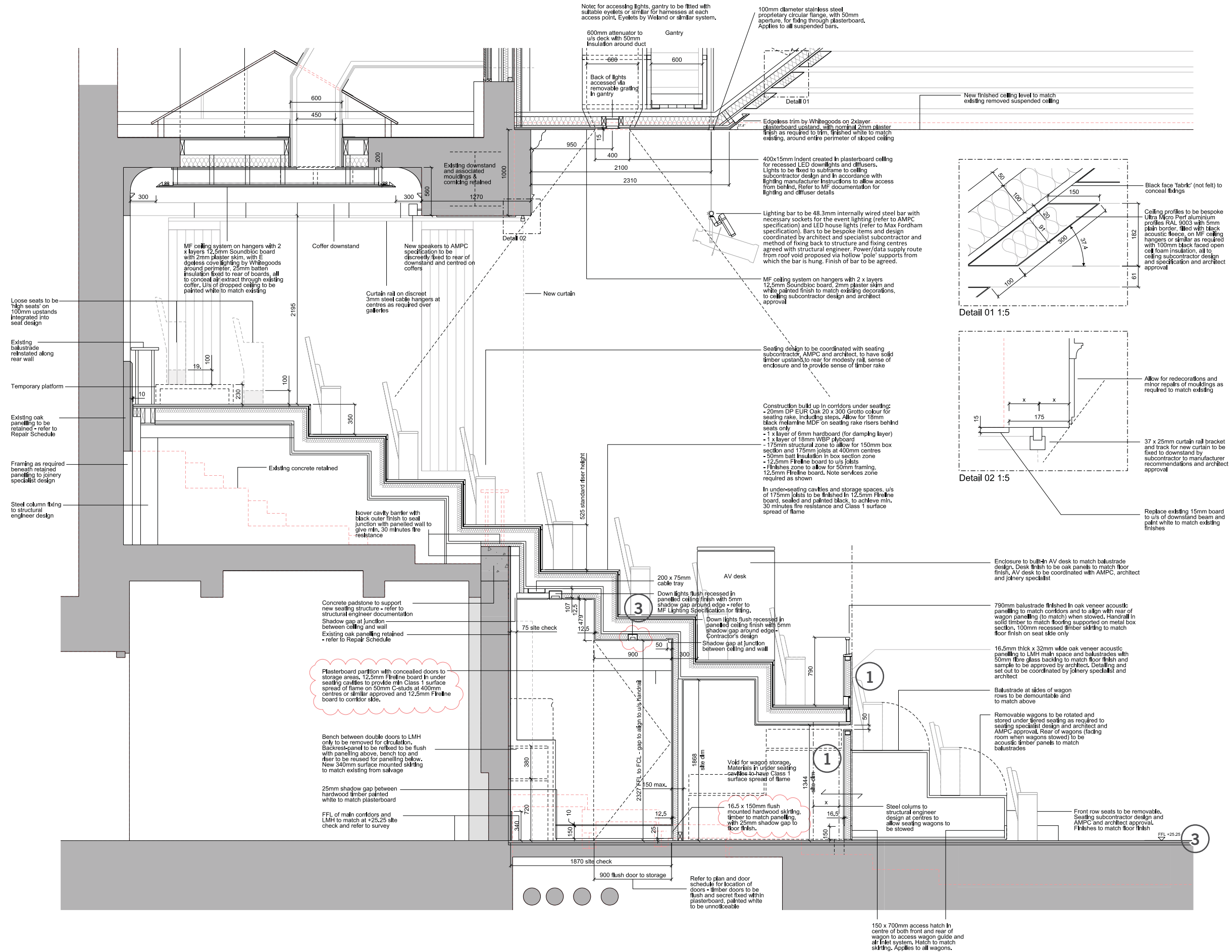

KEY

- ① 16mm thick x 32mm wide oak veneer acoustic panelling
- ② 16mm thick x 8mm wide oak veneer acoustic panelling
- ③ 20mm DPEUR Oak engineered timber flooring, Grotto colour
- ④ Dark oak nosings to stairs to match existing oak
- ⑤ Oak panelling to stage match flooring
- ⑥ Timber seating

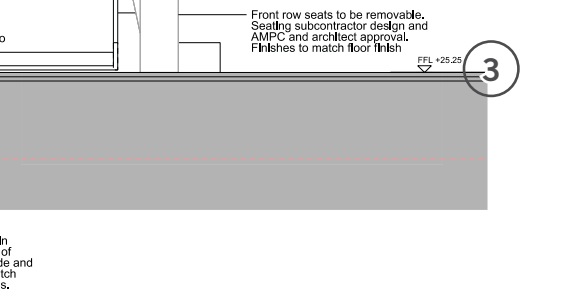
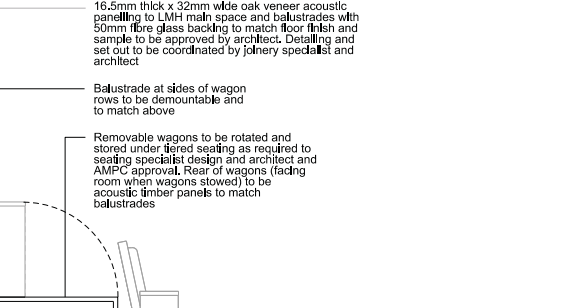
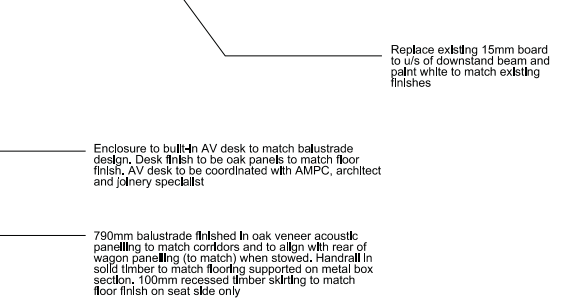
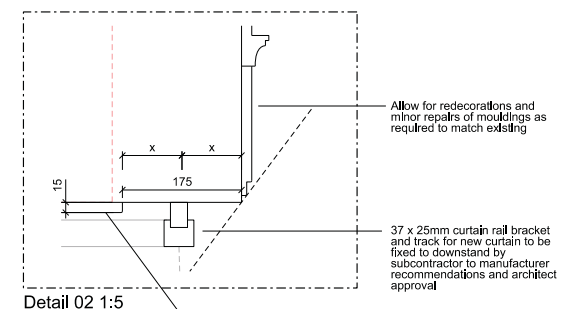
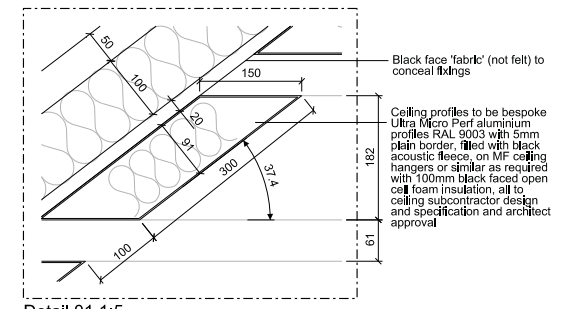

PROPOSED JOINERY FINISHES | IMAGES

The images below are of the joinery finishes. The new timber finishes are in a lighter oak to create a contrast between the existing dark oak panelling and the proposed works.

KEY

- ① 16mm thick x 32mm wide oak veneer acoustic panelling
- ② 16mm thick x 8mm wide oak veneer acoustic panelling
- ③ 20mm DP EUR Oak engineered timber flooring, Grotto colour
- ④ Dark oak nosings to stairs to match existing oak
- ⑤ Oak panelling to stage to match flooring
- ⑥ Timber seating



Timber seating sample



Existing timber panelling to be retained. Timber nosing to steps to match existing panelling to provide contrast with treads and risers.



Large scale samples available at Friends House of the 8mm wide acoustic panelling (left), 32mm wide acoustic panelling (right) and the flooring (bottom) showing the close match between the oak colouring.

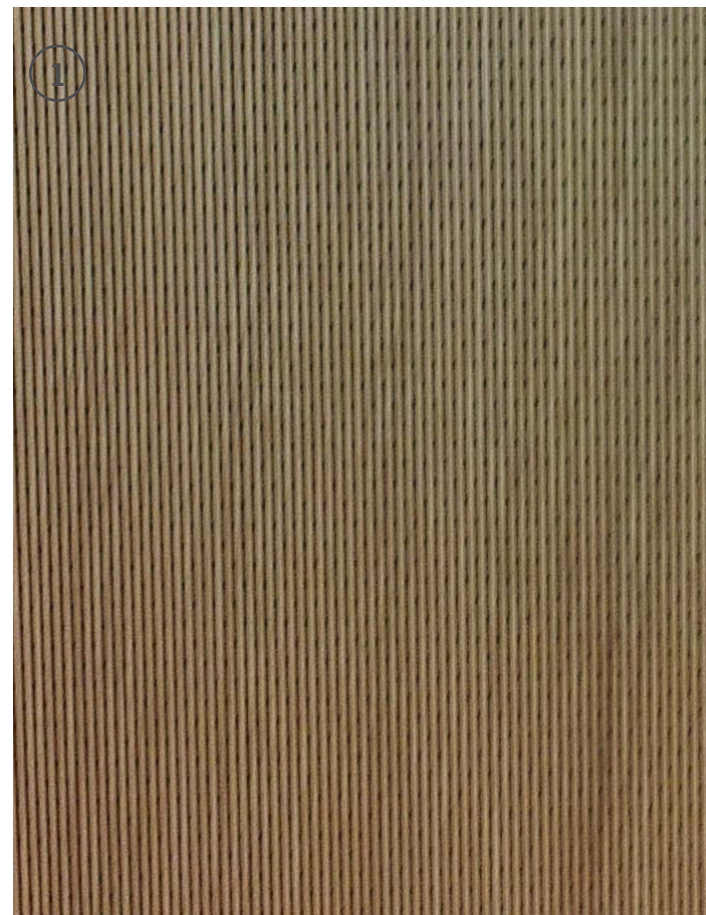

Detail photograph of 8mm oak veneer acoustic panelling.

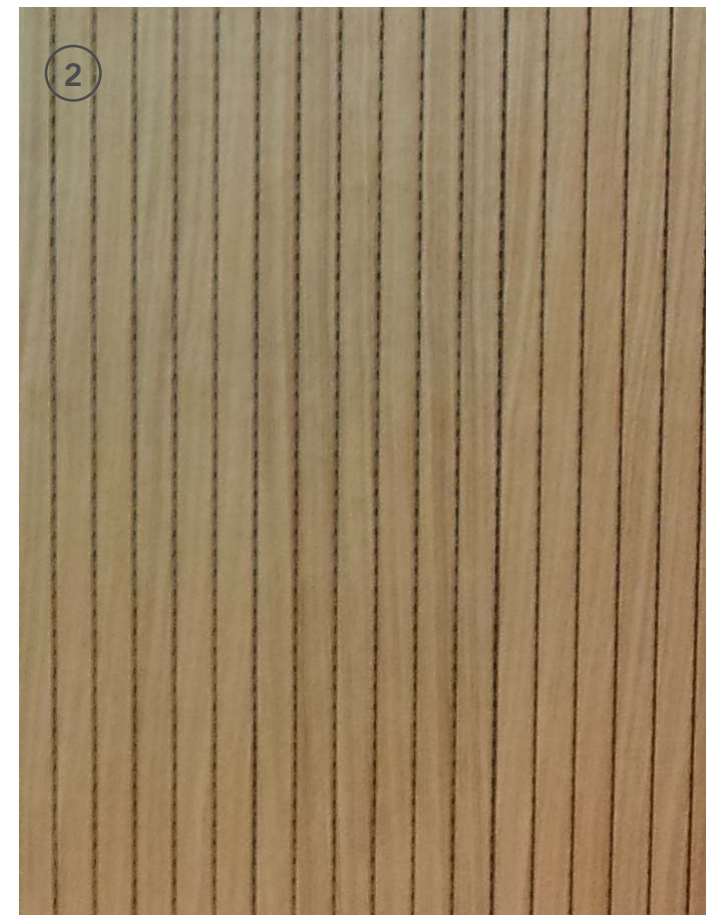

Detail photograph of 32mm oak veneer acoustic panelling.



20mm DP EUR Oak engineered timber flooring, Grotto colour proposed to be used for all flooring and steps in the Large Meeting House.