

Note: for accessing lights, gantry to be fitted with suitable eyelets or similar for harnesses at each access point. Eyelets by Weland or similar system.

100mm diameter stainless steel proprietary circular flange, with 50mm aperture, for fixing through plasterboard. Applies to all suspended bars.

600mm attenuator to u/s deck with 50mm insulation around duct

Gantry

Detail 01

New finished ceiling level to match existing removed suspended ceiling

Edgeless trim by Whitegoods on 2x layer plasterboard upstand, with nominal 2mm plaster finish as required to trim, finished white to match existing, around entire perimeter of sloped ceiling

400x15mm indent created in plasterboard ceiling for recessed LED downlights and diffusers. Lights to be fixed to subframe to ceiling subcontractor design and in accordance with lighting manufacturer instructions to allow access from behind. Refer to MF documentation for lighting and diffuser details

Lighting bar to be 48.3mm internally wired steel bar with necessary sockets for the event lighting (refer to AMPC specification) and LED house lights (refer to Max Fordham specification). Bars to be bespoke items and design coordinated by architect and specialist subcontractor and method of fixing back to structure and fixing centres agreed with structural engineer. Power/data supply route from roof void proposed via hollow 'pole' supports from which the bar is hung. Finish of bar to be agreed.

MF ceiling system on hangers with 2 x layers 12.5mm Soundbloc board, 2mm plaster skim and white painted finish to match existing decorations, to ceiling subcontractor design and architect approval

Seating design to be coordinated with seating subcontractor, AMPC and architect, to have solid timber upstand to rear for modesty rail, sense of enclosure and to provide sense of timber rake

Construction build up in corridors under seating:
 - 20mm DP EUR Oak 20 x 300 Grotto colour for seating rake, including steps. Allow for 18mm black melamine MDF on seating rake risers behind seats only
 - 1 x layer of 6mm hardboard (for damping layer)
 - 1 x layer of 18mm WBP plywood
 - 175mm structural zone to allow for 150mm box section and 175mm joists at 400mm centres
 - 50mm batt insulation in box section zone
 - 12.5mm Fireline board to u/s joists
 - Finishes zone to allow for 50mm framing, 12.5mm Fireline board. Note services zone required as shown

In under-seating cavities and storage spaces, u/s of 175mm joists to be finished in 12.5mm Fireline board, sealed and painted black, to achieve min. 30 minutes fire resistance and Class 1 surface spread of flame

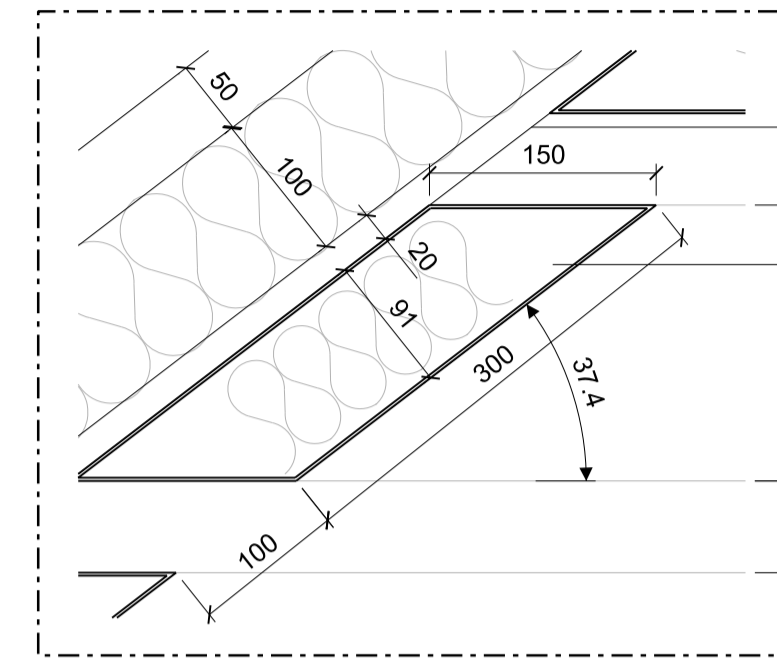

Detail 01 1:5

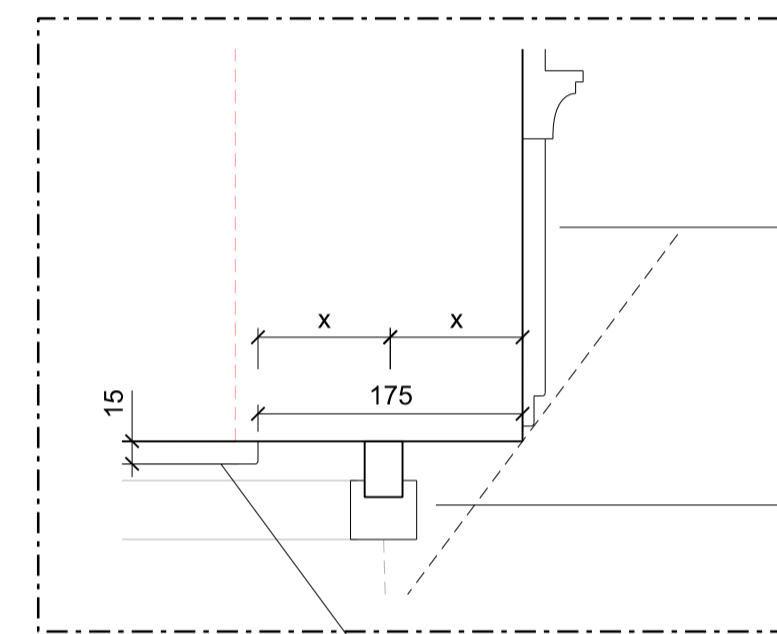

Detail 02 1:5

Black face 'fabric' (not felt) to conceal fixings

Ceiling profiles to be bespoke Ultra Micro Perf aluminium profiles RAL 9003 with 5mm plain border, filled with black acoustic fleece, on MF ceiling hangers or similar as required with 100mm black faced open cell foam insulation, all to ceiling subcontractor design and specification and architect approval

Allow for redecoration and minor repairs of mouldings as required to match existing

37 x 25mm curtain rail bracket and track for new curtain to be fixed to downstand by subcontractor to manufacturer recommendations and architect approval

Replace existing 15mm board to u/s of downstand beam and paint white to match existing finishes

Enclosure to built-in AV desk to match balustrade design. Desk finish to be oak panels to match floor finish. AV desk to be coordinated with AMPC, architect and joinery specialist

790mm balustrade finished in oak veneer acoustic panelling to match corridors and to align with rear of wagon panelling (to match) when stowed. Handrail in solid timber to match flooring supported on metal box section. 100mm recessed timber skirting to match floor finish on seat side only

16.5mm thick x 32mm wide oak veneer acoustic panelling to LMH main space and balustrades with 50mm fibre glass backing to match floor finish and sample to be approved by architect. Detailing and set out to be coordinated by joinery specialist and architect

Balustrade at sides of wagon rows to be demountable and to match above

Removable wagons to be rotated and stored under tiered seating as required to seating specialist design and architect and AMPC approval. Rear of wagons (facing room when wagons stowed) to be acoustic timber panels to match balustrades

Void for wagon storage. Materials in under seating cavities to have Class 1 surface spread of flame

16.5 x 150mm flush mounted hardwood skirting, timber to match panelling with 25mm shadow gap to floor finish

Steel columns to structural engineer design at centres to allow seating wagons to be stowed

Front row seats to be removable. Seating subcontractor design and AMPC and architect approval. Finishes to match floor finish

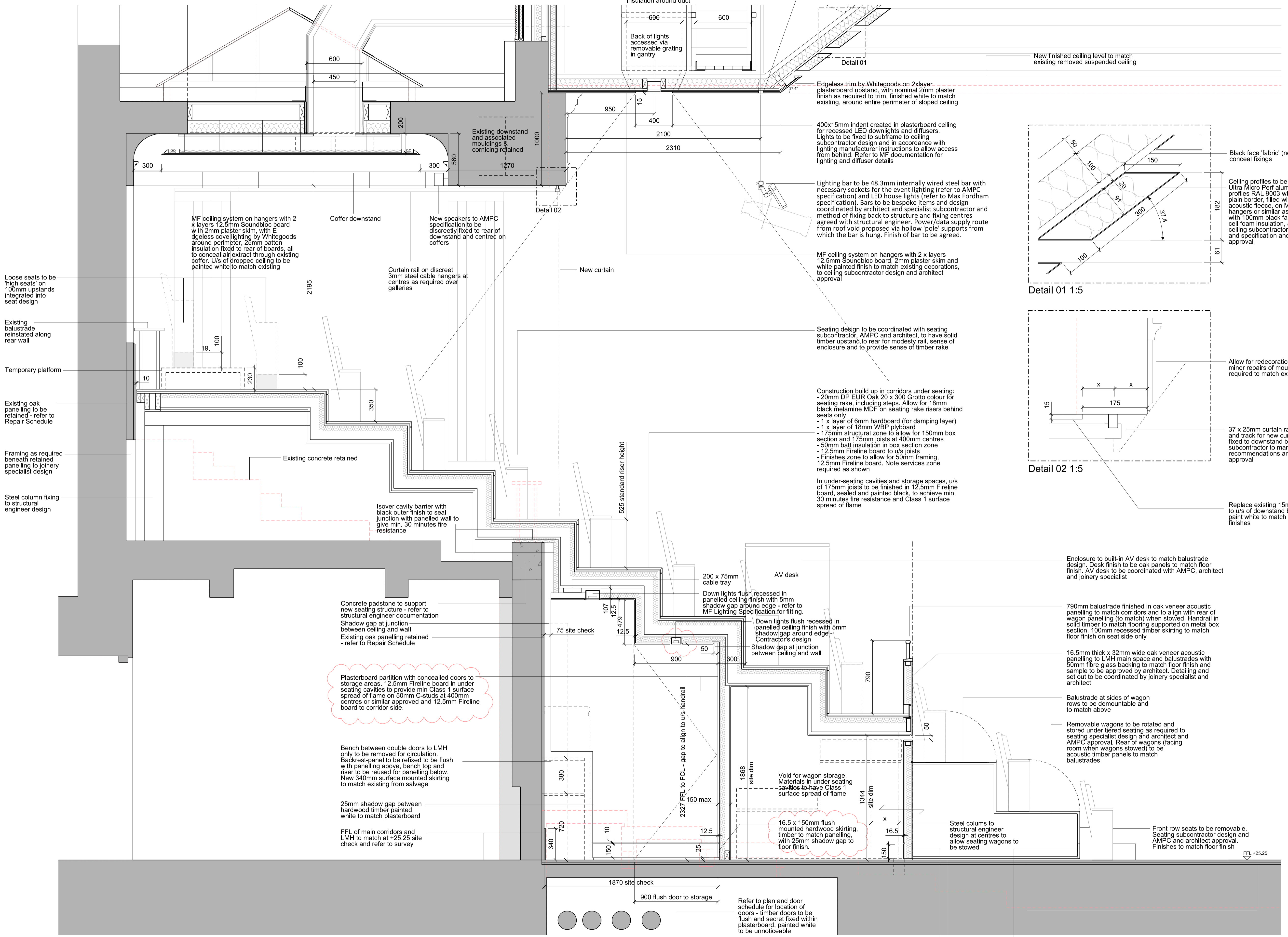

Loose seats to be 'high seats' on 100mm upstands integrated into seat design

Existing balustrade reinstated along rear wall

Temporary platform

Existing oak panelling to be retained - refer to Repair Schedule

Framing as required beneath retained panelling to joinery specialist design

Steel column fixing to structural engineer design

MF ceiling system on hangers with 2 x layers 12.5mm Soundbloc board with 2mm plaster skim, with E dgeless cove lighting by Whitegoods around perimeter, 25mm batten insulation fixed to rear of boards, all to conceal air extract through existing coffer. U/s of dropped ceiling to be painted white to match existing

Coffer downstand

New speakers to AMPC specification to be discreetly fixed to rear of downstand and centred on coffers

Curtain rail on discreet 3mm steel cable hangers at centres as required over galleries

New curtain

Existing concrete retained

Isover cavity barrier with black outer finish to seal junction with panelled wall to give min. 30 minutes fire resistance

Plasterboard partition with concealed doors to storage areas. 12.5mm Fireline board in under seating cavities to provide min Class 1 surface spread of flame on 50mm C-studs at 400mm centres or similar approved and 12.5mm Fireline board to corridor side.

Bench between double doors to LMH only to be removed for circulation. Backrest-panel to be refixed to be flush with panelling above, bench top and riser to be reused for panelling below. New 340mm surface mounted skirting to match existing from salvage

25mm shadow gap between hardwood timber painted white to match plasterboard

FFL of main corridors and LMH to match at +25.25 site check and refer to survey

Refer to plan and door schedule for location of doors - timber doors to be flush and secret fixed within plasterboard, painted white to be unnoticeable

150 x 700mm access hatch in centre of both front and rear of wagon to access wagon guide and air inlet system. Hatch to match skirting. Applies to all wagons.

Project Logo

Notes
 Do not scale from this drawing.
 All dimensions are to be checked on site and any discrepancies noted in writing to the Project Manager.
 All dimensions are in millimeters unless noted otherwise.

Rev.	Date	Description	Drawn	Checked
-	14.05.13	Construction Issue	JMP	JMP
01	15.05.14	Construction Issue	JMP	JMP
02	16.06.14	Construction Issue	JMP	JMP
03	18.07.14	Construction Issue	JMP	JMP

JOHN McASLAN + PARTNERS
 7-9 William Road
 London NW1 3ER
 T +44 (0)20 7313 6000
 F +44 (0)20 7313 6001
 www.mcaslan.co.uk

Architect
 Landscape

Key Plan

Friends House, 173 Euston Road.

Section through Seating - Proposed

Scale At A1: 1:20
 Date: 04/09/12
 Drawing Status: CONSTRUCTION
 Drawing Number: 1371-G300-S-01-01

Job Number: 1371
 Drawing: JMP
 Checked: JMP
 Revision: 03