

- Cupboard with lock, white melamine MDF finish
- Brass cabinet pull handle
- 100mm black Melamine MDF skirting
- 30mm solid oak corners with 5mm shadow gap to painted plyboard
- Plyboard, painted white eggshell
- Cupboard with lock, white melamine MDF finish

01 Elevation C
Reception Desk Details

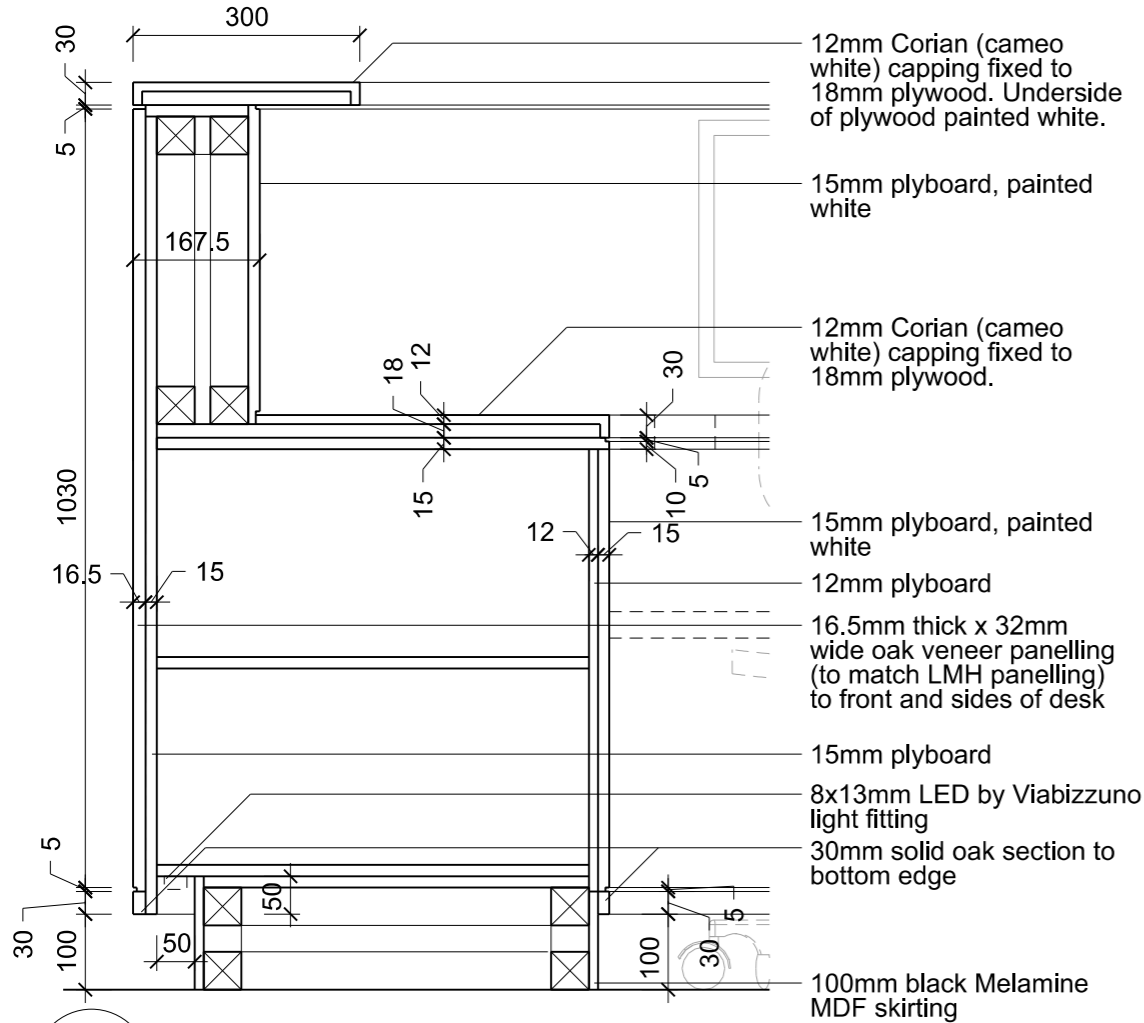

- 12mm Corian (cameo white) capping fixed to 18mm plywood. Underside of plywood painted white.
- 15mm plyboard, painted white
- 12mm Corian (cameo white) capping fixed to 18mm plywood.
- 15mm plyboard, painted white
- 12mm plyboard
- 16.5mm thick x 32mm wide oak veneer panelling (to match LMH panelling) to front and sides of desk
- 15mm plyboard
- 8x13mm LED by Viabizzuno light fitting
- 30mm solid oak section to bottom edge
- 100mm black Melamine MDF skirting

02 Section through cupboard
Reception Desk Details

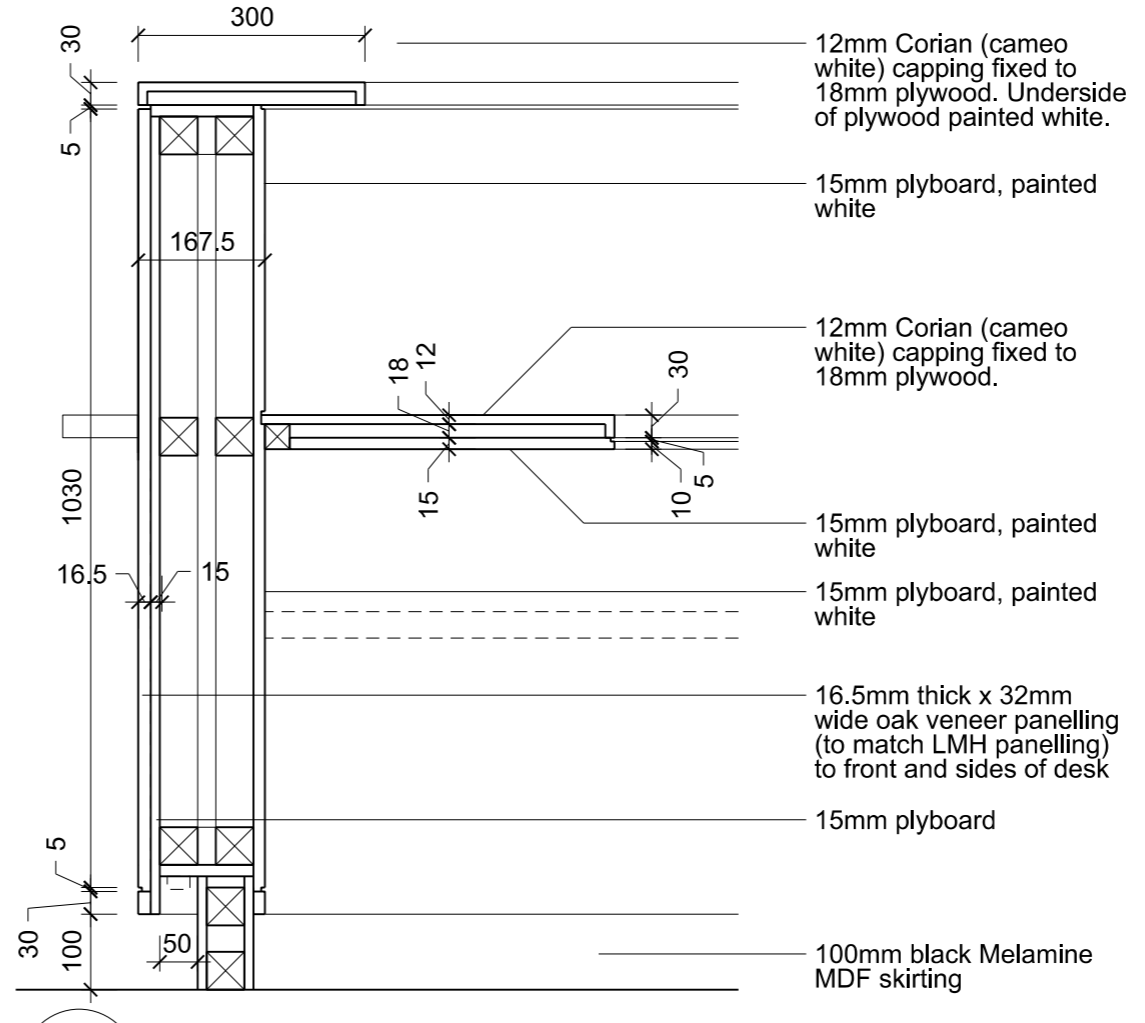

- 12mm Corian (cameo white) capping fixed to 18mm plywood. Underside of plywood painted white.
- 15mm plyboard, painted white
- 12mm Corian (cameo white) capping fixed to 18mm plywood.
- 15mm plyboard, painted white
- 15mm plyboard, painted white
- 16.5mm thick x 32mm wide oak veneer panelling (to match LMH panelling) to front and sides of desk
- 15mm plyboard
- 100mm black Melamine MDF skirting

03 Section through counter
Reception Desk Details

Notes

Do not scale from this drawing.

All dimensions are to be checked on site and any discrepancies noted in writing to the Project Manager.

All dimensions are in millimeters unless noted otherwise.

Rev.	Date	Description	Drawn	Checked
00	18.07.14	For Construction	LB	JD

JOHN MCASLAN + PARTNERS

7-9 William Road
London NW1 3ER
T +44 (0)20 7313 6000
F +44 (0)20 7313 6001
www.mcaslan.co.uk

- Architect
- Landscape

Friends House, 173 Euston Road

Reception Desk Details

Scale at A3: 1:10, 1:20	Job Number: 1371
Date: 17/07/2014	Drawing: LB
Status: For Construction	Checked: JD
Drawing No: 1371-G300-P-00-22	Revision: 00