

New oak panelling from salvaged oak under where existing stepped floor removed. Set out as per proposed panelling under benches in corridors under the seating

Refer to note left

Dashed red line shows outline of seating and steps when wagons out

30 x 30mm hardwood square corner piece, finish and chamfer edges to match panelling. Applies to all corner edging junctions in entry circulation corridors to joinery specialist detail and architect approval

Wagons to be fitted with doors (in panelling to match) to fold out when stowed to create continuous panelling - refer to 1371-G300-E-00-10

Propose wagons to be on guides for storage to Seating Subcontractor design and architect approval

Structural column layout. Refer to structural engineer drawings

Infill pieces required at corners to Seating Subcontractor design and architect approval

New timber shelves, finished black, to joinery specialist detail under retained benches for storage in area hatched. Applies to all benches in LMH G.18 - 21 storage spaces

Upper steps on all stowable steps to be dismantlable to allow suitable height for storage to Seating Subcontractor design and architect approval

LARGE MEETING HOUSE

Project Logo

Notes
Do not scale from this drawing.
All dimensions are to be checked on site and any discrepancies noted in writing to the Project Manager.
All dimensions are in millimeters unless noted otherwise.

Rev.	Date	Description	Drawn	Checked
-	14.05.13	Construction Issue	JMP	JMP
01	29.05.14	Construction Issue	JMP	JMP
02	18.07.14	Construction Issue	JMP	JMP

- KEY**
- All partitions and drylining to be installed in accordance with British Gypsum instructions, taped and jointed and painted to match existing unless specified.
- * site check dimensions
- IWS 01**
132mm partition to be 2 x layers of wall board (inner to be 12mm WBP plyboard) each side of 70mm Gyproframe C-studs at 600mm centres with 25mm Isover APR 1200 insulation in the cavity, by British Gypsum.
- IWS 02**
100mm (or as specified) Gypliner universal drylining with 2 x layers of wall board (inner to be 12mm WBP plyboard) fixed to 48mm c-studs at 600mm centres with 25mm Isover APR 1200 between studs, by British Gypsum.
- IWS 02a**
As IWS 02 but with outer layer as Gyproc moisture resistant board painted eggshell white to match existing or as specified.
- IWS 02b**
As IWS 02 but with outer layer as FireLine board painted eggshell white to match existing or as specified.
- IWS 03**
100mm partition to be 2 x layers of wall board (inner to be 12mm WBP plyboard, outer to be 12.5mm moisture resistant board) either side of 48mm c-studs at 600mm centres with 25mm Isover APR 1200 in the cavity, by British Gypsum. Painted eggshell white to match existing or as specified.
- IWS 04**
As IWS 03 but with outer layer as FireLine board.
- IWS 05**
Acoustic oak veneer partition & panelling with 50mm zone for subframe, insulation and black felt, fixed to timber stud frame to joinery specialist design, with 12.5mm FireLine board on inside (in the under-seating cavity) to give Class 1 rating and min. 30 minute fire resistance. Fireline painted black or as specified.
- IWS 06**
Refer to 1371-G300-S-01-04
- IWS 07**
Wall to match look of existing. Nominal 100mm blockwork wall with 12.5mm plasterboard finish to be agreed on site following opening up works with contractor, architect and engineer.
- IWS08**
Plasterboard partition with concealed doors to storage areas. 12.5mm Fireline board in under seating cavities to provide min Class 1 surface spread of flame on 50mm C-studs at 400mm centres or similar approved and 12.5mm Fireline board to corridor side.
- IWS 09**
12.5mm plasterboard lining over existing wall painted eggshell white to match existing or as specified.
- IWS 10**
12.5mm moisture board lining over existing wall painted eggshell white to match existing or as specified.
- IWS 11**
Anwell duct frame system.

JOHN McASLAN + PARTNERS

7-9 Wilam Road
London NW1 3ER
T +44 (0)20 7313 6000
F +44 (0)20 7313 6001
www.mcaslan.co.uk

Architect
Landscape

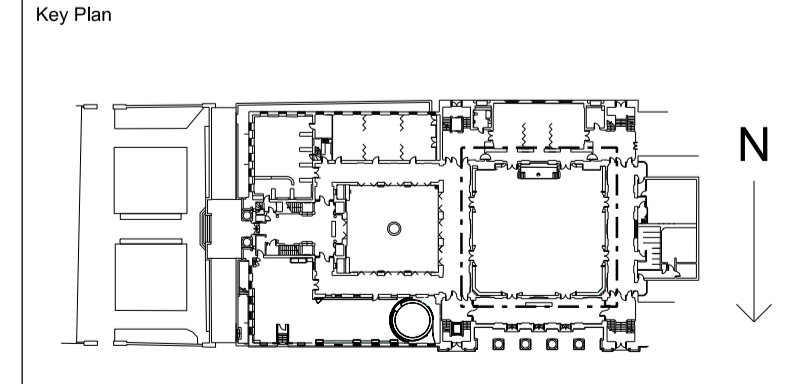

Friends House, 173 Euston Road.

Large Meeting House at Ground Floor - Wagons Stowed

Scale At A1:	1:50	Job Number:	1371
Date:	04/09/12	Drawing:	JMP
Drawing Status:	CONSTRUCTION	Checked:	JMP
Drawing Number:	1371-G300-P-00-06	Revision:	02