

PP 03588 299

	Sunfold House, Wymondham business Park, Chestnut Drive, Wymondham, Norfolk, NR18 9SB	SFK-69	V04/118
	Tel: 01953 423423 Fax: 01953 423430 E-mail: info@sunfold.com		

Semi weathered track, outside gasket seal and inside brush seal, top-hung - Opening Out

Client to sign to confirm
Ref. No:
Date:
Signature:
Print Name:

Outside

Inside

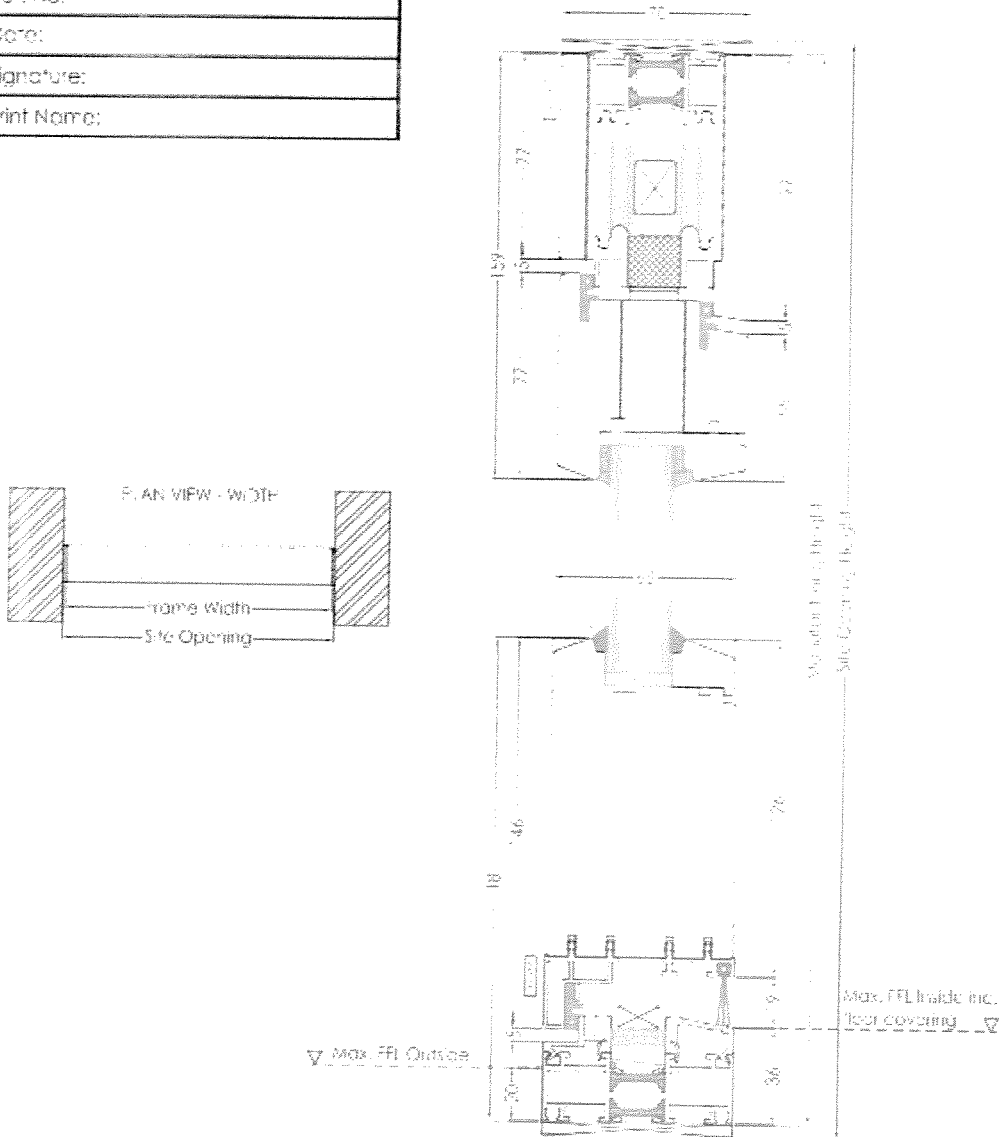

Laminated Timber Folding Sliding Door System

Timber	Standard	<ul style="list-style-type: none"> - Pine - Meranti
	Optional	<ul style="list-style-type: none"> - Oak
Timber Finish	Standard Options	<p>Fully factory finished in</p> <ul style="list-style-type: none"> - Sikkens Light Oak 006 Stain (Meranti) - Sikkens Dark Oak 009 Stain (Meranti) - Sikkens Mahogany 045 Stain (Meranti) - Sikkens Teak 085 Stain (Meranti) - White painted to RAL 9016 (Pine and Meranti)
	Optional	<p>Non stock wood stain or micro-porous RAL colour paint available on request Please contact your salesperson to discuss the available options</p>
Security & Ironmongery	Standard Options	<p>Pass Doors</p> <ul style="list-style-type: none"> - 3 point locking - High security cylinder locks (with 3 keys) - Magnetic panel catch - Handle Finish : Powder coated aluminium to black, white or silver finish <p>Remaining Pairs</p> <ul style="list-style-type: none"> - Internally operated handle which locates shoot-bolt into top & bottom tracks - Handle Finish : Powder coated aluminium to black, white or silver finish <p>Gaskets & Hinges</p> <ul style="list-style-type: none"> - Severe weather rated black finger safe gaskets & black anodised hinges
	Optional	<ul style="list-style-type: none"> - Additional keys £ 24.00 each Ex VAT - Key locking shoot-bolt handles £ 270.00 each Ex VAT - White or grey gaskets with satin silver anodised hinges
Track & Sill	Standard Options	<p>Suspension System</p> <ul style="list-style-type: none"> - Top hung - Bottom running (floor supported) <p>Track Option</p> <ul style="list-style-type: none"> - Fully weathered - Semi-weathered - Flush <p>Sill Option</p> <ul style="list-style-type: none"> - Thermally broken (150mm) projecting sill - 2mm aluminium sill pressing
	Optional	<p>Other glass specifications available on request, including integral venetian blinds Please contact your salesperson to discuss the available options</p>
Glazing	Standard	<p>28mm double glazed units consisting of</p> <ul style="list-style-type: none"> - Inside pane: 4mm clear toughened with low E coating - Cavity: 20mm argon gas filled, with black spacers - Outside pane: 4mm clear toughened
	Optional	<p>Other glass specifications available on request, including integral venetian blinds Please contact your salesperson to discuss the available options</p>
Ventilation	Standard	<p>No ventilation has been included as a standard option in this quotation Please contact your salesperson to discuss the available options</p>

107 South End Road
London NW3 2RT
10th August 2014

Camden Council Planning
- Development Control
Camden Council
Camden Town Hall
Tudor Street
London WC1H 8ND

Dear Sir

Planning Application PP-03588299

I refer to the above planning application which I have completed online. The portal would not accept my supporting documents in the format in which I could provide them so I am enclosing these with this letter. There are 3 copies of each document.

I also enclose a cheque for £172 for the planning application fee.

I look forward to hearing from you in due course.

Yours faithfully
Luida Passonage