

Note: The proposal does not cause any incursions into the Root Protection Areas of any retained trees at the site.

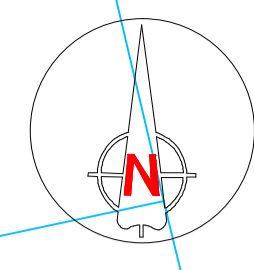

Tree Categories

Trees are categorised in accordance with the cascade chart in Table 1 of the British Standard BS 5837:2012 'Trees in relation to design, demolition and construction - Recommendations'

Category 'U' - Trees in such condition that they cannot realistically be retained as living trees in context of the current land use for longer than 10 years.

Category 'A' - Trees of high quality with an estimated remaining life expectancy of at least 40 years.

Category 'B' - Trees of moderate quality with an estimated remaining life expectancy of at least 20 years.

Category 'C' - Trees of low quality with an estimated remaining life expectancy of at least 10 years, or young trees with a stem diameter below 150mm.

Root Protection Area

In order to avoid damage to the roots or rooting environment of retained trees, the Root Protection Areas (RPAs) should be plotted around each of the category A, B and C trees. This is a minimum area of 15m radius.

The RPA is calculated using the British Standard BS 5837:2012 'Trees in relation to design, demolition and construction - Recommendations'.

The RPA is calculated using the British Standard BS 5837:2012 'Trees in relation to design, demolition and construction - Recommendations'. The RPA is calculated using the British Standard BS 5837:2012 'Trees in relation to design, demolition and construction - Recommendations'. The RPA is calculated using the British Standard BS 5837:2012 'Trees in relation to design, demolition and construction - Recommendations'.

Arboricultural Impacts

Impacts	Nos. of trees
Trees to be removed	0
Groups to be removed	0
Trees with proposed incursions into RPAs	0
Groups with proposed incursions into RPAs	0
Trees that will require pruning	0
Groups that will require pruning	0

No. of Trees to be Removed

U	A	B	C
0	0	0	0

Tree Survey Schedule

Please refer to Arbttech Consulting Ltd. Tree Schedule for full details on all surveyed trees.

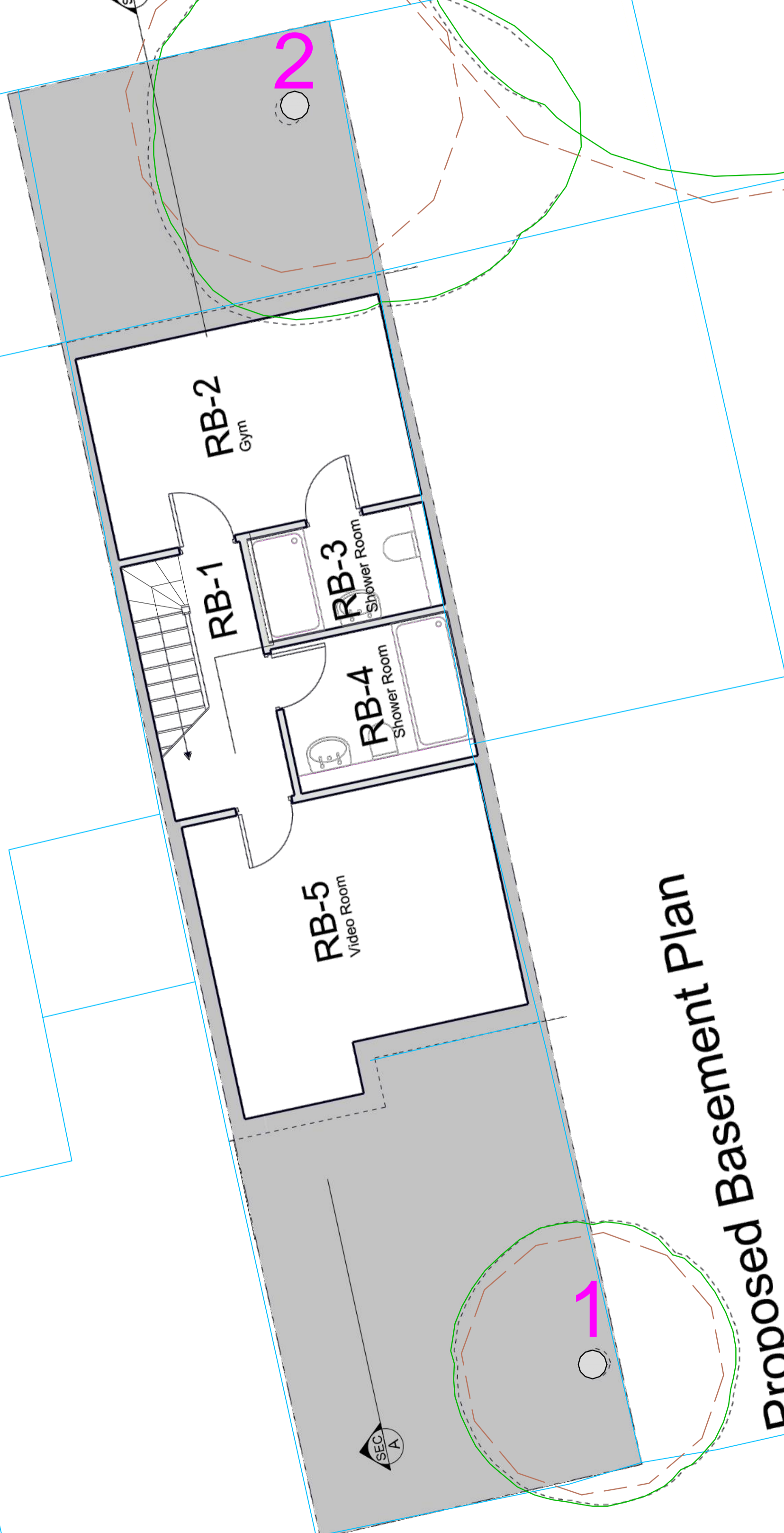
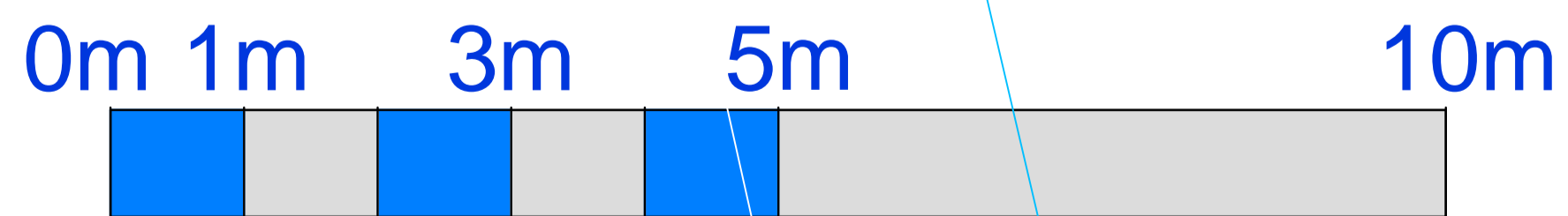

Project:
14 Powlett Place,
Camden,
London,
NW1 8DR

Client:
Mr Ed Gladwin

Drawing:
Arboricultural Impact Assessment

Based on:
77 P3 00 Proposed Basement

Drawing No: Arbttech AIA 01 **Rev:**

Date: August 2014 **Scale:** 1:50 @ A1 **Drawn:** AST

Key:

Tree Nos.:	1	Tree Canopies:		Trunks:	
RPAs:		Category 'B' trees:		Category 'C' trees:	
Incursions:					

All dimensions should be checked on site. No dimensions are to be scaled from this drawing. Please verify all dimensions on site. Arbttech Consulting Ltd. cannot be held responsible for inaccuracies in this drawing in which this plan is based. This drawing is designed to reflect the principles of the layout or design only, and relates only to the protection of retained trees. This drawing is not to be read as a definitive part of the engineering or construction design or method statement. An architect or structural engineer should be consulted over any matters of construction, detailing or specification and for any standards or regulatory requirements relating to proposed structures, load-bearing or underground services. This drawing was produced in colour - a monochrome copy should not be relied upon.

Arbttech Consulting Ltd, 2014